

FOX RUN REGIONAL PARK POND AND GAZEBO RENOVATION

EL PASO COUNTY, COLORADO

100% CONSTRUCTION DOCUMENTS

MAY 2025

SHEET TITLE	SHEET DESCRIPTION	SHEET NUMBER
TS01	TITLE SHEET	1

GENERAL NOTES	2
EXISTING CONDITIONS & DEMOLITION PLAN	3
OVERALL SITE PLAN	4
HORIZONTAL CONTROL PLAN - SPRUCE LAKE (NORTH)	5
HORIZONTAL CONTROL PLAN - ASPEN LAKE (SOUTH)	6
SITE & GRADING PLAN - SPRUCE LAKE (NORTH)	7
GRADING & SECTIONS - SPRUCE LAKE (NORTH)	8
SITE & GRADING PLAN - ASPEN LAKE (SOUTH)	9
GRADING & SECTIONS - ASPEN LAKE (SOUTH)	10
UTILITY PLAN	11
SITE DETAILS - GAZEBO	12
SITE DETAILS	13
SITE DETAILS	14
DETAILS	15
DETAILS	16
LANDSCAPE NOTES	17
LANDSCAPE PLAN - ASPEN LAKE	18
LANDSCAPE PLAN - SPRUCE LAKE	19
OVERALL IRRIGATION PLAN	20
IRRIGATION PLAN	21
IRRIGATION PLAN	22
IRRIGATION DETAILS	23
IRRIGATION DETAILS	24
IRRIGATION PUMP STATION IMPROVEMENTS	25
WATER FEATURE PLAN & DETAILS	26
WATER FEATURE PLAN & DETAILS	27
ELECTRICAL LEGEND	28
ELECTRICAL ONE-LINE DIAGRAM	29
ELECTRICAL DEMO PLAN	30
ELECTRICAL PLAN	31
LIGHT FIXTURE CUT SHEETS	32
LIGHT FIXTURE CUT SHEETS	33

OWNER/DEVELOPER: EL PASO COUNTY, COLORADO
EL PASO COUNTY COMMUNITY SERVICES DEPARTMENT
2002 CREEK CROSSING STREET
DENVER, COLORADO 80202
BRIAN BOESCH (719) 534-1547

CIVIL ENGINEER: MATRIX DESIGN GROUP
2455 RESEARCH PARKWAY, SUITE 300
COLORADO SPRINGS, COLORADO 80920
CORYN PETERSEN (719) 515-0100

LANDSCAPE ARCHITECT: MATRIX DESIGN GROUP
2455 RESEARCH PARKWAY, SUITE 300
COLORADO SPRINGS, COLORADO 80920
ANDREA HAMBERSKI (719) 515-0100

IRRIGATION ENGINEER: HINES INC
3221 W. DRAKE RD., SUITE 204
FORT COLLINS, COLORADO 80506
NATHAN HINES (970) 226-1100

GEOTECHNICAL ENGINEER: RMG ENGINEERS
5000 W. 10TH AVE., SUITE 200
COLORADO SPRINGS, COLORADO 80919
CHAVEZ, TIFFANY & ASSOCIATES ENGINEERING CORPORATION, AIA LICENSE
COLORADO SPRINGS, COLORADO 80903
JOSH AVERS, (719) 535-0021

ELECTRIC: MONUMENT FIRE DISTRICT
18055 OLD FOREST POINT, STE. 102
DENVER, COLORADO 80232
(719) 484-8911

FIRE DEPARTMENT: MONUMENT FIRE DISTRICT
18055 OLD FOREST POINT, STE. 102
DENVER, COLORADO 80232
(719) 484-8911

REFERENCE	DRAWINGS	NO.	DATE	BY
COMPUTER FILE MANAGEMENT	FILE NAME: 3/24/23_208 Fox Run Regional Park Pond Gazebo Renovation.dwg FILE DATE: May 9, 2025 2:52:48 PM FILE PATH: C:\Users\matt\OneDrive\Documents\3/24/23_208 Fox Run Regional Park Pond Gazebo Renovation.dwg	NO.	DATE	BY
COMPUTER FILE MANAGEMENT	FILE NAME: 3/24/23_208 Fox Run Regional Park Pond Gazebo Renovation.dwg FILE DATE: May 9, 2025 2:52:48 PM FILE PATH: C:\Users\matt\OneDrive\Documents\3/24/23_208 Fox Run Regional Park Pond Gazebo Renovation.dwg	NO.	DATE	BY



SITE MAP:
1" = 80'



VICINITY MAP:
1" = 1.5 MI

THE LOCATION OF EXISTING ABOVE GROUND AND UNDERGROUND UTILITIES ARE SHOWN IN AN APPROXIMATE MANNER ONLY. THE CONTRACTOR SHALL DETERMINE THE EXACT LOCATION OF ALL UTILITIES PRIOR TO CONSTRUCTION. THE CONTRACTOR SHALL BE FULLY RESPONSIBLE FOR ANY AND ALL DAMAGES WHICH MAY BE CAUSED BY HIS FAILURE TO EXACTLY LOCATE AND MARK ALL ABOVE GROUND AND UNDERGROUND UTILITIES.



DESIGN ENGINEER'S STATEMENT:

THESE DETAILED PLANS AND SPECIFICATIONS WERE PREPARED UNDER MY DIRECTION AND SUPERVISION, AND I AM A duly Licensed Professional Engineer in the State of Colorado. I HAVE PERSONALLY REVIEWED THE PLANS AND SPECIFICATIONS AND I AM AWARE OF THE CONTENTS AND I AM NOT PROVIDING ANY INFORMATION THAT I AM NOT QUALIFIED TO PROVIDE. I HAVE REVIEWED THE PLANS AND SPECIFICATIONS AND I AM NOT PROVIDING ANY INFORMATION THAT I AM NOT QUALIFIED TO PROVIDE. I HAVE REVIEWED THE PLANS AND SPECIFICATIONS AND I AM NOT PROVIDING ANY INFORMATION THAT I AM NOT QUALIFIED TO PROVIDE.

BY: _____ DATE: _____
CORYN PETERSEN, PE #65571
FOR AND ON BEHALF OF MATRIX DESIGN GROUP, INC.
05/12/2025

EL PASO COUNTY:

COUNTY PLANNING & DEVELOPMENT DEPARTMENT
100% CONSTRUCTION DOCUMENTS
FOX RUN REGIONAL PARK POND AND GAZEBO RENOVATION
EL PASO COUNTY, COLORADO
MAY 2025

JOSHUA WALKER, P.E.
COUNTY ENGINEER
DATE: 5/22/25

THE PLANNING AND DESIGN ENGINEER HAS REVIEWED THE PLANS AND SPECIFICATIONS AND I AM NOT PROVIDING ANY INFORMATION THAT I AM NOT QUALIFIED TO PROVIDE. I HAVE REVIEWED THE PLANS AND SPECIFICATIONS AND I AM NOT PROVIDING ANY INFORMATION THAT I AM NOT QUALIFIED TO PROVIDE. I HAVE REVIEWED THE PLANS AND SPECIFICATIONS AND I AM NOT PROVIDING ANY INFORMATION THAT I AM NOT QUALIFIED TO PROVIDE.

SEAL	FOX RUN REGIONAL PARK POND AND GAZEBO RENOVATION EL PASO COUNTY, COLORADO 100% CONSTRUCTION DOCUMENTS
TITLE SHEET	100% CONSTRUCTION DOCUMENTS
DESIGNED BY: HNO	CHECKED BY: CM
DRAWN BY: HNO	DATE ISSUED: MAY 2025
SCALE: 1" = 80'	DATE: MAY 2025
PROJECT NO: 24-237-008	PROJECT NO: 24-237-008
PROJECT NO: 24-237-008	PROJECT NO: 24-237-008

1. ALL WORK SHALL BE DONE IN ACCORDANCE WITH THE EL PASO COUNTY ENGINEERING

1. ALL WORK SHALL BE DONE IN ACCORDANCE WITH THE EL PASO COUNTY ENGINEERING CRITERIA MANUAL, REVISED 10-14-2020 AND CDD STANDARD SPECIFICATIONS, LATEST EDITION.
2. IT SHALL BE THE CONTRACTOR'S RESPONSIBILITY TO ENSURE THAT ALL WORK IS PERFORMED IN ACCORDANCE WITH APPLICABLE STANDARDS AND REGULATIONS AS SET FORTH BY THE OCCUPATIONAL SAFETY AND HEALTH ADMINISTRATION (O.S.H.A.).
3. NO FIELD CHANGES SHALL BE MADE WITHOUT PRIOR WRITTEN APPROVAL OF THE FIELD

4. SUBMITTALS SHALL BE MADE FOR ALL MATERIALS TO BE INCORPORATED INTO THE PROJECT.
5. UTILITY LINES AS SHOWN ON THE PLAN SHEETS ARE NOT ROTATED FROM THE BEST AVAILABLE INFORMATION. CONTRACTOR SHALL BE RESPONSIBLE FOR THE IDENTIFICATION, VERIFICATION AND PROTECTION OF ALL UTILITIES IN PLACE.
6. THE CONTRACTOR SHALL CONTACT THE UTILITY NOTIFICATION CENTER OF CO. ORANGE, AT 409-922-1872 TWO BUSINESS DAYS IN ADVANCE OF ANY EXCAVATION OR GRADING.
7. THE CONTRACTOR SHALL PROTECT AND MAINTAIN ALL UTILITY AND STRUCTURES AFFECTED BY THE WORK AND ANY DAMAGE SHALL BE REPAIRED AND RESTORED TO THE SATISFACTION OF THE RESPECTIVE UTILITY OWNER. THE CONTRACTOR IS RESPONSIBLE FOR THE PROTECTION OF ALL UTILITIES AND STRUCTURES. THE CONTRACTOR SHALL COOPERATE WITH UTILITY RELOCATIONS AS NECESSARY. THE COUNTY ENGINEERING INSPECTORS, UTILITY DEPARTMENTS AND UTILITY OWNERS SHALL BE NOTIFIED A MINIMUM OF 48 HOURS PRIOR TO COMMENCING WORK WHEREAS THE WORK IS TO BE INTERRUPTED AND/OR DEFERRED.
8. THE CONTRACTOR SHALL BE RESPONSIBLE FOR CONSTRUCTION SETTING, UNDERGROUNDING, TELEPHONE, FIBER AND CABLE TELEVISION FACILITIES MAY BE LOCATED IN CLOSE PROXIMITY TO THE WORK. THE CONTRACTOR MAY, IF NECESSARY, TEMPORARILY DISPLACE THE CABLES DURING CONSTRUCTION AND REINSTALL THEM IN ADEQUATELY PROTECTED LOCATION. THE CONTRACTOR SHALL BE RESPONSIBLE FOR THE PROTECTION OF ALL CABLES AND TELEVISION FACILITIES. THE CONTRACTOR SHALL COORDINATE WITH BOTH THE TELEPHONE AND CABLE TELEVISION COMPANY IN ORDER TO BE DONE BY THE CONTRACTOR.

10. THE PHYSICAL FEATURES WITHIN THE LIMITS OF THE PROJECT HAVE BEEN SHOWN BASED ON THE BEST AVAILABLE INFORMATION AT THE TIME OF DESIGN. THE ENGINEER ASSUMES NO RESPONSIBILITY FOR THE ACCURACY OF THE FEATURES SHOWN. THE CONTRACTOR SHALL REVIEW AND VERIFY EXISTING PHYSICAL FEATURES AND CONDITIONS, INCLUDING UTILITIES, AND SHALL BE RESPONSIBLE FOR THE PROTECTION OF EXISTING UTILITIES OR THE CONDITIONS TO BE ENCOUNTERED DURING THE CONSTRUCTION.
 11. THE CONTRACTOR SHALL LIMIT ALL WORK AND STORAGE AREAS TO THE PUBLIC HIGHWAYS AND ADJACENT USE OF ANY PRIVATE AREAS FOR THIS PROJECT PRIOR TO THE BEGINNING OF CONSTRUCTION. THE CONTRACTOR SHALL BE RESPONSIBLE FOR THE PROTECTION OF ALL AREAS. A COPY OF THIS APPROVAL PROVIDED TO THE FIELD ENGINEER PRIOR TO OBTAIN.
 12. ALL CONSTRUCTION IS TO INCLUDE COMPACTION AND FINISH GRADING IN THE LIMIT PRICE BIDDING WORK ITEM.
 13. ALL WORK SHALL BE DONE TO THE BEST GRADES, SPECIFICATIONS, AND ELEVATIONS SHOWN ON THE PLANS UNLESS OTHERWISE NOTED, APPROVED, AND FIELD ENGINEER.
 14. ALL MATERIALS AND WORKMANSHIP SHALL BE SUBJECT TO INSPECTION AND APPROVAL BY A BASIS COUNTY AND THE FIELD ENGINEER.
 15. THE FIELD ENGINEER SHALL BE NOTIFIED WITHIN 48 HOURS PRIOR TO THE COMMENCEMENT OF ANY CONSTRUCTION.
16. DIMENSIONS AND PAUL ARE SHOWN TO THE EDGE OF SIDEWALK UNLESS OTHERWISE NOTED.

17. THE LIMITS OF DISTURBANCE AROUND TOES OF SLOPE AS SHOWN ON THE PLANS, AND THE DISTANCE BETWEEN THESE LIMITS SHALL BE RESTORED TO ORIGINAL CONDITIONS BY THE CONTRACTOR AT HIS OWN EXPENSE.
18. THE CONTRACTOR SHALL MAINTAIN ACCESS FOR HEAVY CONSTRUCTION EQUIPMENT THROUGHOUT THE PROJECT.
19. WATER SHALL BE USED AS A FINE FILLING WHEN REQUIRED. LOCATIONS SHALL BE AS ORDERED. THE COST OF WATER SHALL BE INDENTURED TO OTHER BID ITEMS.
20. THE PHYSICAL FEATURES INCLUDING REMOVAL OR OBLITERATION WITH THE PROJECT SHALL BECOME THE PROPERTY OF THE CONTRACTOR AND BE DISPOSED OF OFF-SITE.
21. THE CONTRACTOR SHALL BE RESPONSIBLE FOR PRESERVING ANY ADJACENT PAVED AREAS, POINTS, TIE, BENCHMARKS, AND/OR SURVEY CONTROL POINTS WHICH MAY BE DAMAGED AND REPLACED WITH APPROVED MATERIAL BY A REGISTERED PROFESSIONAL LAND SURVEYOR AUTHORIZED TO REPLACE AND SURVEY IN THE STATE OF CALIFORNIA.
22. THE CONTRACTOR SHALL HAVE A COPY OF ALL APPLICABLE STANDARDS AND PLANS ON SITE FOR THE DURATION OF THE PROJECT.
23. THE CONTRACTOR SHALL NOT STOCKPILE MATERIAL WITHIN 10 FEET OF THE EDGE OF TRAVELED WAY.
24. THE CONTRACTOR SHALL FURNISH AND MAINTAIN TEMPORARY TRAFFIC CONTROL DEVICES NECESSARY THROUGHOUT THE DURATION OF CONSTRUCTION. THE CONTRACTOR SHALL CONTROL TRAFFIC ENGINEERING PORTY-SIGHT (4) HOUS IN ADVANCE FOR ANY REQUIRED MODIFICATION OF TRAFFIC SIGNALS WITHIN THE PROJECT AREA.
25. ANY DISCREPANCY WITHIN THESE PLANS SHALL BE RESOLVED TO THE IMMEDIATE ATTENTION OF THE ENGINEER AND WORK SHALL STOP UNTIL THE DISCREPANCY IS DISCUSSED AND DISCREPANCIES/AGREEMENTS HAVE BEEN MADE.

26. THE CONTRACTOR SHALL PROTECT IN PLACE ALL EXISTING FACILITIES AND INFRASTRUCTURE OUTSIDE OF PROPOSED LIMITS OF DISTURBANCE. IF DAMAGED CONTRACTOR SHALL REPLACE EXISTING FACILITIES AND/OR INFRASTRUCTURE INCLUDING BUT NOT LIMITED TO, TRAILS, RAILROAD TIES, AND ASSOCIATED EXISTING INFRASTRUCTURE, TO ITS ORIGINAL STATE.

2. ANY MATERIAL NOT SUITABLE FOR ADOPTED SHALL BE REMOVED FROM THE SITE AND DISPOSED OF BY AND AT THE EXPENSE OF THE CONTRACTOR.
3. CONSTRUCTION SHALL BE ACCORDING TO THE PRESCRIPTIONS AND RECOMMENDATIONS OF THE SUPERVISOR.
4. A MINIMUM 12" DEPTH OF OBSERVATION SHALL BE MAINTAINED DIRECTLY THE POND LINER AND REPEATED WITH 1/2" OF CLEAN SOIL BENEATH THE POND LINER. SOIL SHALL BE CLEANED OF ANY ROCKS, ANIMALS MATERIAL, GREATER THAN 1/2" IN DIAMETER AND OTHER DEBRIS. THE POND LINER SHALL BE PLACED ON A MINIMUM 1/2" OF MANUFACTURER'S IMPROVED SURFACE PRESENTED ON PLANS REPRESENTS TOP OF SOIL PLACED OVER LINER.
5. A MINIMUM 12" DEPTH OF CLEAN SOIL SHALL BE PLACED OVER TOP OF THE POND LINER WITH A MINIMUM 1/2" OF CLEAN SOIL BENEATH THE POND LINER. SOIL SHALL BE CLEANED OF ANY ROCKS, ANIMALS MATERIAL, GREATER THAN 1/2" IN DIAMETER AND OTHER DEBRIS. THE POND LINER SHALL BE PLACED ON A MINIMUM 1/2" OF MANUFACTURER'S IMPROVED SURFACE PRESENTED ON PLANS REPRESENTS TOP OF SOIL PLACED OVER LINER.
6. EXPERTS SHALL BE HEAVILY UTILIZED FOR CONSTRUCTION EQUIPMENT LOGISTICS, FOR EARTHWORK, HAULING, GRADING, ETC., WILL BE RESULT, OR RESUBMIT TO BE NEEDED ABOUT 1000 FOR A CONSISTENT FINISHED LOOK.

7 THE CONTRACTOR SHALL BE RESPONSIBLE FOR CONSTRUCTION STAKING OF BOTH

8. PRIOR TO PROJECT COMPLETION, THE CONTRACTOR SHALL BE RESPONSIBLE FOR THE REPLACEMENT OF ANY PROPERTY MONUMENTATION DISTURBED OR REMOVED BY CONSTRUCTION OPERATIONS. THIS WORK SHALL BE PERFORMED BY A LAND SURVEYOR LICENSED IN THE STATE OF COLORADO. PROPERTY CORNERS WHICH FALL WITHIN NEW CONCRETE FLOWMAY SHALL BE DURABLE AND SET FLUSH. THIS SHALL BE CONSIDERED INCIDENTAL TO THE PROJECT.

- [illegible]

6. **CONCLUSIONS** Overall, a strong case is made that the use of a single, well-defined, and well-validated instrument can provide a more accurate and reliable measure of the construct of organizational commitment than a collection of multiple, less well-defined, and less well-validated instruments.

- [illegible]

HYDROLOGIC

SOLL ID NO.	SOLL TYPE	CLASSIFICATION
41	KETTLE GRAVELLY LOAMY SAND (8% - 40% SLOPES)	B
71	PINGING COARSE SANDY LOAM (3% - 8% SLOPES)	B

SPRUCE LAKE (NORTH) 7337.4

DATA	POSITION	TIME
1	1	1
2	2	2
3	3	3
4	4	4
5	5	5
6	6	6
7	7	7
8	8	8
9	9	9
10	10	10
11	11	11
12	12	12
13	13	13
14	14	14
15	15	15
16	16	16
17	17	17
18	18	18
19	19	19
20	20	20
21	21	21
22	22	22
23	23	23
24	24	24
25	25	25
26	26	26
27	27	27
28	28	28
29	29	29
30	30	30
31	31	31
32	32	32
33	33	33
34	34	34
35	35	35
36	36	36
37	37	37
38	38	38
39	39	39
40	40	40
41	41	41
42	42	42
43	43	43
44	44	44
45	45	45
46	46	46
47	47	47
48	48	48
49	49	49
50	50	50
51	51	51
52	52	52
53	53	53
54	54	54
55	55	55
56	56	56
57	57	57
58	58	58
59	59	59
60	60	60
61	61	61
62	62	62
63	63	63
64	64	64
65	65	65
66	66	66
67	67	67
68	68	68
69	69	69
70	70	70
71	71	71
72	72	72
73	73	73
74	74	74
75	75	75
76	76	76
77	77	77
78	78	78
79	79	79
80	80	80
81	81	81
82	82	82
83	83	83
84	84	84
85	85	85
86	86	86
87	87	87
88	88	88
89	89	89
90	90	90
91	91	91
92	92	92
93	93	93
94	94	94
95	95	95
96	96	96
97	97	97
98	98	98
99	99	99
100	100	100

[illegible]











THE SURVEY WAS PERFORMED UTILIZING GROUND COORDINATES WITHIN THE COLORADO

THE SURVEY WAS PERFORMED UTILIZING GROUND COORDINATES WITHIN THE COLORADO CENTRAL ZONE NAD83/2011 STATE PLANE. THE SURVEY WAS SCALED FROM 0.0 WITH A GRID GROUND CONVERSION FACTOR OF 1.0004120180.

3

- Call before you dig.**
- Know what's below.**
- PROPOSED UNDERGROUND UTILITY
- E-SD _____
- P-W8 _____
- EXISTING PAVED ROAD
- PROPOSED CENTERLINE

-

- | EXISTING CONTOUR | PROPOSED CONTOUR | LIMITS OF CONSTRUCTION | PROPOSED MANHOLE | EXISTING LIGHT POLE | EXISTING WATER VALVE | PROPOSED WATER VALVE | WATER FITTINGS | PROPOSED SIGN | EXISTING SIGN |
|---|---|---|---|---|---|---|---|---|---|
|  |  |  |  |  |  |  |  |  |  |

[illegible]

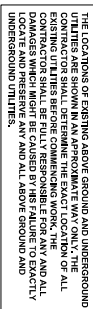

Know what's below.
Call before you dig.

- [illegible]

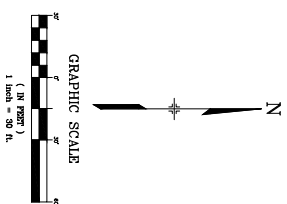

PREPARED BY:
Matrix
Excellence by Design

[illegible]

THE LOCATIONS OF EXISTING ABOVE GROUND AND UNDERGROUND UTILITIES ARE SHOWN IN AN APPROXIMATE WAY ONLY. THE CONTRACTOR SHALL BE FULLY RESPONSIBLE FOR ANY AND ALL EXISTING UTILITIES BEFORE COMMENCING WORK. THE CONTRACTOR SHALL BE RESPONSIBLE FOR ANY AND ALL LOCATE AND PRESERVE ANY AND ALL ABOVE GROUND AND UNDERGROUND UTILITIES.



- GENERAL NOTES:
1. REFERENCE LANDSCAPING SHEETS FOR LANDSCAPING AND MATERIAL.
 2. REFERENCE HORIZONTAL CONTROL PLAN FOR LOCATION OF UNBROKEN DITCHES FOR WALL DETAILS.
 3. SEE DETAIL SHEET D102 FOR AREA DRAIN DETAIL.
 4. SEE DETAIL SHEET D102 FOR AREA DRAIN DETAIL.

LEGEND

- EX SANITARY SEWER MANHOLE
- EX LIGHTPOLE
- EX SIGN
- EX ELECTRICAL BOX
- EX UNDERGROUND ELECTRICAL BOX
- EX WATER LINE
- EX UNDERGROUND ELECTRIC
- EX WATER SURFACE ELEVATION
- PR CONCRETE SIDEWALK
- PR CRUSHED LIMESTONE PATH
- LIMITS OF DISTURBANCE
- EXISTING CONTOUR
- PROPOSED CONTOUR
- EXISTING SLOPE ARROW
- PROPOSED SLOPE ARROW
- ADA PATH

LIMITS OF DISTURBANCE = 35.76350 FT. (0.82 ACRES)
(POND REHABILITATION IS NOT INCLUDED WITHIN LIMITS OF DISTURBANCE)

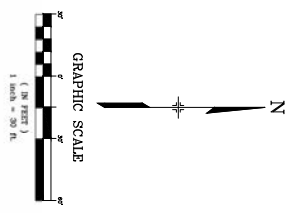
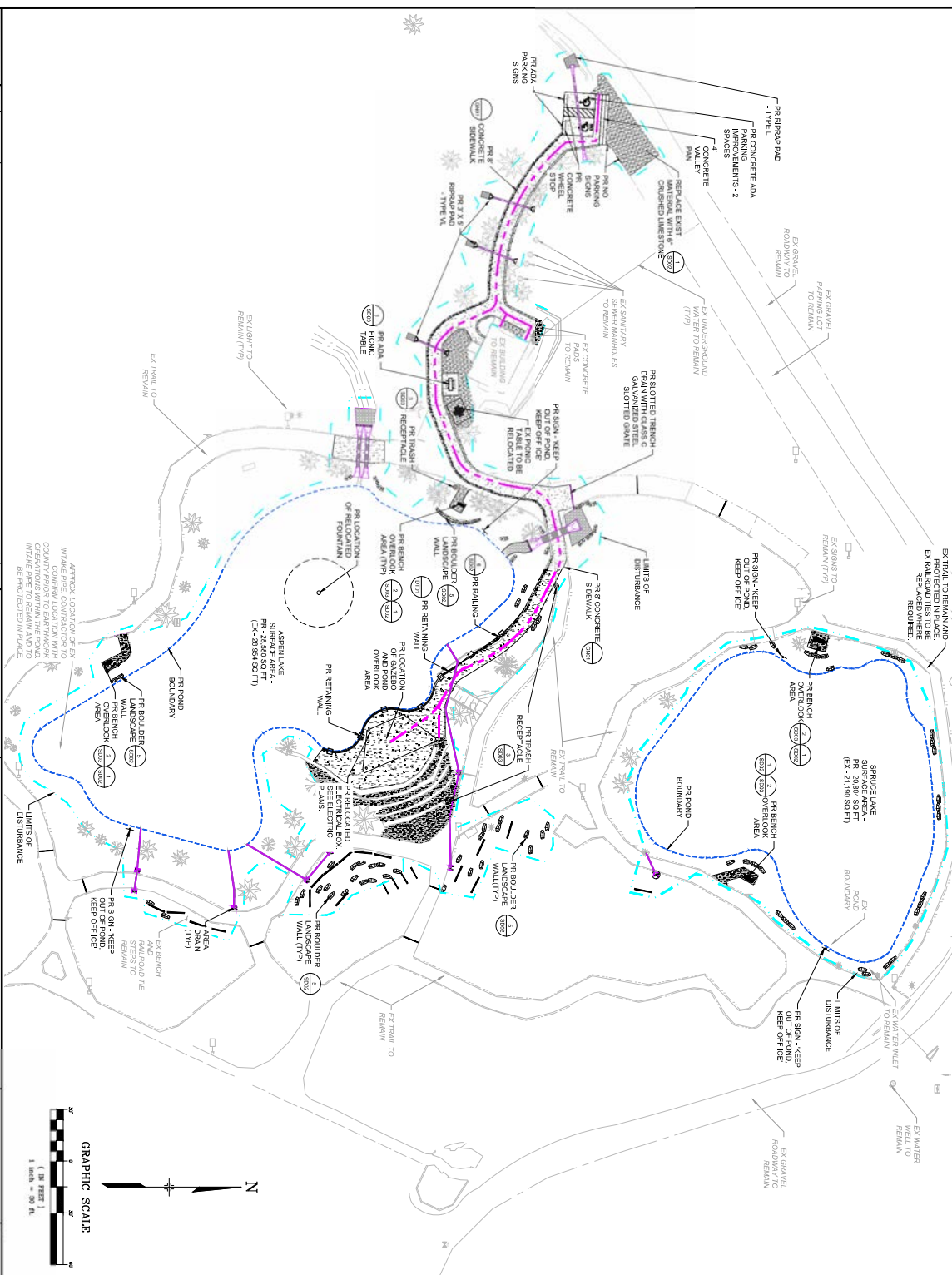

ASPEN LAKE - EX PUMP HOUSE

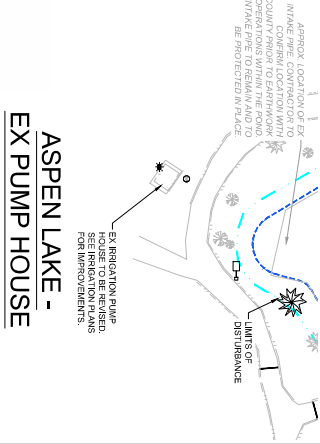

REFERENCE

NO. DATE

REVISIONS

BY

COMPUTER FILE MANAGEMENT

FILE NAME: 3/24/23_206 EX AN REGIONAL PARK02 CAD0054.dwg

FILE DATE: 3/24/23 2:53:27 PM

FILE LOCATION: C:\PROJECTS\3/24/23_206 EX AN REGIONAL PARK02 CAD0054.dwg

SHEET NO.

SHEET NAME

VERTICAL DATUM

HORIZONTAL DATUM

FOUR RUN REGIONAL PARK POND AND GAZEBO RENOVATION

EL PASO COUNTY COLORADO

100% CONSTRUCTION DOCUMENTS

OVERALL SITE PLAN

DESIGNED BY: JCM

DATE ISSUED: MAY 2023

PROJECT NO.: 24-227-008

CLIENT: EL PASO COUNTY

SCALE: 1" = 30'

DATE: 5/1/23

BY: JCM

PROJECT NO.: 24-227-008

CLIENT: EL PASO COUNTY

SCALE: 1" = 30'

DATE: 5/1/23

BY: JCM

Matrix

Excellence by Design



LEGEND

- NOTES:

GRAPHIC SCALE



PREPARED BY:
Matrix
Excellence by Design

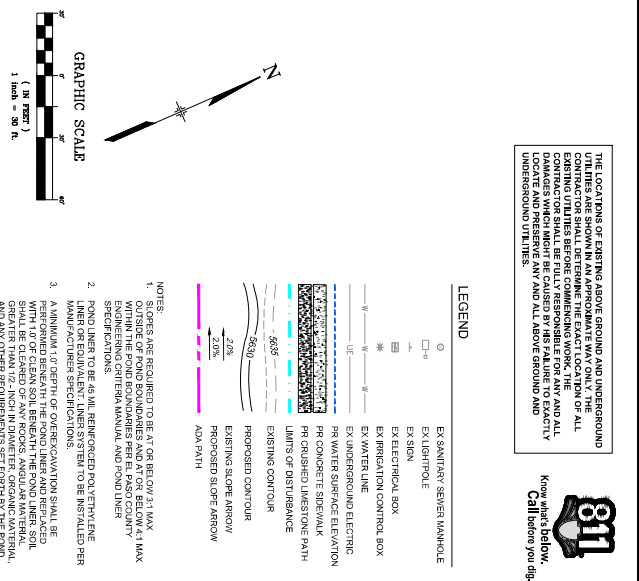

FOX RUN REGIONAL PARK POND AND GAZEBO RENOVATION	
EL PASO COUNTY, COLORADO	
100% CONSTRUCTION DOCUMENTS	
SITE & GRADING PLAN - SPRUCE LAKE	
(NORTH)	
DESIGNED BY: RMC	SCALE:
DRAWN BY: RNO	PROJECT: 17-000
CHECKED BY: CWP	DATE ISSUED: MAY 2021
ISSUED BY: CWP	SHEET: 8 OF 33
	STANDARD NO. DG02

[illegible]



GAZEBO

Model Name: LW-BS-A-HEX46-06

Dimensions: 46' wide x 21'-11" deep

Eave Height: 9'-0"

Total Approx. Area: 780 sq. ft.

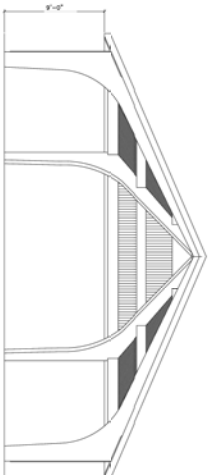
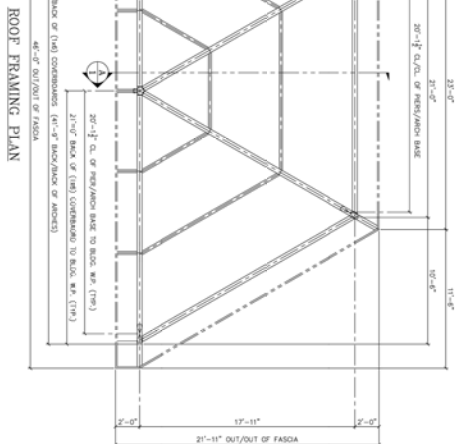
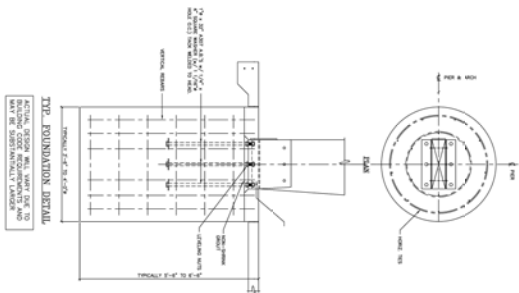
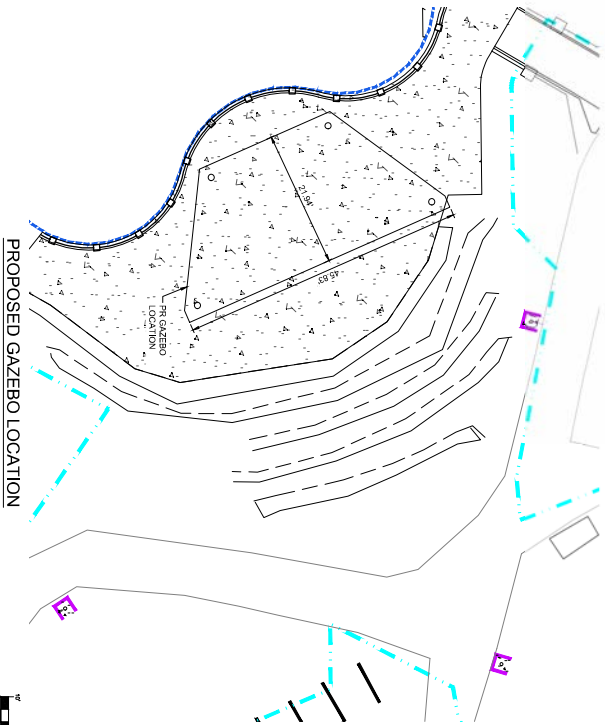

NOTE:
PROPOSED GAZEBO TO BE BOP-SHEDS, INC. MODEL LW-BS-A-HEX46-06 OR EQUIVALENT. CONTRACTOR TO COORDINATE WITH EL PASO COUNTY ON FINAL GAZEBO WHEN APPROVED. MATERIAL, COLOR, AND FINISH TO BE DETERMINED BY CONTRACTOR TO COORDINATE WITH COUNTY ON DETAILS IF ALTERNATE IS SELECTED.
ALTERNATIVE BOP-SHEDS, INC. MODEL LW-BS-A-HEX46-06 OR EQUIVALENT. CONTRACTOR TO COORDINATE WITH COUNTY ON DETAILS IF ALTERNATE IS SELECTED.

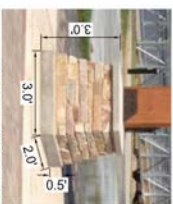

MATCH GRADE AND MATERIAL OF GAZEBO TO MATCH EXISTING GAZEBO. CONTRACTOR TO COORDINATE WITH COUNTY ON DETAILS IF ALTERNATE IS SELECTED.

REFERENCE		SHEET A-01	
DATE	DESCRIPTION	VERTICAL DATUM FROM BIRDA A-01, MOUNTAIN POND, IN HAVAS DAM, LOCATED APPROXIMATELY 75 FEET EAST OF THE LOCATION OF THE GAZEBO. THE DATUM IS A BENCHMARK FOR THE GAZEBO. THE DATUM IS A BENCHMARK FOR THE GAZEBO. THE DATUM IS A BENCHMARK FOR THE GAZEBO.	
NO.	DATE		
COMPUTER FILE MANAGEMENT		HORIZONTAL DATUM THE SURVEY WAS PERFORMED USING STATION COORDINATES WITHIN THE COORDINATE SYSTEM OF THE GAZEBO. THE SURVEY WAS PERFORMED USING STATION COORDINATES WITHIN THE COORDINATE SYSTEM OF THE GAZEBO. THE SURVEY WAS PERFORMED USING STATION COORDINATES WITHIN THE COORDINATE SYSTEM OF THE GAZEBO.	
FILE NAME	3/24/2018 10:44 AM regional park pond and gazebo renovation plans.sdw and		
FILE DATE	May 9, 2023 2:35:14 PM		
PROJECT INFORMATION		SITE DETAILS - GAZEBO	
PROJECT NO. 24-271-008			
DESIGNED BY: M. J. JONES		DATE ISSUED: MAY 2023	
CHECKED BY: M. J. JONES			
APPROVED BY: M. J. JONES		DRAWING NO. SD01	
DATE: 12/20/23			

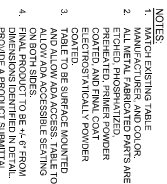

- NOTES:**
1. MATCH EXISTING TABLE MANUFACTURER AND COLOR.
 2. ALL METAL, FABRICATED PARTS ARE PRE-PAINTED. PRIMER POWDER COATED, AND FINAL COAT ELECTROSTATICALLY POWDER COATED.
 3. TABLE TO BE SURFACE MOUNTED TO ADA ACCESS TABLE TO ALLOW ADA ACCESSIBLE SEATING ON BOTH SIDES.
 4. FINAL PRODUCT TO BE 4'-6" FROM DIMENSIONS IDENTIFIED IN DETAIL TO OWNER AND/OR OWNERS REPRESENTATIVE FOR APPROVAL PRIOR TO INSTALLATION.



1. MATCH EXISTING BENCH MANUFACTURER, COLOR, SIZE, AND BACK STYLE.
2. ALL METAL FABRICATED PARTS ARE ETCHED, PHOSPHATED, PREHEATED, PRIMER POWDER COATED, AND FINAL COAT ELECTROSTATICALLY POWDER COATED.
3. BENCH TO BE SURFACE MOUNTED.
4. FINAL PRODUCT TO BE 6'-6" FROM DIMENSIONS IDENTIFIED IN DETAIL. PROVIDE A PRODUCT SUBMITTAL TO OWNER AND/OR OWNER'S REPRESENTATIVE FOR APPROVAL PRIOR TO INSTALLATION.

MS-PR-FOX-05

MS-PR-FOX-0

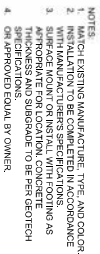

MS-PR-FOX-14

[illegible]

THE CONTRACTOR SHALL PERFORM WORK IN ACCORDANCE WITH THE LATEST CDOT STANDARD SPECIFICATIONS FOR ROAD AND BRIDGE CONSTRUCTION, SECTION 601 (STRUCTURAL CONCRETE) EXCEPT AS OTHERWISE MODIFIED.

ELEVATIONS SHOWN ON CONCRETE ARE TO THE TOP OF THE MEMBER, UNLESS OTHERWISE NOTED AND ARE SUBJECT TO FINAL FIELD ADJUSTMENT BY THE INCHPEN PRIOR TO CONSTRUCTION.

THE CONTRACTOR SHALL BE RESPONSIBLE FOR CONSTRUCTION MEANS, METHODS, TECHNIQUES, SEQUENCES AND PROCEDURES AS RELATED TO SHORING AND PROTECTION OF NEW AND EXISTING STRUCTURES AS NECESSARY TO PREVENT DAMAGE OR COLLAPSE DUE TO WIND, EARTH, CONSTRUCTION OR OTHER LOADS.

THE CONTRACTOR IS RESPONSIBLE TO CHECK AND VERIFY ALL GRADES AND ALIGNMENTS TO ASSURE CONFORMANCE TO THE CONSTRUCTION DRAWINGS. THE CONTRACTOR SHALL INFORM THE PROJECT MANAGER IMMEDIATELY OF ANY DISCREPANCIES OR VARIATIONS.

THE CONTRACTOR SHALL NOTIFY THE PROJECT INSPECTOR A MINIMUM OF 24 HOURS PRIOR TO POURING CONCRETE FOR STRUCTURES. IT SHALL BE THE RESPONSIBILITY OF THE CONTRACTOR TO KEEP ALL LOCATIONS AND ELEVATIONS OF ALL EXISTING UTILITIES PRIOR TO ANY CONSTRUCTION. EXISTING UTILITY LOCATION AND ELEVATIONS SHOWN ON PLANS ARE APPROXIMATE ONLY. THE CONTRACTOR SHALL CAREFULLY STUDY THE CONTRACT DOCUMENTS AND SHALL IMMEDIATELY REPORT IN WRITING TO THE PROJECT INSPECTOR ANY ERROR, CONFLICT, INCONSISTENCY, OR OMISSION THAT MAY BE ENCOUNTERED AND SHALL OBTAIN SPECIFIC WRITTEN INSTRUCTIONS FROM THE DESIGN ENGINEER BEFORE PROCEEDING WITH THE WORK.

THE CONTRACTOR SHALL NOTIFY THE CONTRACT MANAGER IMMEDIATELY OF ANY FIELD CONDITIONS NOT CONSISTENT WITH THE CONTRACT DOCUMENTS AND/OR THE CONTRACT DOCUMENTS.

THE CONTRACTOR SHALL BE RESPONSIBLE FOR DETERMINING A PROPER CONSTRUCTION SEQUENCE SUCH THAT THE COMPLETED WORK WILL NOT BE DAMAGED BY SUBSEQUENT WORK.

THE CONTRACTOR SHALL BE RESPONSIBLE FOR CONTROL OF WATER DURING CONSTRUCTION INCLUDING POTENTIAL HIGH STORM WATER AND SHALL PROTECT SUCH WORK AS WELL AS COMPLETED WORK FROM THOSE FLOWS.

- ALL CONCRETE, UNLESS OTHERWISE NOTED (CONCRETE CLASS D),..... $f_c = 4,300$ PSI
- REINFORCING STEEL (ASTM A-615):
ALL REINFORCING SHALL BE EPOXY COATED
#4 AND LARGER (GRADE 60),..... $f_y = 60,000$ PSI

PLACE CONCRETE IN FORMING SLABS AGAINST UNDESIGNED SUITABLE FOUNDATION MATERIAL OR STABILIZED SUBGRADE MATERIAL AS DIRECTED BY THE GEOTECHNICAL ENGINEER. NO CONSTRUCTION DEVIATING WILL BE ALLOWED FROM WITHIN THE FACING ORG. AL CONSTRUCTION DEVIATING WILL BE ACCOMPLISHED IN A MANNER THAT DOES NOT DISTURB THE STRUCTURE FOUNDATION FOR ALL STUDIES IN RECONSTRUCTION SHALL BE DETAILLED ON THE DRAWINGS OR AS APPROVED BY THE DESIGN ENGINEER IF SPACE AND/OR TIME PERMITTING. ALL REPAIRS TO EXISTING CONCRETE SHALL BE DONE TO MATCH THE ORIGINAL FINISHES AND CURING PROCEDURES. ALL REINFORCING SHALL BE WELDED TO THICK WEIRDING OF REINFORCEMENT WILL BE ALLOWED.

CONCRETE CORNERS, STEPS, REINFORCING BARS SHALL BE AS FOLLOWS, UNLESS OTHERWISE NOTED:

CONCRET PLACED AGAINST LAKE OR RIVER SHALL BE PROTECTED BY AN IMPERVIOUS COVERING TO PREVENT EROSION OF CONCRETE EXPOSED TO EARTH OR WEATHER. 2

ALL BARS IN CONCRETE WALLS SHALL BE CONTINUOUS AROUND CORNERS, OR CORNER BARS OF EQUAL SIZE AND SPACING SHALL BE PROVIDED. SPLICES IN ADJACENT TOP AND BOTTOM BARS IN FOUNDATION WALLS SHALL BE STAGGERED 4'-0" MINIMUM WHERE POSSIBLE.

ASCE/SEI 7-16: MINIMUM DESIGN LOADS AND ASSOCIATED CRITERIA FOR BUILDINGS AND OTHER STRUCTURES

INTERNATIONAL BUILDING CODE 2021 (IBC 2021)

ASSUMED LOADING AND GEOTECHNICAL PROPERTIES:

*ALL ASSUMED LOADING AND GEOTECHNICAL PROPERTIES LISTED BELOW SHALL BE CONFIRMED BY CONTRACTOR. ENGINEER SHALL BE NOTIFIED OF ANY DEVIATIONS FROM THE LISTED DESIGN VALUES

- ACTIVE DRAINED EARTH PRESSURE (COOT CLASS 1 STRUCTURE BACKILL): $E_{FUND} = 40 \text{ PSF}$
- SOIL UNIT WEIGHT: $\gamma = 125 \text{ PCF}$
- PASSIVE EARTH PRESSURE = 250 PCF
- ALLOWABLE BEARING PRESSURE = $1,500 \text{ PSF}$
- COEF OF SLIDING FRICTION = 0.35
- PEDESTRIAN SURCHARGE = 1 FT
- NO CAZERO SURCHARGE LOADING IS APPLIED

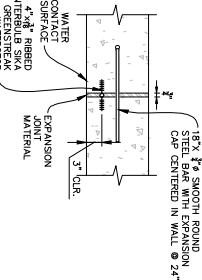

EXPANSION JOINT

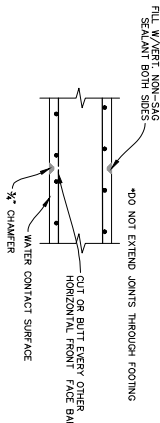

CONTRACTION JOINT

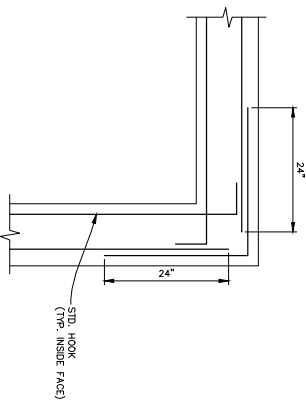

CORNER DETAIL
SCALE: 1" = 1'-0"



CIP FORMLINER WALL SAMPLE

SCALE: N.T.S.

1. WALL EXPANSION JOINTS TO MATCH FLATWORK EXPANSION JOINTS WITH A MAXIMUM SPACING OF 24 FT.
2. WALL CONTRACTION JOINTS TO MATCH FLATWORK SAW-CUT JOINTS WITH A MAXIMUM SPACING OF 8 FT.

1. BASE BID

- 1.1. CONTRACTOR TO PROVIDE BASE BID WITH FLAT FINISH AND STANDARD CONCRETE FOR WALL.

2. BID ALTERNATE

- 2.1. CONTRACTOR TO PROVIDE BID ALTERNATE UTILIZING INTEGRATED COLOR CONCRETE IN DAVIS CANYON 160 OR APPROVED EQUAL.

- 2.2. CONTRACTOR TO PROVIDE BID ALTERNATE FOR FORMLINER FINISH APPLIED ON EXPOSED WALL FACE TO 6 INCHES BELOW FINISHED GRADE. SEE SAMPLE FORMLINER IMAGE BELOW. WALL THICKNESS SHALL BE INCREASED BY FORMLINER RELIEF DIMENSION AND MAINTAIN A MINIMUM SECTION OF 10".
- 2.3. FORMLINER TO BE SUBMITTED TO OWNER AND ENGINEER FOR APPROVAL.

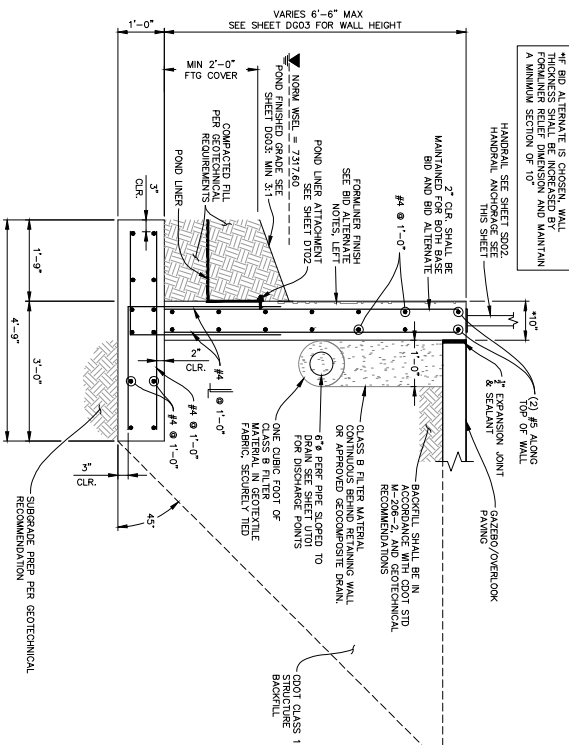

TYPICAL WALL SECTION

SCALE: $\frac{3}{4}" = 1'-0"$

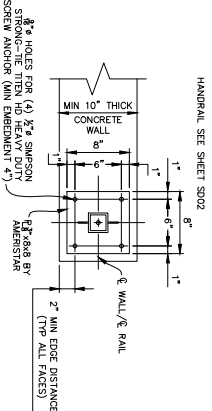

HANDRAIL WALL ANCHORAGE

[illegible]

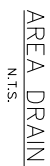
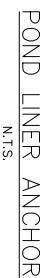
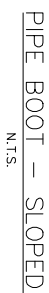
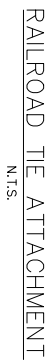

FOX RUN REGIONAL PARK POND AND GAZEBO RENOVATION					
<p align="center">EL PASO COUNTY, COLORADO 100% CONSTRUCTION DOCUMENTS</p>					
<p align="center">DETAILS</p>					
DESIGNED BY	RMD	SCALE			
DRAWN BY	PHOTO				
CHECKED BY	GAJ	DATE ISSUED			
	VEGET	NO. SHEET			
		19 OF 31			
					SHADING: 50%
					D102

SEEDING NOTES

1. PRIOR TO BEGINNING ANY WORK ON THE SITE, THE CONTRACTOR SHALL CONTACT THE OFFICE OF THE OWNERS REPRESENTATIVE FOR A PERSONAL MEETING TO DISCUSS THE DRAWINGS, NOTATIONS, ETC. AND SPECIFICATIONS FOR THIS PROJECT.
2. THE CONTRACTOR SHALL BE RESPONSIBLE FOR OBTAINING ALL NECESSARY PERMITS AND APPROVALS FOR THIS PROJECT.
3. LANDSCAPE NOTES AND LANDSCAPE DETAILS ARE PROVIDED PARTLY FOR THE ENTIRE SCOPE OF WORK SHOWN ON LANDSCAPE ARCHITECTURE DRAWINGS AND PARTLY FOR THE CONSTRUCTION OF THE PROJECT.
4. LANDSCAPE CONTRACTOR SHALL PROVIDE ALL LAWN, MATERIALS AND SERVICES NECESSARY TO FURNISH AND INSTALL LANDSCAPE ELEMENTS AND PLANTINGS AS SPECIFIED HEREIN AND AS SHOWN ON THEIR PLANS.
5. REPORT ANY DISCREPANCIES TO THE LANDSCAPE PLAN IMMEDIATELY TO THE OWNER OWNERS REPRESENTATIVE.
6. NO MATERIAL SUBSTITUTIONS SHALL BE MADE WITHOUT LANDSCAPE ARCHITECTS APPROVAL. ALTERNATE MATERIALS OR PLANT SPECIFICATIONS SHALL BE SUBMITTED TO THE LANDSCAPE ARCHITECT FOR REVIEW AND APPROVAL. UNAPPROVED SUBSTITUTIONS RESERVE THE RIGHT TO REJECT PLANT TO BE USED IF NECESSARY.
7. ALL PLANT LOCATIONS ARE APPROXIMATE. ADJUST AS NECESSARY TO AVOID CONFLICTS.
8. QUANTITIES OF MATERIALS SHOWN ON PLANT SCHEDULE ARE THE PRECEDENCE OVER QUANTITIES SHOWN ON THE LANDSCAPE ARCHITECTURE DRAWINGS. THE CONTRACTOR SHALL BE RESPONSIBLE FOR ORDERING ALL QUANTITIES TO MEET SPECIFICATIONS.
9. CONTRACTOR SHALL LOCATE ALL UTILITIES BEFORE WORK. UTILITIES HAVE BEEN SHOWN ON PLANS FOR REFERENCE ONLY. CONTRACTOR SHALL BE RESPONSIBLE FOR THE DEPTH OF ANY DAMAGE CAUSED TO UTILITIES. (TOLL FREE 800-426-9979)
10. REMOVE ALL RUBBER EQUIPMENT AND MATERIAL AND WASH THE WHEELS IN A SEPARATE CLEAN CONTAINER EACH DAY. UNDESIRABLE CONDITION AT ALL TIMES.
11. STORAGE OF ANY MATERIALS, SUPPLIES, UTILITIES OR EQUIPMENT, FENCING AND WARNING SIGNS SHALL BE MAINTAINED THROUGHOUT THE SITE WORKS. EXCESSIVE STORAGE OF MATERIALS SHALL BE PROHIBITED.
12. PROVIDE ADEQUATE PROTECTION FOR ALL EXISTING UTILITIES AND ALL EXISTING PLANTING.
13. PROVIDE CLEAR DRIVE CLEARANCE SHALL BE MAINTAINED ON ALL PAVED DRIVEWAYS.
14. ALL TOP OF SOIL.

8. FINE GRADE S

1. ALL TILTING OF PLANTING BEDS AND PLACEMENT OF MATERIAL IS TO OCCUR JUS PRIORS TO PLANTING. THEREAFTER PROTECTION FROM COMPACTON AND CONSTRUCTION TRAFFIC SHOULD BE PROVIDED.
2. ALL TREES AND SHRUBS LOCATIONS ARE APPROXIMATE. ANALYST AS NECESSARY TO MAKE CONTACTS, OBTAIN OWNER OR LANDSCAPE ARCHITECT'S APPROVAL, AND VERIFY EXISTING PLANTING LOCATIONS.
3. ALL PLANT MATERIAL SHALL BE WELL-PROPORTED AND DEVELOPED TO GOOD CONDITION. HEALTHY AND MATURE TREES ARE TYPICAL OF THE SPECIES. PLANTS SHALL COME IN 15" SPACED 2" DBS PER 100' SQUARE FOOTAGE. THE NURSERY SET FORTH IN THE COLOMBIA PURCHASE LIST TO 1985 - 1976, IS APPLICABLE. DBS PER 100' SQUARE FOOTAGE. THE NURSERY SET FORTH IN THE COLOMBIA PURCHASE LIST TO 1985 - 1976, IS APPLICABLE. DBS PER 100' SQUARE FOOTAGE.
4. OWNER AND OWNER'S REPRESENTATIVE RESERVES THE RIGHT TO SELECT AT ANY TIME OF PLACEMENT TO FINAL ACCEPTANCE OF WORK, ANY AND ALL PLANTS WHICH, IN THEIR OPINION, FAIL TO MEET THE REQUIREMENTS OF THE SPECIFICATIONS.
5. THE CONTRACTOR SHALL BE RESPONSIBLE FOR OBTAINING ALL PLANTS THAT ARE SPECIFIED IN THE OWNER AND OWNER'S REPRESENTATIVE CONTRACTORS SHALL REPLACE IMMEDIATELY ANY PLANT NOT IN HEALTHY CONDITION DURING THE WARRANTY PERIOD SHALL BE ENDED TO RETURN TO THE ORIGINAL SPECIFICATIONS, AND TO CHANGED TO THE OWNER'S DISCRETION.
6. ALL PLANTS SHALL BE EXPOSED TO THE ELEMENTS. PROLONGED WET DROPPED PLANTS AS NOTED IN THE SPECIFICATIONS, SHALL BE INSTALLED WITHIN THE DETAILS.
7. ALL PLANT MATERIAL SHALL HAVE DEVELOPED A COMPLETELY PLACED AROUND BASE AND STUBS OF BALL, TO TWO THIRDS AND COARSE RHYTHM AROUND BASE OF TRUNK SHALL BE REMOVED AT THIS TIME. REMAINDER OF FOLIAGE SHALL BE BROADCASTED ALLOWING FOR DEPTH OF MULCH, SANDER AND SETTLEMENT OF BACKFILL. BACKFILL SHALL THEN BE THOROUGHLY WATERED AS NOTED IN THE DETAILS.
8. ALL PLANTS SHALL BE PLACED IN THE FOLLOWING ORDER: TREES, THEN SHRUBS, AND ALL DEAD WOOD ON TREES AND SHRUBS ONE YEAR AFTER PLANTING. ACCEPTANCE.
9. ALL TREES ON TREES TO REMAIN, INCLUDING STUMPED TREES AND TRUNKING SHALL BE PERFORMED BY A TREE SERVICE

JUNCUS BALTI

1. EXISTING TREES TO BE EVALUATED FOR HEALTH, PRUNING AND IMPACT TO HISTORIC VIEW CORRIDORS
2. PLANT MATERIAL TO BE REMOVED IF THE SPECIES IS UNDESIRABLE IE. NOXIOUS WOOD OR AN INVASIVE SHRUB OR TREE
3. ALL VEGETATION DESIGNATED TO REMAIN SHALL BE FENCED OFF DURING CONSTRUCTION TO MINIMIZE DISTURBANCE IN THESE AREAS. ALL FENCING IS TO BE INSTALLED PRIOR TO GRADING ON THE PROPERTY. A 4" ORANGE CONSTRUCTION SAFETY FENCE SHALL BE USED IN THIS APPLICATION.
4. ALL EXISTING TREES DESIGNATED TO REMAIN WILL NEED TO BE REPLACED IF NOT IN A HEALTHY CONDITION.

SCIENTIFIC NAME	COMMON NAME	WETLAND STATUS	PERCENT MIX	SIZE	SPACING	QUANTITY
LARGE BOWENIA	NEBRASKA SEED	OBL.	20	12"	25'	550
AMERICAN BALSAM	BALD IRISH	OBL.	20	10-12"	12'	550
PANICUM VIRGATUM	SWITCHGRASS	FAC	30	2"	134	34
SPARGANGLIA SCOPARIA	LITTLE BLUESTEM	FACU	10	10-12"	10'	79
SPOONWORT	OBL.	OBL.	20	10-12"	15'	155
SPORNOLECTUS INERMAMENTUM	SOFT-STEM BURNISH	OBL.	100	12"	103	103
TOTAL						

[illegible][illegible]

SEEDING NOTES

- [illegible]





















UPLAND SEED MIX:

SPECIFIC NAME	VARIETY	COMMON NAME	P.A. LB/AC	% BY WEIGHT	P.A. S/ST	% P.A. S/ST
AMORPHOCEAN GEMMIFOLIA	VNS	BIG BLUESTEM	150	7	5	4
CLAMMOPHYS CHAMBERSII	VNS	BLUJOINT	0-20	1	15	1
CAREX NERARIENSIS	VNS	NEBRASKA SEDGE	110	4	13	9
CRISPEROSUS CESTRIFOLIA	VNS	UPPER HEMLOCK	0-27	1	3	6
CYPERUS CRISTATUS	VNS	FLAT TOP	100	5	11	11
ELANUS TRACHOCALUS	SAN. LBS	SLENDER WET GRASS	150	13	12	8
GAIXERA STRELLA	VNS	POW. MANNING'S	150	7	8	5
JUNCUS ALUTOSUS	VNS	BALD PINE	0-20	1	14	10
SCHIZOPHYLLA SCOPULIFOLIA	VNS	LITTLE BLUESTEM	1-70	6	9	7
SCHIZOPHYLLUS	VNS	SOFT BLUESTEM	0-60	3	9	5
ZORNEA BREVIFOLIA	VNS	POW. BLUESTEM	100	2	10	6
POYONOCLOUS AMOENS	VNS	POW. BLUESTEM	100	2	10	6
POYONOCLOUS AMOENS	VNS	POW. BLUESTEM	100	2	10	6
GRAND TOTALS			12.14	46	118	82

ASCL.EPIAS SF

	WNS	WHOLEY NOT SPECIFIED
1	WNS	100
2	WNS	100
3	WNS	100
4	WNS	100
5	WNS	100
6	WNS	100
7	WNS	100
8	WNS	100
9	WNS	100
10	WNS	100
11	WNS	100
12	WNS	100
13	WNS	100
14	WNS	100
15	WNS	100
16	WNS	100
17	WNS	100
18	WNS	100
19	WNS	100
20	WNS	100
21	WNS	100
22	WNS	100
23	WNS	100
24	WNS	100
25	WNS	100
26	WNS	100
27	WNS	100
28	WNS	100
29	WNS	100
30	WNS	100
31	WNS	100
32	WNS	100
33	WNS	100
34	WNS	100
35	WNS	100
36	WNS	100
37	WNS	100
38	WNS	100
39	WNS	100
40	WNS	100
41	WNS	100
42	WNS	100
43	WNS	100
44	WNS	100
45	WNS	100
46	WNS	100
47	WNS	100
48	WNS	100
49	WNS	100
50	WNS	100
51	WNS	100
52	WNS	100
53	WNS	100
54	WNS	100
55	WNS	100
56	WNS	100
57	WNS	100
58	WNS	100
59	WNS	100
60	WNS	100
61	WNS	100
62	WNS	100
63	WNS	100
64	WNS	100
65	WNS	100
66	WNS	100
67	WNS	100
68	WNS	100
69	WNS	100
70	WNS	100
71	WNS	100
72	WNS	100
73	WNS	100
74	WNS	100
75	WNS	100
76	WNS	100
77	WNS	100
78	WNS	100
79	WNS	100
80	WNS	100
81	WNS	100
82	WNS	100
83	WNS	100
84	WNS	100
85	WNS	100
86	WNS	100
87	WNS	100
88	WNS	100
89	WNS	100
90	WNS	100
91	WNS	100
92	WNS	100
93	WNS	100
94	WNS	100
95	WNS	100
96	WNS	100
97	WNS	100
98	WNS	100
99	WNS	100
100	WNS	100

PLANT SCHEDULE - ENTIRE PROJECT

Symb.	CODE	QTY	BOTANICAL / COMMON NAME	PLANT SIZE	COUNTAINER	MAT. H.	MAT. W.
DECIDUOUS TREES							
	AA	3	AMELANCHIER ALNIFOLIA SASKATCHEWAN SERVICEBERRY	1.5' CAL.	8x8	20	12'
	CY	1	PRUNUS VERTICILLATA CHOCHOERRY	1.5' CAL.	8x8	20	12'
EVERGREEN TREES							
	AC	2	TAXUS CANADICOLOR WHITE FIR	4' HT	8x8	40	20'
	PE	3	PICEA ENCE MANNI ENGELMANN SPRUCE	4' HT	8x8	40	20'
DECIDUOUS SHRUBS							
	POF	6	POTENTILLA FRUTICOSA, RED ACE RED ACE BUSH CINCQUEFOIL	#5 CONT.	CONT.	3	4'
	RIC	11	RYDALSIA CORYMBOSA WAX CARRANT	#5 CONT.	CONT.	4	4'
	ROW	14	ROSA WOODBII MOUNTAIN ROSE	#5 CONT.	CONT.	6	6'
	SYO	8	SYDOWIA ALBA WESTERN SNOWBERRY	#5 CONT.	CONT.	5	5'
EVERGREEN SHRUBS							
	CEF	18	CEYLANISUS TENUILATER FERNLEAFS CANNOLIAS	#5 CONT.	CONT.	3	5'
ORNAMENTAL GRASSES							
	PAY	6	PANICUM VITIGRACIUM BANTON GRASS	#1 CONT.	CONT.	4	2'
PERENNIALS							
	ECH	9	ECHINACIA PURPUREA	#1 CONT.	CONT.	3	2'
	GMA	5	GALLIARDA ARISTATA BLANKEFLOWER	#1 CONT.	CONT.	2	1'
	IRM	35	IRIS MONACHENSIS, ROCKY WESTERN BLUEBIRDS	#1 CONT.	CONT.	2	3'
	LUM	6	LUPULUS ABERNETHIUS	#1 CONT.	CONT.	2	1.5'
<div>  NATIVE SEED - RIPARIAN TRANSITION SEED MIX </div> <div>  WETLAND / RIPARIAN STABILIZATION PLUGS </div> <div>  4.4 ROCK W/OUT FINISHING </div> <div>  3.4 ROCK TYPE 3.4" BRICKEN GOLD ROCK SUPPLIER </div> <div>  PRIMER SAND AND GRAVEL, DEPTH: 3" MIN OR APPROVED EQUIV. </div> <div>  BREEZE CRUSHED LIMESTONE GRANITE </div>							

Know what's below.
Call before you dig.



202

[illegible][illegible]PROXIMATELY 25
HAVING A

 Matrix Excellence by Design		PREPARED BY: FOW AND OUI ARCHT'G PC MATRIX DESIGN GROUP, INC. 10000 W. 10TH AVENUE DENVER, CO 80202	
REVIEWED BY: M. J. HENDERSON DATE: 03/23/01		PROJECT NO.: 1001	
SCALE: 1/4" = 1'-0"		SHEET NO.: 1001	
DATE REVISION: 03/23/01		PROJECT NO.: 1001	

LANDSCAPE NOTES

FOX RUN REGIONAL PARK
EL PASO COUNTY, COLORADO
100% CONSTRUCTION DOCUMENTS

**Know what's below.
Call before you dig.**

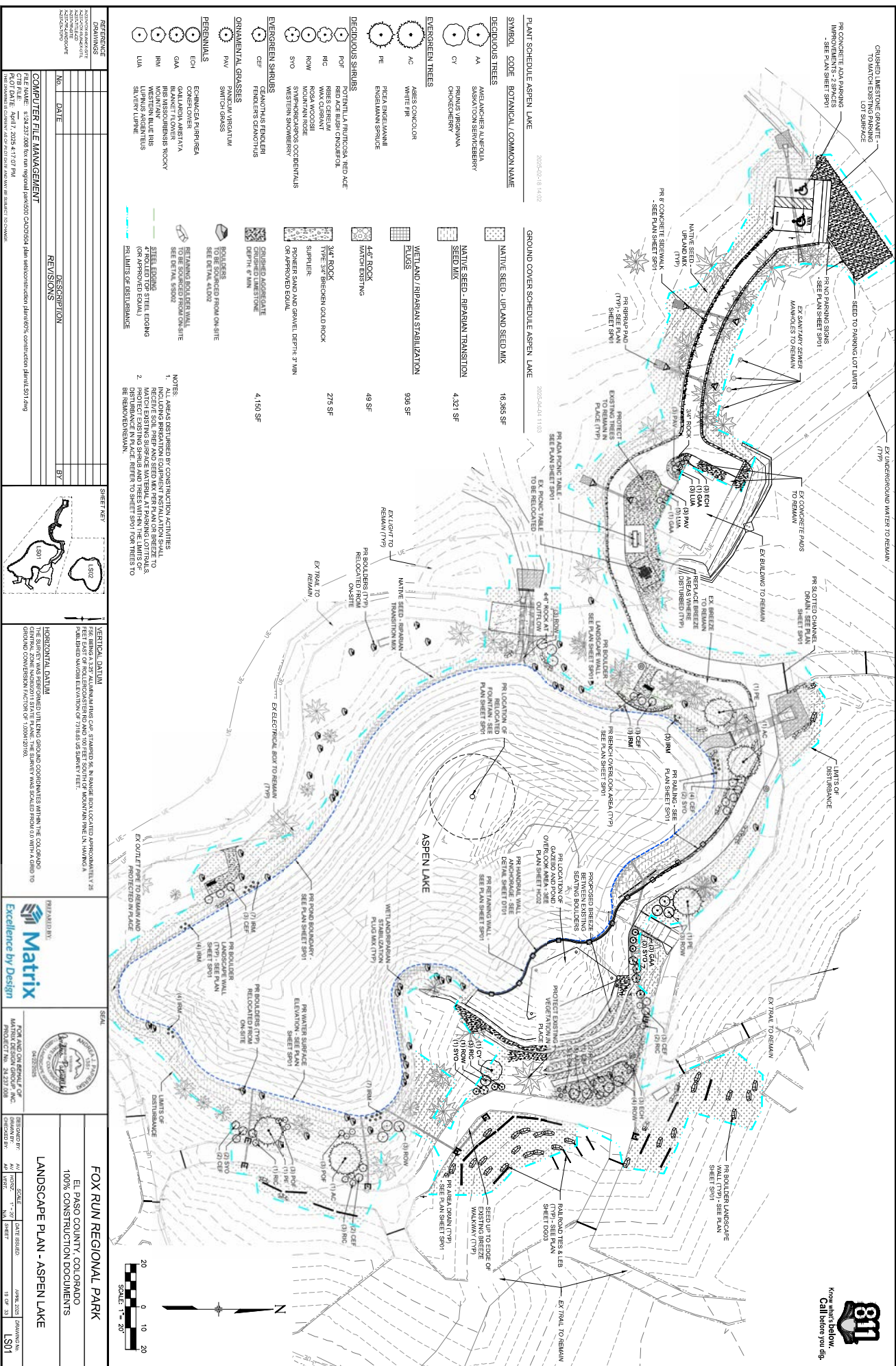

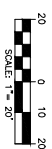
[illegible]

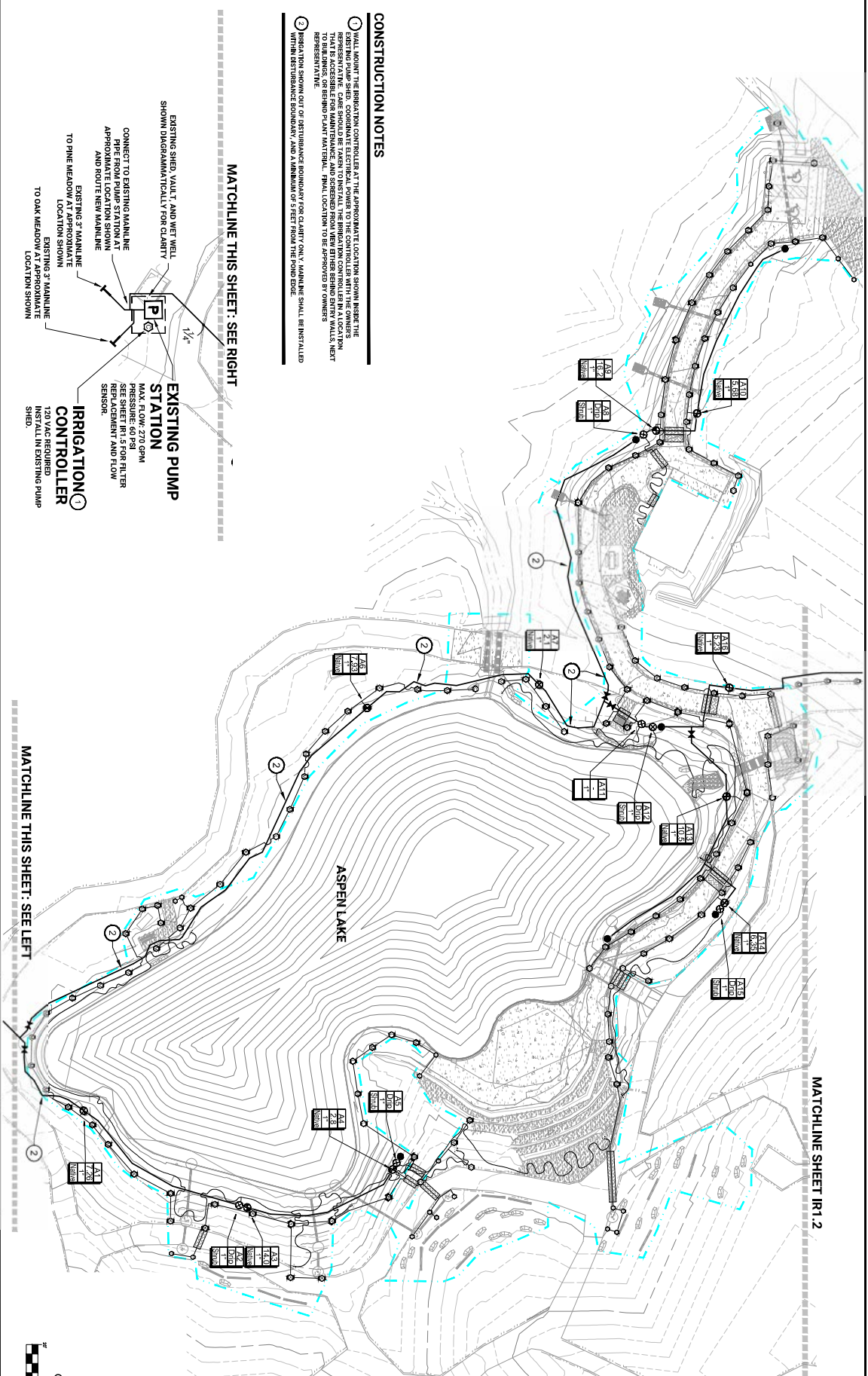

CONSTRUCTION NOTES

2. WALL, JOINT OR EMBEDED CONTROL CONTROLS AT THE APPROXIMATE LOCATION SHOWN INSIDE THE EXISTING PUMP CHED. COORDINATE ELECTRICAL POWER TO THE CONTROLLER WITH THE OWNER'S REPRESENTATIVE. CARE SHOULD BE TAKEN TO INSTALL THE REGULATION CONTROLLER IN A LOCATION THAT IS ACCESSIBLE FOR MAINTENANCE AND SCREENED FROM VIEW OTHER BEHIND ENTRY WALLS, NEXT TO THE EXISTING PUMP CHED AND IDEALLY, PUMP LOCATION TO BE APPROVED BY OWNERS REPRESENTATIVE.

MATCHLINE THIS SHEET: SEE RIGHT

EXISTING PUMP STATION

EXISTING SIZED VALVE, AND WET WELL SHOWN DISAPPROPRIATELY FOR CLARITY

CONNECT TO EXISTING MAINLINE PIPE FROM PUMP STATION AT APPROXIMATE LOCATION SHOWN AND ROUTE NEW MAINLINE

EXISTING 3" MAINLINE

TO PINE MEADOW AT APPROXIMATE LOCATION SHOWN

EXISTING 3" MAINLINE



TO OAK MEADOW AT APPROXIMATE LOCATION SHOWN



IRRIGATION CONTROLLER

120VAC REQUIRED
INSTALL IN EXISTING PUMP SHE.

MAX. FLOW: 270 GPM
PRESSURE: 60 PSIG
SEE SHEET R1 FOR FILTER
SENSOR
SHUT ARM AND LOW

MATCHLINE THIS SHEET: SEE LEFT

REFERENCE DRAWINGS		SHEET KEY		BENCHMARK N/A		1" = 40'	BASE OF BEARING N/A
NO.	DATE						
DESCRIPTION							
REVISIONS							
BY							
COMPUTER FILE MANAGEMENT							
FILE NAME							
CITY FILE							
FIRM ADDRESS		CANNON & SONS PAVED DRIVEWAY RE-PAVEMENT CHAIRMAN					

		SEAL 	FOX RUN REGIONAL PARK EL PASO COUNTY, COLORADO 100% CONSTRUCTION DOCUMENTS
IRRIGATION PLAN			
DESIGNED BY PROJECT NO. 24-277-009	SCALE 1" = 40'	DATE ISSUED JUNE 2025	DRAWING NO. IR-1
CHECKED BY			
BY			

IRRIGATION LEGEND

- [illegible]

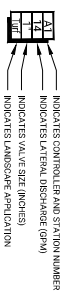

A IRRIGATION CONTROLLER UNIT
WITH WR2 RAIN/FREEZE SENSOR

RAIN BIRD ESP-ME3 CONVENTIONAL WIRED CONTROLLER

POP-UP ROTATING SPRAY SPRINKLER: RAIN BIRD RD1806-S-P45-NF
W/MP1000 NOZZLES
PRESSURE: 45 PSI RADIUS: 8 FEET TO 15 FEET
FLOW (GPM): M-0.44 L-0.67 O-0.88

 POP-UP ROTATING SPRAY SPRINKLER, RAIN BIRD RD1800-S-P45-NF
W/MP2000 NOZZLES
PRESSURE: 45 PSI RADIUS: 13 FEET TO 21 FEET
FLOW (GPM): Q-0.85 H-1.17 F-1.57

POP-UP ROTATING SPRAY SPRINKLER, RAIN BIRD RD1806-S-P45-NR
W/M/P 3000 NOZZLES
PRESSURE: 45 PSI RADIUS: 22 FEET TO 30 FEET
FLOW (GPM): Q-1.93 H-2.89 F-3.86

POP-UP ROTATING SPRAY SPRINKLER: RAIN BIRD RD1806-S-P45-NE
W/MP5500 NOZZLE
PRESSURE: 45 PSI RADIUS: 31 FEET TO 35 FEET
FLOW (GPM): 90"-1.38 180"-3.10 210"-3.54

POP-UP ROTATING SPRAY SPRINKLER RAIN BIRD RD1806-S-P45-4F
W/MPCORNER NOZZLE
PRESSURE: 45 PSI RADIUS: 17 FEET TO 24 FEET
FLOW (GPM): 45-0.21 90-0.41 105-0.48

CONSTRUCTION NOTES

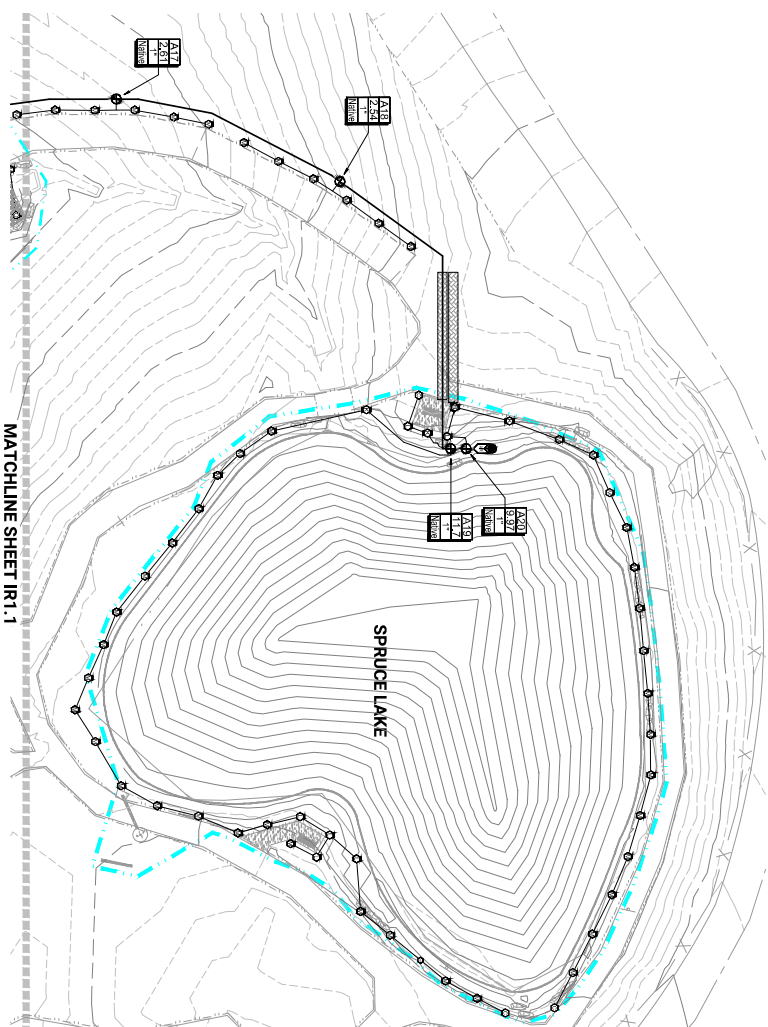

1. WALL MOUNT THE REGULATION CONTROLLER AT THE APPROXIMATE LOCATION SHOWN INSIDE THE EXISTING PUMP SHED. COORDINATE ELECTRICAL POWER TO THE CONTROLLER WITH THE OWNERS REPRESENTATIVE. CARE SHOULD BE TAKEN TO INSTALL THE REGULATION CONTROLLER IN A LOCATION THAT IS ACCESSIBLE FOR MAINTENANCE, AND SCREENED FROM VIEW OTHER BIDDING ENTRIES WALLS TO BUILD DRAIN OR BEHIND PLUMB MATERIAL. FINAL LOCATION TO BE APPROVED BY OWNERS REPRESENTATIVE.
2. REGULATION SHOWN OUT OF DISTURBANCE ZONE FOR CLAYT ONLY. MAINLINE SHALL BE INSTALLED WITH DISTURBANCE BOUNDARY, AND A MINIMUM OF FEET FROM THE POND EDGE.

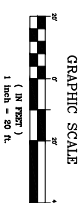
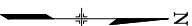

MATCHLINE SHEET IR1.1



100% C
Know what's below.
Call before you dig.

REFERENCE		SHEET NO.	BENCHMARK	
DYNAMICS				
9000 S. Orange Avenue Suite 200 Orange, CA 92667				
2-1217-2009-001 (sheet 10)				
No.		DATE	DESCRIPTION	BY
REVISIONS				
COMPUTER FILE MANAGEMENT:				
FILE NAME				
C:\B\FILE				
PROJECT: 12/15/2009				
PROJECT: 12/15/2009				
100% CONSTRUCTION DOCUMENTS				
BASIS OF BEARING		N/A		
				
DESIGNED BY: JH		FOX RUN REGIONAL PARK		
CHECKED BY: BJ		EL PASO COUNTY, COLORADO		
DATE: 12/15/2009		100% CONSTRUCTION DOCUMENTS		
SCALE: 1"=40'		IRRIGATION PLAN		
DRAWING NO.: 101-1				

1 WALL MOUNT
CONTROLLER ASSEMBLY

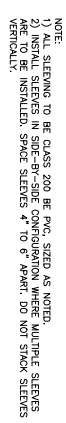
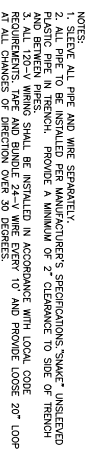

5 TYPICAL TRENCHING DETAIL

6 TYPICAL SLEEVING DETAIL

7 TYPICAL VALVE BOX INSTALLATION

[illegible]

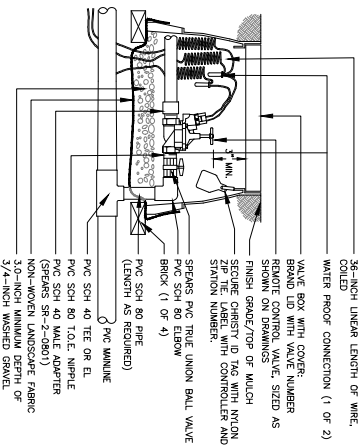

8 REMOTE CONTROL SPRINKLER VALVE ASSEMBLY

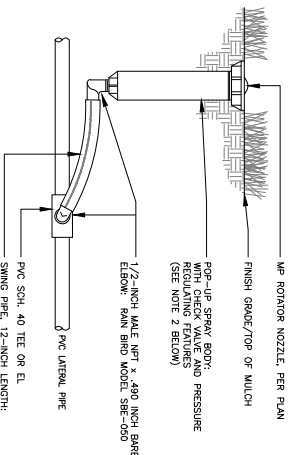

9 6-INCH POP UP
MP-ROTATOR ASSEMBLY

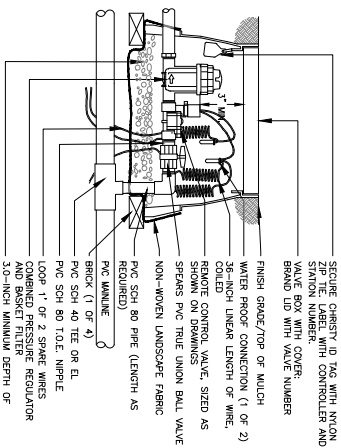

10 REMOTE CONTROL DRIP VALVE ASSEMBLY

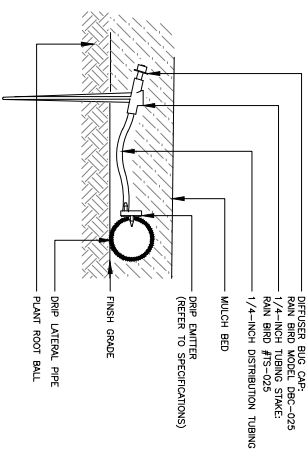

**11 SINGLE OUTLET DRIP
EMITTER ASSEMBLY**

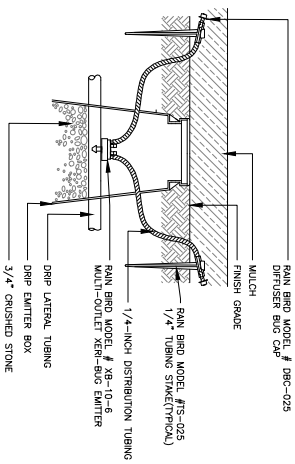

12 MULTI-OUTLET DRIP EMITTER
ASSEMBLY FOR TREES IN BEDS

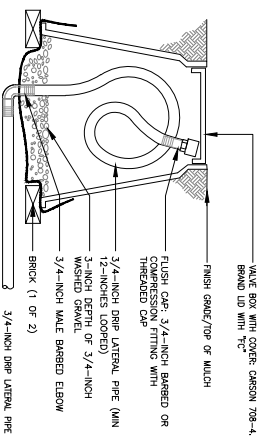

13 DRIP FLUSH CAP ASSEMBLY

PLANT TYPE	EMITTERS PER PLANT	GPH PER EMITTER	TOTAL GPH PER PLANT
TREES 2" CAL.	4 SINGLE	1 GPH	4 GPH
LARGE SHRUBS 5 GAL.	2 SINGLE	1 GPH	2 GPH
SMALL SHRUBS 1 GAL.	1 SINGLE	1 GPH	1 GPH
GC/PERENNIAL	1 SINGLE	1 GPH	1 GPH
CALCI	1 SINGLE	0.5 GPH	0.5 GPH

14 EMITTER SCHEDULE

[illegible]



Hines Inc.

PREPARED BY:

FOR AND ON BEHALF OF:
 PROJECT NO. 24-2077-008

SEAL

DESIGNED BY: 28

CHECKED BY: 29

DATE ISSUED: APRIL 2022

DATE: IR 1.5

EL PASO COUNTY, COLORADO

100% CONSTRUCTION DOCUMENTS

IRRIGATION PUMP STATION IMPROVEMENTS

FOX RUN REGIONAL PARK

[illegible][illegible]

1. REFERENCED DRAWING COMPLIES WITH DCA10.11.2.
2. REFERENCED PERFORMANCE TO COMPLY WITH DCA10.11.2.
3. CONTROL FOR ALL MECHANICAL SYSTEMS LOCATED OUTSIDE OF A BUILDING TO COMPLY WITH DCA10.13.
4. VOLTAGE DROP TO COMPLY WITH DCA10.14.
5. FOR ALL CONTROLLED RECEPTACLS PER DCA10.11 PROVIDE MARKING OF CONTROLLED RECEPTACLS IN COMPLIANCE WITH NEC 404.3E.
6. A FINAL COMMISSIONING REPORT SHALL BE DELIVERED TO THE BUILDING OWNER PER SECTION 0410.2 OF THE 2021 EEC.



811
Know what's below.
Call before you dig.



**Chavez Tiffany & Ayers
Engineering Corporation**
611 North Nevada Avenue
Cobleskill, NY 12528
P: (716) 634-0021

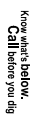

Chavez Tiffany & Ayers
Engineering Corporation
611 North Nevada Avenue
Colorado Springs, Colorado 80903
P (719) 636-0021

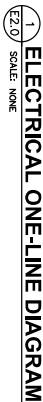
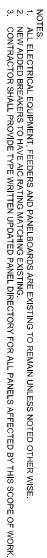

COMPUTER FILE MANAGEMENT										SHEET NAME									
FILE NAME: 2-Scalped Poplar-Pine Regional Park - Planned/Proposed Electric Run Regional Park Electric																			
CIR FILE: 2-Scalped Poplar-Pine Regional Park - Planned/Proposed Electric Run Regional Park Electric																			
CIR DATE: 2-20-2024 11:48 PM																			
PRINT SCALE: 1"=100'-0" (1:120) (1"=100'-0")																			
PRINT SCALE: 1"=100'-0" (1:120) (1"=100'-0")																			
PRINT SCALE: 1"=100'-0" (1:120) (1"=100'-0")																			
PRINT SCALE: 1"=100'-0" (1:120) (1"=100'-0")																			
PRINT SCALE: 1"=100'-0" (1:120) (1"=100'-0")																			
PRINT SCALE: 1"=100'-0" (1:120) (1"=100'-0")																			
PRINT SCALE: 1"=100'-0" (1:120) (1"=100'-0")																			
PRINT SCALE: 1"=100'-0" (1:120) (1"=100'-0")																			
PRINT SCALE: 1"=100'-0" (1:120) (1"=100'-0")																			
PRINT SCALE: 1"=100'-0" (1:120) (1"=100'-0")																			
PRINT SCALE: 1"=100'-0" (1:120) (1"=100'-0")																			
PRINT SCALE: 1"=100'-0" (1:120) (1"=100'-0")																			
PRINT SCALE: 1"=100'-0" (1:120) (1"=100'-0")																			
PRINT SCALE: 1"=100'-0" (1:120) (1"=100'-0")																			
PRINT SCALE: 1"=100'-0" (1:120) (1"=100'-0")																			
PRINT SCALE: 1"=100'-0" (1:120) (1"=100'-0")																			
PRINT SCALE: 1"=100'-0" (1:120) (1"=100'-0")																			
PRINT SCALE: 1"=100'-0" (1:120) (1"=100'-0")																			
PRINT SCALE: 1"=100'-0" (1:120) (1"=100'-0")																			
PRINT SCALE: 1"=100'-0" (1:120) (1"=100'-0")																			
PRINT SCALE: 1"=100'-0" (1:120) (1"=100'-0")																			
PRINT SCALE: 1"=100'-0" (1:120) (1"=100'-0")																			
PRINT SCALE: 1"=100'-0" (1:120) (1"=100'-0")																			
PRINT SCALE: 1"=100'-0" (1:120) (1"=100'-0")																			
PRINT SCALE: 1"=100'-0" (1:120) (1"=100'-0")																			
PRINT SCALE: 1"=100'-0" (1:120) (1"=100'-0")																			
PRINT SCALE: 1"=100'-0" (1:120) (1"=100'-0")																			
PRINT SCALE: 1"=100'-0" (1:120) (1"=100'-0")																			
PRINT SCALE: 1"=100'-0" (1:120) (1"=100'-0")																			
PRINT SCALE: 1"=100'-0" (1:120) (1"=100'-0")																			
PRINT SCALE: 1"=100'-0" (1:120) (1"=100'-0")																			
PRINT SCALE: 1"=100'-0" (1:120) (1"=100'-0")																			
PRINT SCALE: 1"=100'-0" (1:120) (1"=100'-0")																			
PRINT SCALE: 1"=100'-0" (1:120) (1"=100'-0")																			
PRINT SCALE: 1"=100'-0" (1:120) (1"=100'-0")																			
PRINT SCALE: 1"=100'-0" (1:120) (1"=100'-0")																			
PRINT SCALE: 1"=100'-0" (1:120) (1"=100'-0")																			
PRINT SCALE: 1"=100'-0" (1:120) (1"=100'-0")																			
PRINT SCALE: 1"=100'-0" (1:120) (1"=100'-0")																			
PRINT SCALE: 1"=100'-0" (1:120) (1"=100'-0")																			
PRINT SCALE: 1"=100'-0" (1:120) (1"=100'-0")																			
PRINT SCALE: 1"=100'-0" (1:120) (1"=100'-0")																			
PRINT SCALE: 1"=100'-0" (1:120) (1"=100'-0")																			
PRINT SCALE: 1"=100'-0" (1:120) (1"=100'-0")																			
PRINT SCALE: 1"=100'-0" (1:120) (1"=100'-0")																			
PRINT SCALE: 1"=100'-0" (1:120) (1"=100'-0")																			
PRINT SCALE: 1"=100'-0" (1:120) (1"=100'-0")																			
PRINT SCALE: 1"=100'-0" (1:120) (1"=100'-0")																			
PRINT SCALE: 1"=100'-0" (1:120) (1"=100'-0")																			
PRINT SCALE: 1"=100'-0" (1:120) (1"=100'-0")																			
PRINT SCALE: 1"=100'-0" (1:120) (1"=100'-0")																			
PRINT SCALE: 1"=100'-0" (1:120) (1"=100'-0")																			
PRINT SCALE: 1"=100'-0" (1:120) (1"=100'-0")																			
PRINT SCALE: 1"=100'-0" (1:120) (1"=100'-0")																			
PRINT SCALE: 1"=100'-0" (1:120) (1"=100'-0")																			
PRINT SCALE: 1"=100'-0" (1:120) (1"=100'-0")																			
PRINT SCALE: 1"=100'-0" (1:120) (1"=100'-0")																			
PRINT SCALE: 1"=100'-0" (1:120) (1"=100'-0")																			
PRINT SCALE: 1"=100'-0" (1:120) (1"=100'-0")																			
PRINT SCALE: 1"=100'-0" (1:120) (1"=100'-0")																			
PRINT SCALE: 1"=100'-0" (1:120) (1"=100'-0")																			
PRINT SCALE: 1"=100'-0" (1:120) (1"=100'-0")																			
PRINT SCALE: 1"=100'-0" (1:120) (1"=100'-0")																			
PRINT SCALE: 1"=100'-0" (1:120) (1"=100'-0")																			
PRINT SCALE: 1"=100'-0" (1:120) (1"=100'-0")																			
PRINT SCALE: 1"=100'-0" (1:120) (1"=100'-0")																			
PRINT SCALE: 1"=100'-0" (1:120) (1"=100'-0")																			
PRINT SCALE: 1"=100'-0" (1:120) (1"=100'-0")																			
PRINT SCALE: 1"=100'-0" (1:120) (1"=100'-0")																			
PRINT SCALE: 1"=100'-0" (1:120) (1"=100'-0")																			
PRINT SCALE: 1"=100'-0" (1:120) (1"=100'-0")																			
PRINT SCALE: 1"=100'-0" (1:120) (1"=100'-0")																			
PRINT SCALE: 1"=100'-0" (1:120) (1"=100'-0")																			
PRINT SCALE: 1"=100'-0" (1:120) (1"=100'-0")																			
PRINT SCALE: 1"=100'-0" (1:120) (1"=100'-0")																			
PRINT SCALE: 1"=100'-0" (1:120) (1"=100'-0")																			
PRINT SCALE: 1"=100'-0" (1:120) (1"=100'-0")																			
PRINT SCALE: 1"=100'-0" (1:120) (1"=100'-0")																			
PRINT SCALE: 1"=100'-0" (1:120) (1"=100'-0")																			
PRINT SCALE: 1"=100'-0" (1:120) (1"=100'-0")																			
PRINT SCALE: 1"=100'-0" (1:120) (1"=100'-0")																			
PRINT SCALE: 1"=100'-0" (1:120) (1"=100'-0")																			
PRINT SCALE: 1"=100'-0" (1:120) (1"=100'-0")																			
PRINT SCALE: 1"=100'-0" (1:120) (1"=100'-0")																			
PRINT SCALE: 1"=100'-0" (1:120) (1"=100'-0")																			
PRINT SCALE: 1"=100'-0" (1:120) (1"=100'-0")																			
PRINT SCALE: 1"=100'-0" (1:120) (1"=100'-0")																			
PRINT SCALE: 1"=100'-0" (1:120) (1"=100'-0")																			
PRINT SCALE: 1"=100'-0" (1:120) (1"=100'-0")																			
PRINT SCALE: 1"=100'-0" (1:120) (1"=100'-0")																			
PRINT SCALE: 1"=100'-0" (1:120) (1"=100'-0")																			
PRINT SCALE: 1"=100'-0" (1:120) (1"=100'-0")																			
PRINT SCALE: 1"=100'-0" (1:120) (1"=100'-0")																			
PRINT SCALE: 1"=100'-0" (1:120) (1"=100'-0")																			
PRINT SCALE: 1"=100'-0" (1:120) (1"=100'-0")																			
PRINT SCALE: 1"=100'-0" (1:120) (1"=100'-0")																			
PRINT SCALE: 1"=100'-0" (1:120) (1"=100'-0")																			
PRINT SCALE: 1"=100'-0" (1:120) (1"=100'-0")																			
PRINT SCALE: 1"=100'-0" (1:120) (1"=100'-0")																			
PRINT SCALE: 1"=100'-0" (1:120) (1"=100'-0")																			
PRINT SCALE: 1"=100'-0" (1:120) (1"=100'-0")																			
PRINT SCALE: 1"=100'-0" (1:120) (1"=100'-0")																			
PRINT SCALE: 1"=100'-0" (1:120) (1"=100'-0")																			
PRINT SCALE: 1"=100'-0" (1:120) (1"=100'-0")																			
PRINT SCALE: 1"=100'-0" (1:120) (1"=100'-0")																			
PRINT SCALE: 1"=100'-0" (1:120) (1"=100'-0")																			
PRINT SCALE: 1"=100'-0" (1:120) (1"=100'-0")																			
PRINT SCALE: 1"=100'-0" (1:120) (1"=100'-0")																			
PRINT SCALE: 1"=100'-0" (1:120) (1"=100'-0")																			
PRINT SCALE: 1"=100'-0" (1:120) (1"=100'-0")																			
PRINT SCALE: 1"=100'-0" (1:120) (1"=100'-0")																			
PRINT SCALE: 1"=100'-0" (1:120) (1"=100'-0")																			
PRINT SCALE: 1"=100'-0" (1:120) (1"=100'-0")																			
PRINT SCALE: 1"=100'-0" (1:120) (1"=100'-0")																			
PRINT SCALE: 1"=100'-0" (1:120) (1"=100'-0")																			
PRINT SCALE: 1"=100'-0" (1:120) (1"=100'-0")																			
PRINT SCALE: 1"=100'-0" (1:120) (1"=100'-0")																			
PRINT SCALE: 1"=100'-0" (1:120) (1"=100'-0")																			
PRINT SCALE: 1"=100'-0" (1:120) (1"=100'-0")																			
PRINT SCALE: 1"=100'-0" (1:120) (1"=100'-0")																			
PRINT SCALE: 1"=100'-0" (1:120) (1"=100'-0")																			
PRINT SCALE: 1"=100'-0" (1:120) (1"=100'-0")																			



Know what's below.

Chavez Tiffany & Ayer
Engineering Corporation
611 North Nevada Avenue
Colorado Springs, Colorado 80904
P 719/538-0071

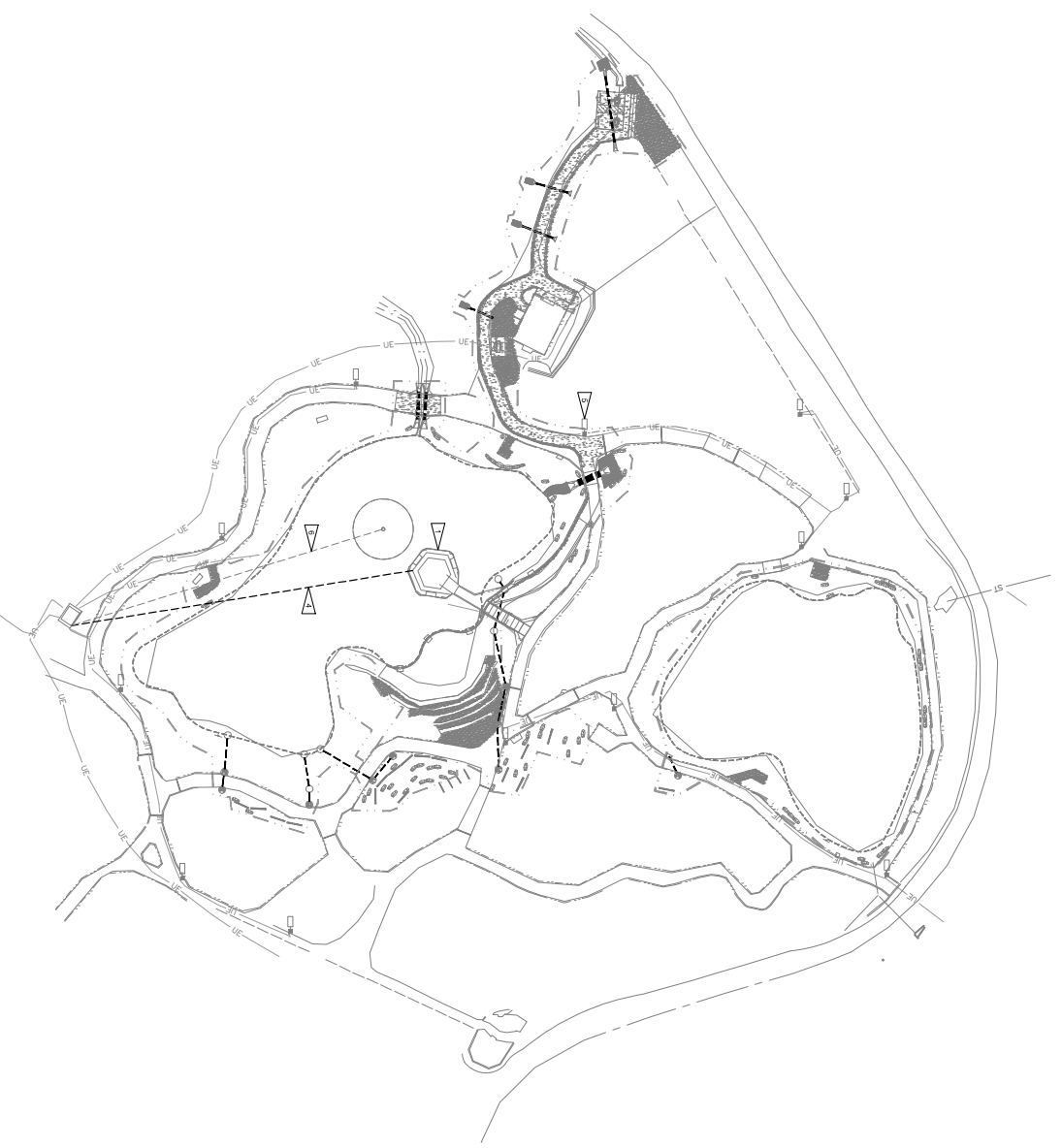

1 ELECTRICAL DEMO SITE PLAN
E3.0 SCALE: 1"=40'-0"

1 ELECTRICAL DEMO SITE PLAN
E3.0 SCALE: 1"=40'-0"

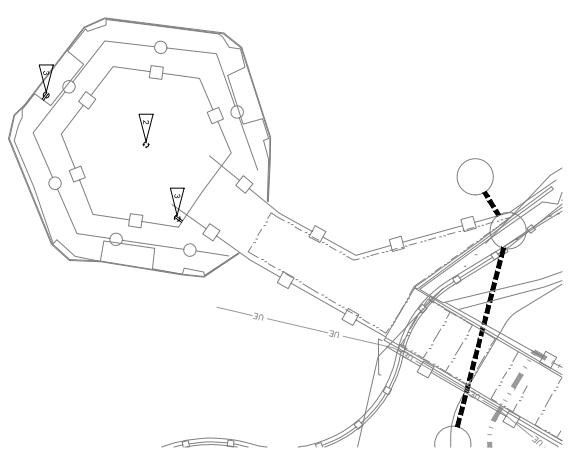

2 ENLARGED GAZEBO DEMO PLAN
E3.0 SCALE: 4/8"=1'-0"

2 ENLARGED GAZEBO DEMO PLAN
E3.0 SCALE: 4/8"=1'-0"

- FLAG NOTES:**
1. SEE PARAGRAPHS GAZEBO PLAYS FOR DEMOLISHED WORK.
 2. LIGHT FAILURE TO BE DEMOLISHED.
 3. RECEIPTS ARE TO BE DEMOLISHED.
 4. EXISTING UNDERGROUND SERVICE LINE SERVING EXISTING GAZEBO TO BE IN PLACE, DETECTED AND CAPPED OFF. ABANDONED UNDERGROUND SERVICE LINE TO BE REMOVED.
 5. ALL EXISTING PATHWAY GAZEBO LIGHTS TO REMAIN.
 6. EXISTING SERVICE LINE TO EXISTING FOUNTAIN TO BE PROTECTED AND REMAIN IN PLACE.

REFERENCE

DRAWINGS

DATE: 04/24/25 BY: JLM

PROJECT: FOX RUN REGIONAL PARK RENOVATION

SHEET: 10/1

10/1

COMPUTER FILE MANAGEMENT

CIT FILE: 10/1

DATE: 04/24/25 11:51 PM

PROJECT: FOX RUN REGIONAL PARK RENOVATION

PROJECT: FOX RUN REGIONAL PARK RENOVATION

PROJECT: FOX RUN REGIONAL PARK RENOVATION

PROJECT: FOX RUN REGIONAL PARK RENOVATION

PROJECT: FOX RUN REGIONAL PARK RENOVATION

PROJECT: FOX RUN REGIONAL PARK RENOVATION

PROJECT: FOX RUN REGIONAL PARK RENOVATION

PROJECT: FOX RUN REGIONAL PARK RENOVATION

PROJECT: FOX RUN REGIONAL PARK RENOVATION

PROJECT: FOX RUN REGIONAL PARK RENOVATION

PROJECT: FOX RUN REGIONAL PARK RENOVATION

PROJECT: FOX RUN REGIONAL PARK RENOVATION

PROJECT: FOX RUN REGIONAL PARK RENOVATION

PROJECT: FOX RUN REGIONAL PARK RENOVATION

PROJECT: FOX RUN REGIONAL PARK RENOVATION

PROJECT: FOX RUN REGIONAL PARK RENOVATION

PROJECT: FOX RUN REGIONAL PARK RENOVATION

PROJECT: FOX RUN REGIONAL PARK RENOVATION

PROJECT: FOX RUN REGIONAL PARK RENOVATION

PROJECT: FOX RUN REGIONAL PARK RENOVATION

PROJECT: FOX RUN REGIONAL PARK RENOVATION

PROJECT: FOX RUN REGIONAL PARK RENOVATION

PROJECT: FOX RUN REGIONAL PARK RENOVATION

PROJECT: FOX RUN REGIONAL PARK RENOVATION

PROJECT: FOX RUN REGIONAL PARK RENOVATION

PROJECT: FOX RUN REGIONAL PARK RENOVATION

PROJECT: FOX RUN REGIONAL PARK RENOVATION

PROJECT: FOX RUN REGIONAL PARK RENOVATION

PROJECT: FOX RUN REGIONAL PARK RENOVATION

PROJECT: FOX RUN REGIONAL PARK RENOVATION

PROJECT: FOX RUN REGIONAL PARK RENOVATION

PROJECT: FOX RUN REGIONAL PARK RENOVATION

PROJECT: FOX RUN REGIONAL PARK RENOVATION

PROJECT: FOX RUN REGIONAL PARK RENOVATION

PROJECT: FOX RUN REGIONAL PARK RENOVATION

PROJECT: FOX RUN REGIONAL PARK RENOVATION

PROJECT: FOX RUN REGIONAL PARK RENOVATION

PROJECT: FOX RUN REGIONAL PARK RENOVATION

PROJECT: FOX RUN REGIONAL PARK RENOVATION

PROJECT: FOX RUN REGIONAL PARK RENOVATION

PROJECT: FOX RUN REGIONAL PARK RENOVATION

PROJECT: FOX RUN REGIONAL PARK RENOVATION

PROJECT: FOX RUN REGIONAL PARK RENOVATION

PROJECT: FOX RUN REGIONAL PARK RENOVATION

PROJECT: FOX RUN REGIONAL PARK RENOVATION

PROJECT: FOX RUN REGIONAL PARK RENOVATION

PROJECT: FOX RUN REGIONAL PARK RENOVATION

PROJECT: FOX RUN REGIONAL PARK RENOVATION

PROJECT: FOX RUN REGIONAL PARK RENOVATION

PROJECT: FOX RUN REGIONAL PARK RENOVATION

PROJECT: FOX RUN REGIONAL PARK RENOVATION

PROJECT: FOX RUN REGIONAL PARK RENOVATION

PROJECT: FOX RUN REGIONAL PARK RENOVATION

PROJECT: FOX RUN REGIONAL PARK RENOVATION

PROJECT: FOX RUN REGIONAL PARK RENOVATION

PROJECT: FOX RUN REGIONAL PARK RENOVATION

PROJECT: FOX RUN REGIONAL PARK RENOVATION

PROJECT: FOX RUN REGIONAL PARK RENOVATION

PROJECT: FOX RUN REGIONAL PARK RENOVATION

PROJECT: FOX RUN REGIONAL PARK RENOVATION

PROJECT: FOX RUN REGIONAL PARK RENOVATION

PROJECT: FOX RUN REGIONAL PARK RENOVATION

PROJECT: FOX RUN REGIONAL PARK RENOVATION

PROJECT: FOX RUN REGIONAL PARK RENOVATION

PROJECT: FOX RUN REGIONAL PARK RENOVATION

PROJECT: FOX RUN REGIONAL PARK RENOVATION

PROJECT: FOX RUN REGIONAL PARK RENOVATION

PROJECT: FOX RUN REGIONAL PARK RENOVATION

PROJECT: FOX RUN REGIONAL PARK RENOVATION

PROJECT: FOX RUN REGIONAL PARK RENOVATION

PROJECT: FOX RUN REGIONAL PARK RENOVATION

PROJECT: FOX RUN REGIONAL PARK RENOVATION

PROJECT: FOX RUN REGIONAL PARK RENOVATION

PROJECT: FOX RUN REGIONAL PARK RENOVATION

PROJECT: FOX RUN REGIONAL PARK RENOVATION

PROJECT: FOX RUN REGIONAL PARK RENOVATION

PROJECT: FOX RUN REGIONAL PARK RENOVATION

PROJECT: FOX RUN REGIONAL PARK RENOVATION

PROJECT: FOX RUN REGIONAL PARK RENOVATION

PROJECT: FOX RUN REGIONAL PARK RENOVATION

PROJECT: FOX RUN REGIONAL PARK RENOVATION

PROJECT: FOX RUN REGIONAL PARK RENOVATION

PROJECT: FOX RUN REGIONAL PARK RENOVATION

PROJECT: FOX RUN REGIONAL PARK RENOVATION

PROJECT: FOX RUN REGIONAL PARK RENOVATION

PROJECT: FOX RUN REGIONAL PARK RENOVATION

PROJECT: FOX RUN REGIONAL PARK RENOVATION

PROJECT: FOX RUN REGIONAL PARK RENOVATION

PROJECT: FOX RUN REGIONAL PARK RENOVATION

PROJECT: FOX RUN REGIONAL PARK RENOVATION

PROJECT: FOX RUN REGIONAL PARK RENOVATION

PROJECT: FOX RUN REGIONAL PARK RENOVATION

PROJECT: FOX RUN REGIONAL PARK RENOVATION

PROJECT: FOX RUN REGIONAL PARK RENOVATION

PROJECT: FOX RUN REGIONAL PARK RENOVATION

PROJECT: FOX RUN REGIONAL PARK RENOVATION

PROJECT: FOX RUN REGIONAL PARK RENOVATION

PROJECT: FOX RUN REGIONAL PARK RENOVATION

PROJECT: FOX RUN REGIONAL PARK RENOVATION

PROJECT: FOX RUN REGIONAL PARK RENOVATION

PROJECT: FOX RUN REGIONAL PARK RENOVATION

PROJECT: FOX RUN REGIONAL PARK RENOVATION

PROJECT: FOX RUN REGIONAL PARK RENOVATION

PROJECT: FOX RUN REGIONAL PARK RENOVATION

PROJECT: FOX RUN REGIONAL PARK RENOVATION

PROJECT: FOX RUN REGIONAL PARK RENOVATION

PROJECT: FOX RUN REGIONAL PARK RENOVATION

PROJECT: FOX RUN REGIONAL PARK RENOVATION

PROJECT: FOX RUN REGIONAL PARK RENOVATION

PROJECT: FOX RUN REGIONAL PARK RENOVATION

PROJECT: FOX RUN REGIONAL PARK RENOVATION

PROJECT: FOX RUN REGIONAL PARK RENOVATION

PROJECT: FOX RUN REGIONAL PARK RENOVATION

PROJECT: FOX RUN REGIONAL PARK RENOVATION

PROJECT: FOX RUN REGIONAL PARK RENOVATION

PROJECT: FOX RUN REGIONAL PARK RENOVATION

PROJECT: FOX RUN REGIONAL PARK RENOVATION

PROJECT: FOX RUN REGIONAL PARK RENOVATION

PROJECT: FOX RUN REGIONAL PARK RENOVATION

PROJECT: FOX RUN REGIONAL PARK RENOVATION

PROJECT: FOX RUN REGIONAL PARK RENOVATION

PROJECT: FOX RUN REGIONAL PARK RENOVATION

PROJECT: FOX RUN REGIONAL PARK RENOVATION

PROJECT: FOX RUN REGIONAL PARK RENOVATION

PROJECT: FOX RUN REGIONAL PARK RENOVATION

PROJECT: FOX RUN REGIONAL PARK RENOVATION

PROJECT: FOX RUN REGIONAL PARK RENOVATION

PROJECT: FOX RUN REGIONAL PARK RENOVATION

PROJECT: FOX RUN REGIONAL PARK RENOVATION

PROJECT: FOX RUN REGIONAL PARK RENOVATION

PROJECT: FOX RUN REGIONAL PARK RENOVATION

PROJECT: FOX RUN REGIONAL PARK RENOVATION

PROJECT: FOX RUN REGIONAL PARK RENOVATION

PROJECT: FOX RUN REGIONAL PARK RENOVATION

PROJECT: FOX RUN REGIONAL PARK RENOVATION

PROJECT: FOX RUN REGIONAL PARK RENOVATION

PROJECT: FOX RUN REGIONAL PARK RENOVATION

PROJECT: FOX RUN REGIONAL PARK RENOVATION

PROJECT: FOX RUN REGIONAL PARK RENOVATION

PROJECT: FOX RUN REGIONAL PARK RENOVATION

PROJECT: FOX RUN REGIONAL PARK RENOVATION

PROJECT: FOX RUN REGIONAL PARK RENOVATION

PROJECT: FOX RUN REGIONAL PARK RENOVATION

PROJECT: FOX RUN REGIONAL PARK RENOVATION

PROJECT: FOX RUN REGIONAL PARK RENOVATION

PROJECT: FOX RUN REGIONAL PARK RENOVATION

PROJECT: FOX RUN REGIONAL PARK RENOVATION

PROJECT: FOX RUN REGIONAL PARK RENOVATION

PROJECT: FOX RUN REGIONAL PARK RENOVATION

PROJECT: FOX RUN REGIONAL PARK RENOVATION

PROJECT: FOX RUN REGIONAL PARK RENOVATION

PROJECT: FOX RUN REGIONAL PARK RENOVATION

PROJECT: FOX RUN REGIONAL PARK RENOVATION

PROJECT: FOX RUN REGIONAL PARK RENOVATION

PROJECT: FOX RUN REGIONAL PARK RENOVATION

PROJECT: FOX RUN REGIONAL PARK RENOVATION

PROJECT: FOX RUN REGIONAL PARK RENOVATION

PROJECT: FOX RUN REGIONAL PARK RENOVATION

PROJECT: FOX RUN REGIONAL PARK RENOVATION

PROJECT: FOX RUN REGIONAL PARK RENOVATION

PROJECT: FOX RUN REGIONAL PARK RENOVATION

PROJECT: FOX RUN REGIONAL PARK RENOVATION

PROJECT: FOX RUN REGIONAL PARK RENOVATION

PROJECT: FOX RUN REGIONAL PARK RENOVATION

PROJECT: FOX RUN REGIONAL PARK RENOVATION

PROJECT: FOX RUN REGIONAL PARK RENOVATION

PROJECT: FOX RUN REGIONAL PARK RENOVATION

PROJECT: FOX RUN REGIONAL PARK RENOVATION

PROJECT: FOX RUN REGIONAL PARK RENOVATION

PROJECT: FOX RUN REGIONAL PARK RENOVATION

PROJECT: FOX RUN REGIONAL PARK RENOVATION

PROJECT: FOX RUN REGIONAL PARK RENOVATION

PROJECT: FOX RUN REGIONAL PARK RENOVATION

PROJECT: FOX RUN REGIONAL PARK RENOVATION

PROJECT: FOX RUN REGIONAL PARK RENOVATION

PROJECT: FOX RUN REGIONAL PARK RENOVATION

PROJECT: FOX RUN REGIONAL PARK RENOVATION

PROJECT: FOX RUN REGIONAL PARK RENOVATION

PROJECT: FOX RUN REGIONAL PARK RENOVATION

PROJECT: FOX RUN REGIONAL PARK RENOVATION

PROJECT: FOX RUN REGIONAL PARK RENOVATION

PROJECT: FOX RUN REGIONAL PARK RENOVATION

PROJECT: FOX RUN REGIONAL PARK RENOVATION

PROJECT: FOX RUN REGIONAL PARK RENOVATION

PROJECT: FOX RUN REGIONAL PARK RENOVATION

PROJECT: FOX RUN REGIONAL PARK RENOVATION

PROJECT: FOX RUN REGIONAL PARK RENOVATION

PROJECT: FOX RUN REGIONAL PARK RENOVATION

PROJECT: FOX RUN REGIONAL PARK RENOVATION

PROJECT: FOX RUN REGIONAL PARK RENOVATION

PROJECT: FOX RUN REGIONAL PARK RENOVATION

PROJECT: FOX RUN REGIONAL PARK RENOVATION

PROJECT: FOX RUN REGIONAL PARK RENOVATION

PROJECT: FOX RUN REGIONAL PARK RENOVATION

PROJECT: FOX RUN REGIONAL PARK RENOVATION

PROJECT: FOX RUN REGIONAL PARK RENOVATION

PROJECT: FOX RUN REGIONAL PARK RENOVATION

PROJECT: FOX RUN REGIONAL PARK RENOVATION

PROJECT: FOX RUN REGIONAL PARK RENOVATION

PROJECT: FOX RUN REGIONAL PARK RENOVATION

PROJECT: FOX RUN REGIONAL PARK RENOVATION

PROJECT: FOX RUN REGIONAL PARK RENOVATION

PROJECT: FOX RUN REGIONAL PARK RENOVATION

PROJECT: FOX RUN REGIONAL PARK RENOVATION

PROJECT: FOX RUN REGIONAL PARK RENOVATION

PROJECT: FOX RUN REGIONAL PARK RENOVATION

PROJECT: FOX RUN REGIONAL PARK RENOVATION

PROJECT: FOX RUN REGIONAL PARK RENOVATION

PROJECT: FOX RUN REGIONAL PARK RENOVATION

PROJECT: FOX RUN REGIONAL PARK RENOVATION

PROJECT: FOX RUN REGIONAL PARK RENOVATION

PROJECT: FOX RUN REGIONAL PARK RENOVATION

PROJECT: FOX RUN REGIONAL PARK RENOVATION

PROJECT: FOX RUN REGIONAL PARK RENOVATION

PROJECT: FOX RUN REGIONAL PARK RENOVATION

PROJECT: FOX RUN REGIONAL PARK RENOVATION

PROJECT: FOX RUN REGIONAL PARK RENOVATION

PROJECT: FOX RUN REGIONAL PARK RENOVATION

PROJECT: FOX RUN REGIONAL PARK RENOVATION

PROJECT: FOX RUN REGIONAL PARK RENOVATION

PROJECT: FOX RUN REGIONAL PARK RENOVATION

PROJECT: FOX RUN REGIONAL PARK RENOVATION

PROJECT: FOX RUN REGIONAL PARK RENOVATION

PROJECT: FOX RUN REGIONAL PARK RENOVATION

PROJECT: FOX RUN REGIONAL PARK RENOVATION

PROJECT: FOX RUN REGIONAL PARK RENOVATION

PROJECT: FOX RUN REGIONAL PARK RENOVATION



PROJECT: FOX RUN REGIONAL PARK RENOVATION

PROJECT: FOX RUN REGIONAL PARK RENOVATION

PROJECT: FOX RUN REGIONAL PARK RENOVATION

PROJECT: FOX RUN REGIONAL PARK RENOVATION

[illegible]

<div>REFERENCE</div> <table><tr><th>NO.</th><th>DATE</th><th>DESCRIPTION</th></tr><tr><td>01</td><td>02</td><td>03</td></tr><tr><td>02</td><td>03</td><td>04</td></tr><tr><td>03</td><td>04</td><td>05</td></tr><tr><td>04</td><td>05</td><td>06</td></tr><tr><td>05</td><td>06</td><td>07</td></tr><tr><td>06</td><td>07</td><td>08</td></tr><tr><td>07</td><td>08</td><td>09</td></tr><tr><td>08</td><td>09</td><td>10</td></tr><tr><td>09</td><td>10</td><td>11</td></tr><tr><td>10</td><td>11</td><td>12</td></tr></table>										NO.	DATE	DESCRIPTION	01	02	03	02	03	04	03	04	05	04	05	06	05	06	07	06	07	08	07	08	09	08	09	10	09	10	11	10	11	12	<div>SHEET KEY</div> <div></div>									
NO.	DATE	DESCRIPTION																																																		
01	02	03																																																		
02	03	04																																																		
03	04	05																																																		
04	05	06																																																		
05	06	07																																																		
06	07	08																																																		
07	08	09																																																		
08	09	10																																																		
09	10	11																																																		
10	11	12																																																		
<div>REVISIONS</div> <table><tr><th>NO.</th><th>DATE</th><th>DESCRIPTION</th></tr></table>										NO.	DATE	DESCRIPTION	<div>VERTICAL DATUM</div> <p>166.000 (5.127) AT JUANITA HILL C&G STATION, 96.10' INLAND, BOX LOCATED APPROXIMATELY 25 FEET EAST OF INTERSECTION AND 100 FEET SOUTH OF MOUNTAIN PINE, LAMAR, A DISTANCE OF 1.000 (27.94) FROM THE CENTER OF THE ROAD.</p>																																							
NO.	DATE	DESCRIPTION																																																		
<div>COMPUTER FILE MANAGEMENT</div> <p>FILE NAME: 2.15046 - Project for San Regional Park - Photo Project Black Box Run Regional Park, Project ELEC.DWG CIRCUIT: 15046 DATE: 11/15/01 DRAWN BY: J. L. B. (JLB) CHECKED BY: J. L. B. (JLB) PROJECT NO: 15046</p>										<div>HORIZONTAL DATUM</div> <p>THE SURVEY WAS PERFORMED UTILIZING GROUND COORDINATES WITHIN THE COLORADO STATE COORDINATE SYSTEM. THE DATUM WAS SCALLED FROM 0.00' WITH A CORRECTION FACTOR OF 1.0001 (27.94).</p>																																										
<div>REMARKS</div>										<div>SEAL</div> <div></div> <p>4465</p>																																										
<div>FOX AND GAZERO POND</div> <p>DESIGNED BY: JLB CHECKED BY: JLB PROJECT NO: 15046</p>										<div>NEW PAVILION</div> <p>FOX RUN REGIONAL PARK POND AND GAZERO RENOVATION</p>																																										
<div>LIGHT FIXTURE CUT SHEETS</div>																																																				



NLS
LIGHTING

SEA SIDE BOLLARD



STOCK POWERED OPTICAL SYSTEMS

The first Power[™] reference in an essential system: submicron-scale grating rules used for lithography. For more Product literature, call 707/444-0000

Project/Phase	Type
---------------	------

COORDINATE FINISH COLOR OF FIXTURE WITH OWNER PRIOR TO ORDERING				
Exterior	Interior	Hardware	Door	Options

[illegible]

PRODUCTION SPECIFICATIONS

REMARKS

1. The above information is for reference only and is not intended to be used as a basis for any other purpose.

PHOTOGRAPHY BY GARY W. GILES

NEW YORK POLYGRAPH - LAMAR BROWN COMPANY

[illegible]

FOX RUN REGIONAL PARK POND AND GAZEBO RENOVATION

DESIGNED BY:	JJA	SCALE	DATE ISSUED:	4/4/2024	DRAWING No.
DRAWN BY:	ELR	HORIZ.	34		
CHECKED BY:	JJA	VERT.	22	SHEET	33 OF 33
					E5.2

SHEET KEY		VERTICAL DATUM 1 + 156.00 BENCH 1.25' ALUMINUM HING C/ STAPLED 96" IN RADIUS BOX LOCATED APPROXIMATELY 25' NORTHEAST OF THE MONUMENT IN THE DAMBORA CREEK BEDDED AROUND ELEVATION OF 71.88' IN US SURVEY FEET.	
HORIZONTAL DATUM THE SURVEY WAS PERFORMED INCLUDING GROUND COMPANIES WITHIN THE COLORADO STATE SURVEY. THE HORIZONTAL DATUM WAS SCALED FROM 0.999943 TO GROUND CONVERSION FACTOR OF 1.000127182.		RECORDABLE	
Matrix		SEAL  4465	
FOX RUN REGIONAL PARK POND AND GAZEBO RENOVATION		NEW PAVILION	
LIGHTING FIXTURE CUT SHEETS		FOX RUN REGIONAL PARK POND AND GAZEBO RENOVATION	
DESIGNED BY: JLM	CHECKED: JLM	DATE: 01/11/2024	DATE: 01/11/2024
DRAWN BY: JLM	DATE: 01/11/2024	DATE: 01/11/2024	DATE: 01/11/2024
PROJECT NO.: 24-237-008	PROJECT NO.: 24-237-008	PROJECT NO.: 24-237-008	PROJECT NO.: 24-237-008