

EL PASO COUNTY

CONSTRUCTION BID PLANS OF THE PROPOSED CIVIL ENGINEERING DESIGN SERVICES FURROW ROAD IMPROVEMENTS MONUMENT, COLORADO

CONSTRUCTION PROJECT CODE NO. 22894

PROJECT DESCRIPTION

THIS PROJECT IS LOCATED IN EL PASO COUNTY COLORADO AND CONSISTS OF THE ADDITION OF
2 MINI CIRCULAR INTERSECTIONS AT FURROW ROAD / MINGLEWOOD TRAIL

ADDENDUM #1 MINI CIRCULAR INTERSECTION IMPROVEMENTS FOR CONSTRUCTION – FEBRUARY 20, 2026

SHEET NO.	INDEX OF SHEETS
1	TITLE SHEET
2	SUMMARY OF APPROXIMATE QUANTITIES
3-4	MINI CIRCULAR INTERSECTION DETAILS
5-6	FOR INFORMATION ONLY
7-8	EROSION CONTROL/STORMWATER MANAGEMENT PLANS
9-10	LIGHTING PLANS
11	LIGHTING SCHEDULE

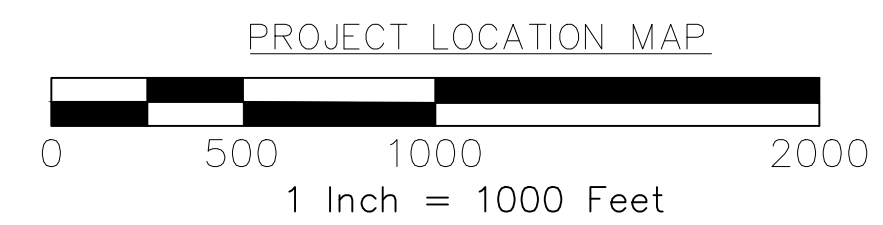

Design Engineer's Statement:

The attached plans and specifications were prepared under my responsible charge and in accordance with the applicable standard of care. To the extent consistent with that standard of care, the plans and specifications were prepared in general conformance with the criteria established by the County and are consistent with applicable master drainage plans and master transportation plans. I accept responsibility for my professional services in the preparation of these plans and specifications.



Tracy M. Lawless

TRACY M. LAWLESS, PE #35321

02/17/2026
DATE

County Engineer's Statement:

County plan review is provided solely for general conformance with County Design Criteria. The County is not responsible for the accuracy or adequacy of the plans and specifications, and acceptance of these documents does not constitute an assumption of responsibility for their completeness or accuracy.

Joshua J. Palmer

JOSHUA J. PALMER, P.E.
COUNTY ENGINEER/ ECM ADMINISTRATOR

3/10/26
DATE



C:\USERS\MOCHAPMAN\DCI\ACDDOCS\STANTEC CONSULTING\181711218_FURROW_ROAD\PROJECT FILES\600_CAD\640_SHEET_FILES\MCI PLAN SET\MCI 11218-TITLE SHEET.DWG

Print Date: 2/12/2026

File Name: MCI 11218-TITLE SHEET.DWG

Horiz. Scale: Vert. Scale:

County Project Manager – Alissa Werre



410 17th Street
SUITE 1400
DENVER, COLORADO 80202-4427
(303) 295-1717

Sheet Revisions		
Date:	Comments	Init.



DEPARTMENT OF
PUBLIC WORKS
3275 AKERS DRIVE
COLORADO SPRINGS,
CO 80922

As Constructed

No Revisions:

Revised:

Void:

TITLE SHEET

Designer: MC

Detailer: WR

Sheet Subset:

Structure

Numbers

Subset Sheets:

Project Number

181711218

Sheet Number 1

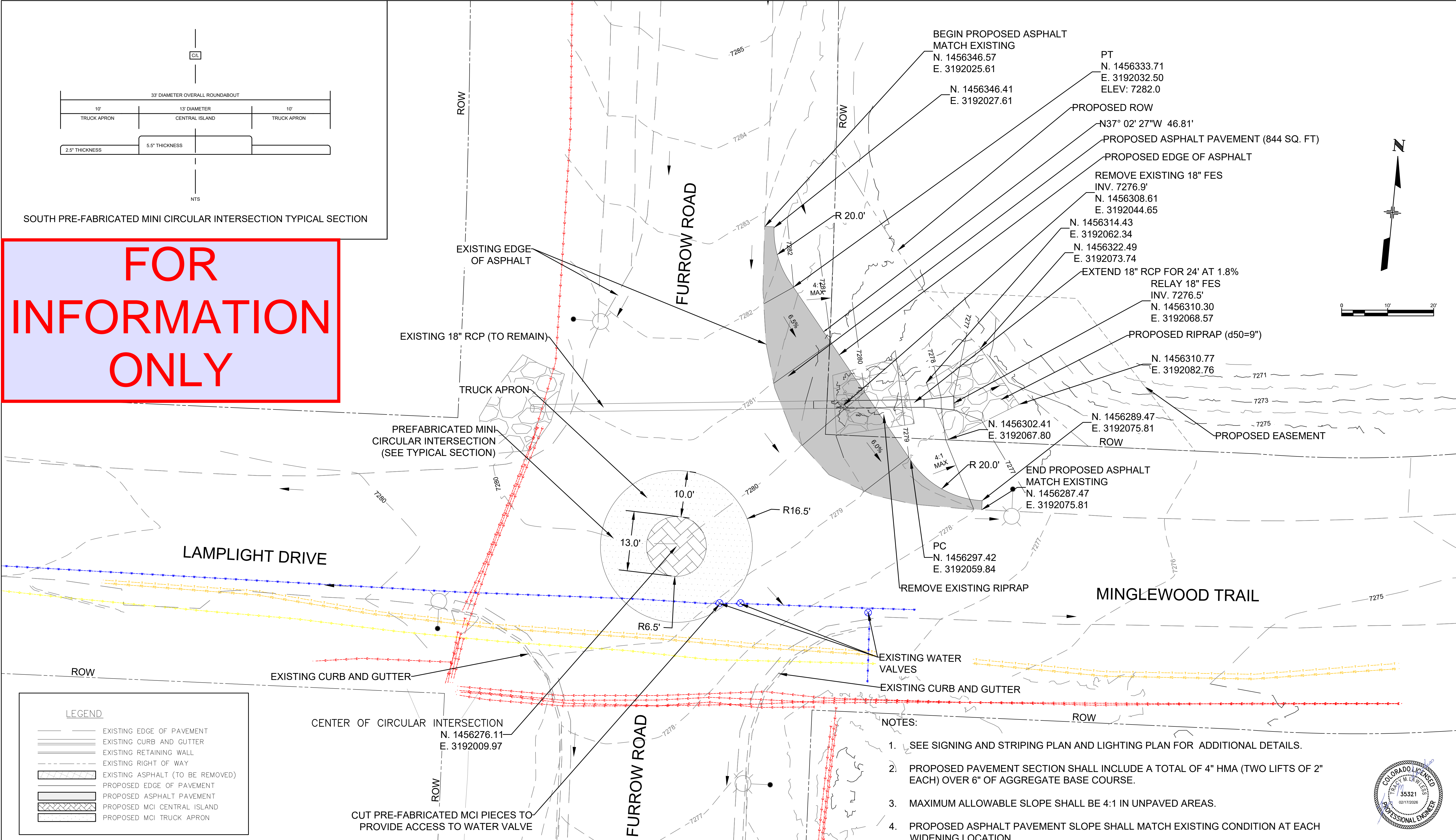

**FOR
INFORMATION
ONLY**

LEGEND

	EXISTING EDGE OF PAVEMENT
	EXISTING CURB AND GUTTER
	EXISTING RETAINING WALL
	EXISTING RIGHT OF WAY
	EXISTING ASPHALT (TO BE REMOVED)
	PROPOSED EDGE OF PAVEMENT
	PROPOSED ASPHALT PAVEMENT
	PROPOSED MCI CENTRAL ISLAND
	PROPOSED MCI TRUCK APRON

- NOTES:**
- SEE SIGNING AND STRIPING PLAN AND LIGHTING PLAN FOR ADDITIONAL DETAILS.
 - PROPOSED PAVEMENT SECTION SHALL INCLUDE A TOTAL OF 4" HMA (TWO LIFTS OF 2" EACH) OVER 6" OF AGGREGATE BASE COURSE.
 - MAXIMUM ALLOWABLE SLOPE SHALL BE 4:1 IN UNPAVED AREAS.
 - PROPOSED ASPHALT PAVEMENT SLOPE SHALL MATCH EXISTING CONDITION AT EACH WIDENING LOCATION.



Print Date: 1/27/2026
 File Name: MCI 11218-ROUNDBOUT DETAILS.DWG
 Horiz. Scale: 1"=10' Vert. Scale:
 County Project Manager - Alissa Werre
 410 17th Street
 SUITE 1400
 DENVER, COLORADO 80202-4427
 (303) 295-1717

Sheet Revisions

Date:	Comments	Init.



DEPARTMENT OF PUBLIC WORKS
 3275 AKERS DRIVE
 COLORADO SPRINGS,
 CO 80922

As Constructed	MINI CIRCULAR INTERSECTION DETAILS - SOUTH		Project Number 181711218
No Revisions:	Designer: MC	Structure Numbers	Sheet Number 3
Revised:	Detailer: WR	Subst Sheets: 1 OF 2	
Void:	Sheet Subset:	Subst Sheets: 1 OF 2	

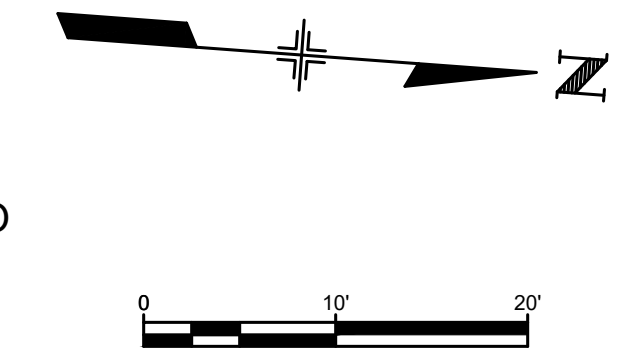

NOTES:

1. SEE SIGNING AND STRIPING PLAN AND LIGHTING PLAN FOR ADDITIONAL DETAILS.
2. PROPOSED PAVEMENT SECTION SHALL INCLUDE A TOTAL OF 4" HMA (TWO LIFTS OF 2" EACH) OVER 6" OF AGGREGATE BASE COURSE.
3. MAXIMUM ALLOWABLE SLOPE SHALL BE 4:1 IN UNPAVED AREAS.
4. PROPOSED ASPHALT PAVEMENT SLOPE SHALL MATCH EXISTING CONDITION AT EACH WIDENING LOCATION.

**FOR
INFORMATION
ONLY**

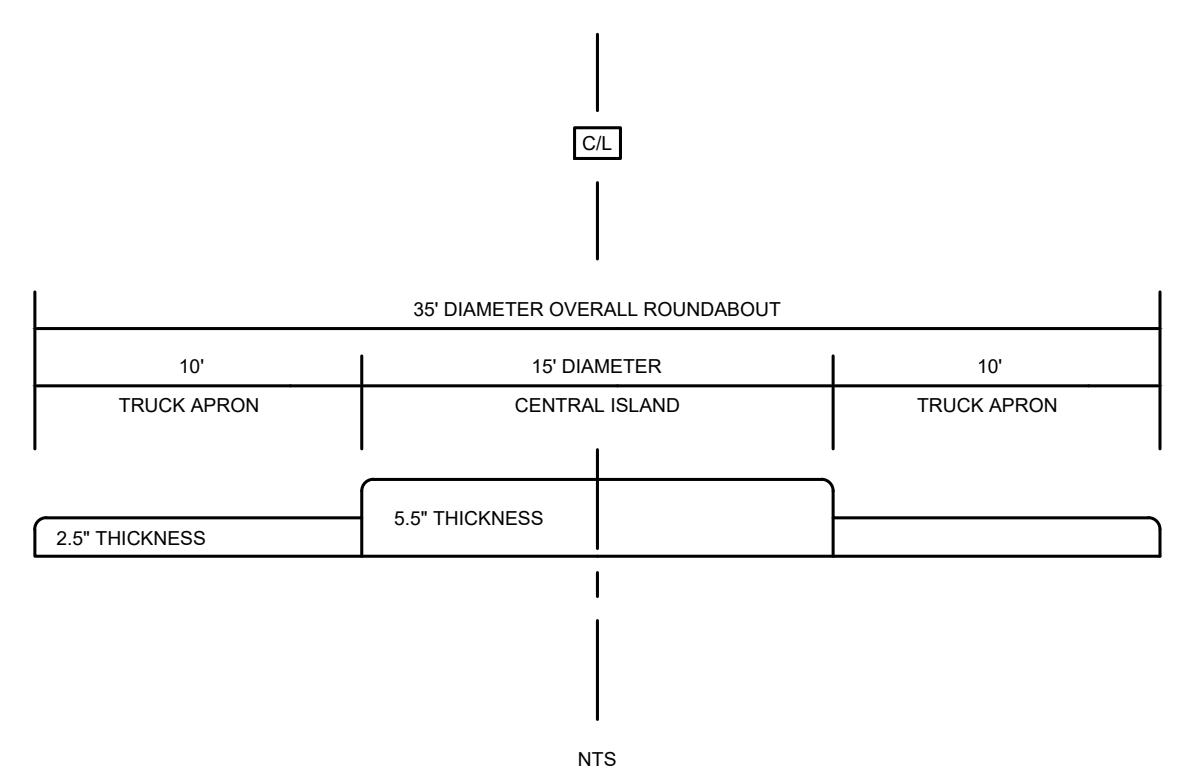

NORTH PRE-FABRICATED MINI CIRCULAR INTERSECTION TYPICAL SECTION

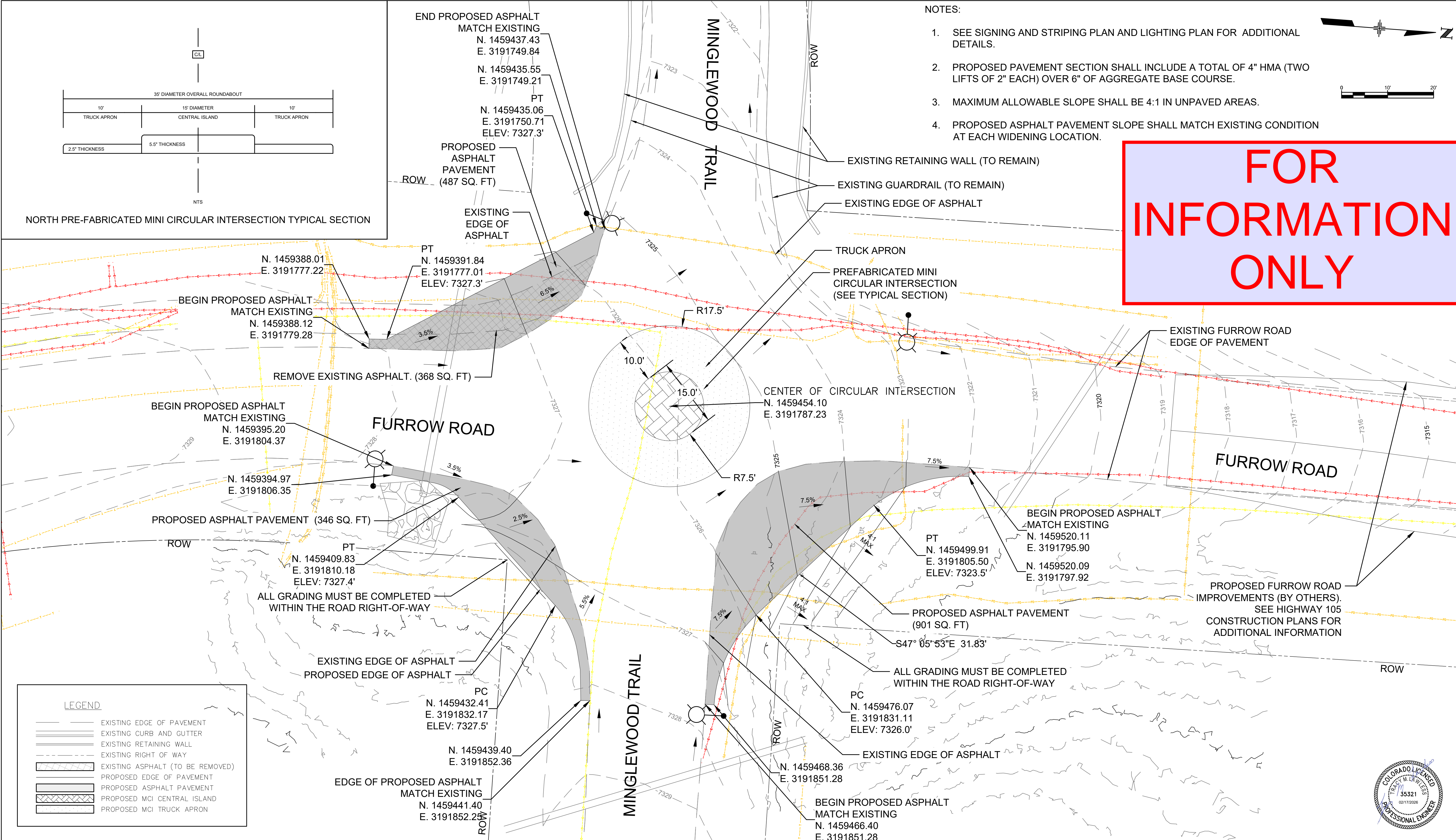

LEGEND

	EXISTING EDGE OF PAVEMENT
	EXISTING CURB AND GUTTER
	EXISTING RETAINING WALL
	EXISTING RIGHT OF WAY
	EXISTING ASPHALT (TO BE REMOVED)
	PROPOSED EDGE OF PAVEMENT
	PROPOSED ASPHALT PAVEMENT
	PROPOSED MCI CENTRAL ISLAND
	PROPOSED MCI TRUCK APRON

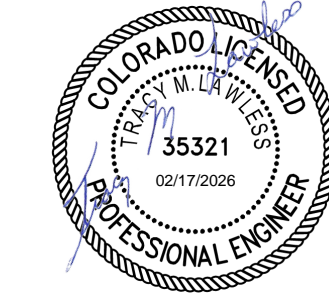

Print Date: 1/27/2026
 File Name: MCI 11218-ROUNDBOUT DETAILS.DWG
 Horiz. Scale: 1"=10' Vert. Scale:
 County Project Manager - Alissa Werre
 410 17th Street
 SUITE 1400
 DENVER, COLORADO 80202-4427
 (303) 295-1717

Sheet Revisions

Date:	Comments	Init.



DEPARTMENT OF PUBLIC WORKS
 3275 AKERS DRIVE
 COLORADO SPRINGS,
 CO 80922

As Constructed
No Revisions:
Revised:
Void:

MINI CIRCULAR INTERSECTION DETAILS - NORTH			
Designer:	MC	Structure Numbers	
Detailer:	WR		
Sheet Subset:		Subset Sheets:	2 OF 2

Project Number
181711218
Sheet Number 4

FOR INFORMATION ONLY

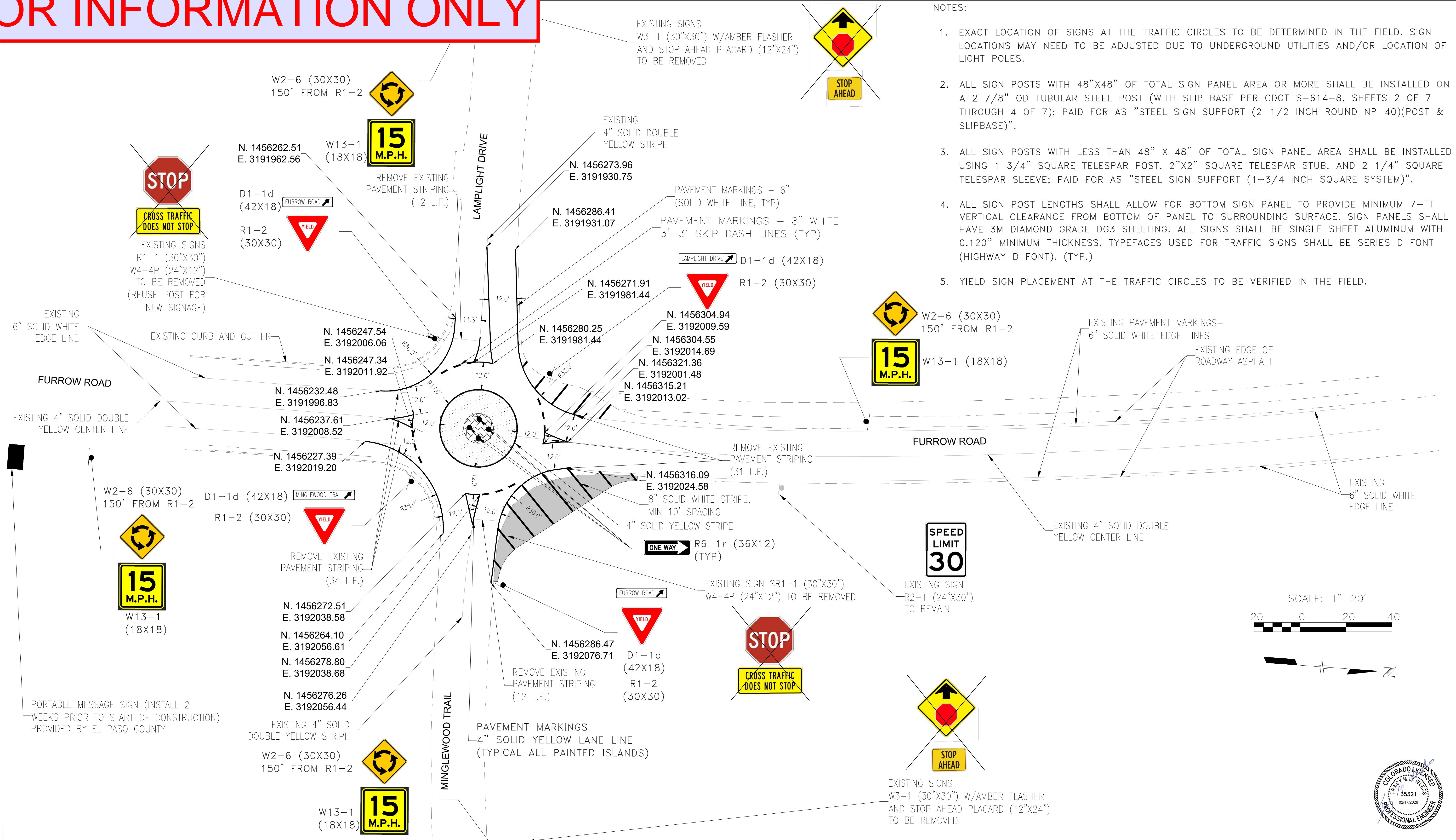

- NOTES:
1. EXACT LOCATION OF SIGNS AT THE TRAFFIC CIRCLES TO BE DETERMINED IN THE FIELD. SIGN LOCATIONS MAY NEED TO BE ADJUSTED DUE TO UNDERGROUND UTILITIES AND/OR LOCATION OF LIGHT POLES.
 2. ALL SIGN POSTS WITH 48"X48" OF TOTAL SIGN PANEL AREA OR MORE SHALL BE INSTALLED ON A 2 7/8" OD TUBULAR STEEL POST (WITH SLIP BASE PER CDOT S-614-8, SHEETS 2 OF 7 THROUGH 4 OF 7); PAID FOR AS "STEEL SIGN SUPPORT (2-1/2 INCH ROUND NP-40)(POST & SLIPBASE)".
 3. ALL SIGN POSTS WITH LESS THAN 48" X 48" OF TOTAL SIGN PANEL AREA SHALL BE INSTALLED USING 1 3/4" SQUARE TELES PAR POST, 2"X2" SQUARE TELES PAR STUB, AND 2 1/4" SQUARE TELES PAR SLEEVE; PAID FOR AS "STEEL SIGN SUPPORT (1-3/4 INCH SQUARE SYSTEM)".
 4. ALL SIGN POST LENGTHS SHALL ALLOW FOR BOTTOM SIGN PANEL TO PROVIDE MINIMUM 7-FT VERTICAL CLEARANCE FROM BOTTOM OF PANEL TO SURROUNDING SURFACE. SIGN PANELS SHALL HAVE 3M DIAMOND GRADE DG3 SHEETING. ALL SIGNS SHALL BE SINGLE SHEET ALUMINUM WITH 0.120" MINIMUM THICKNESS. TYPEFACES USED FOR TRAFFIC SIGNS SHALL BE SERIES D FONT (HIGHWAY D FONT). (TYP.)
 5. YIELD SIGN PLACEMENT AT THE TRAFFIC CIRCLES TO BE VERIFIED IN THE FIELD.

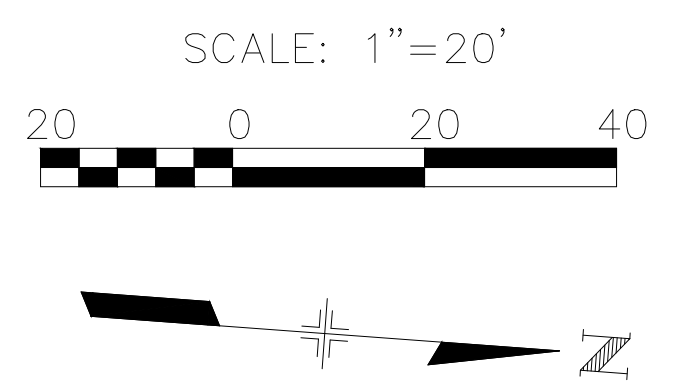

Print Date: 1/27/2026
 File Name: MCI 11218-SIGNING_STRIPING PLAN.DWG
 Horiz. Scale: 1" = 20' Vert. Scale:
 County Project Manager - Alissa Werre
 410 17th Street
 SUITE 1400
 DENVER, COLORADO 80202-4427
 (303) 295-1717

Sheet Revisions		
Date:	Comments	Init.

EL PASO COUNTY
 COLORADO

DEPARTMENT OF PUBLIC WORKS
 3275 AKERS DRIVE
 COLORADO SPRINGS, CO 80922

As Constructed	SIGNING AND STRIPING PLAN SOUTH	
No Revisions:	Designer: MC	Structure Numbers:
Revised:	Detailer: WR	
Void:	Sheet Subset:	Subset Sheets: 1 OF 2

Project Number
181711218

Sheet Number **5**

NOTES:

1. EXACT LOCATION OF SIGNS AT THE TRAFFIC CIRCLES TO BE DETERMINED IN THE FIELD. SIGN LOCATIONS MAY NEED TO BE ADJUSTED DUE TO UNDERGROUND UTILITIES AND/OR LOCATION OF LIGHT POLES.
2. ALL SIGN POSTS WITH 48"X48" OF TOTAL SIGN PANEL AREA OR MORE SHALL BE INSTALLED ON A 2 7/8" OD TUBULAR STEEL POST (WITH SLIP BASE PER CDOT S-614-8, SHEETS 2 OF 7 THROUGH 4 OF 7); PAID FOR AS "STEEL SIGN SUPPORT (2-1/2 INCH ROUND NP-40)(POST & SLIPBASE)".
3. ALL SIGN POSTS WITH LESS THAN 48" X 48" OF TOTAL SIGN PANEL AREA SHALL BE INSTALLED USING 1 3/4" SQUARE TELES PAR POST, 2"X2" SQUARE TELES PAR STUB, AND 2 1/4" SQUARE TELES PAR SLEEVE; PAID FOR AS "STEEL SIGN SUPPORT (1-3/4 INCH SQUARE SYSTEM)".
4. ALL SIGN POST LENGTHS SHALL ALLOW FOR BOTTOM SIGN PANEL TO PROVIDE MINIMUM 7-FT VERTICAL CLEARANCE FROM BOTTOM OF PANEL TO SURROUNDING SURFACE. SIGN PANELS SHALL HAVE 3M DIAMOND GRADE DG3 SHEETING. ALL SIGNS SHALL BE SINGLE SHEET ALUMINUM WITH 0.120" MINIMUM THICKNESS. TYPEFACES USED FOR TRAFFIC SIGNS SHALL BE SERIES D FONT (HIGHWAY D FONT). (TYP.)
5. YIELD SIGN PLACEMENT AT THE TRAFFIC CIRCLES TO BE VERIFIED IN THE FIELD.

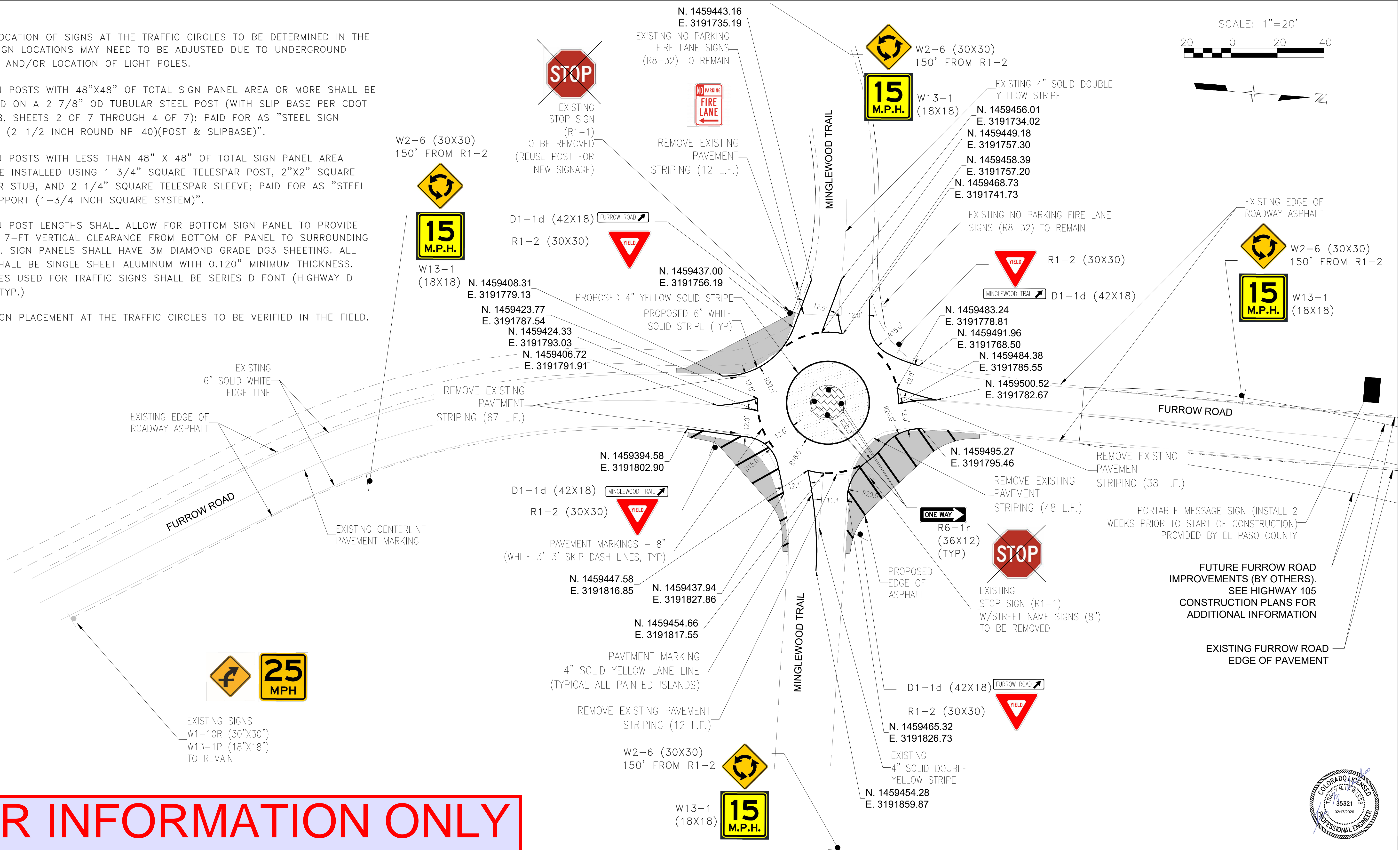
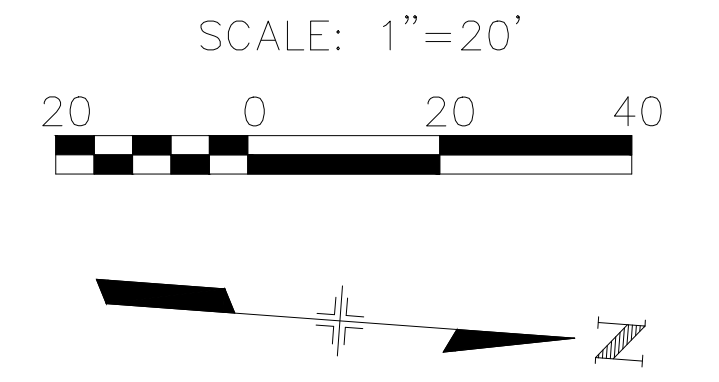

FOR INFORMATION ONLY

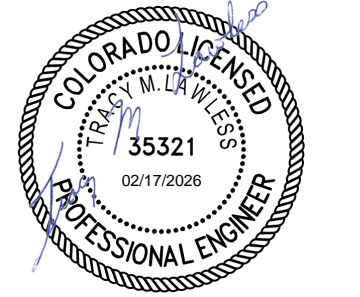

Print Date: 1/27/2026
 File Name: MCI 11218-SIGNING_STRIPING PLAN.DWG
 Horiz. Scale: 1" = 20' Vert. Scale:
 County Project Manager - Alissa Werre
Stantec
 410 17th Street
 SUITE 1400
 DENVER, COLORADO 80202-4427
 (303) 295-1717

Sheet Revisions		
Date:	Comments	Init.

EL PASO COUNTY
 COLORADO
 DEPARTMENT OF PUBLIC WORKS
 3275 AKERS DRIVE
 COLORADO SPRINGS,
 CO 80922

As Constructed	SIGNING AND STRIPING PLAN NORTH		Project Number
No Revisions:			181711218
Revised:	Designer: MC	Structure Numbers	Sheet Number 6
Void:	Detailer: WR	Subst Sheets: 2 OF 2	

FOR INFORMATION ONLY

EROSION CONTROL LEGEND

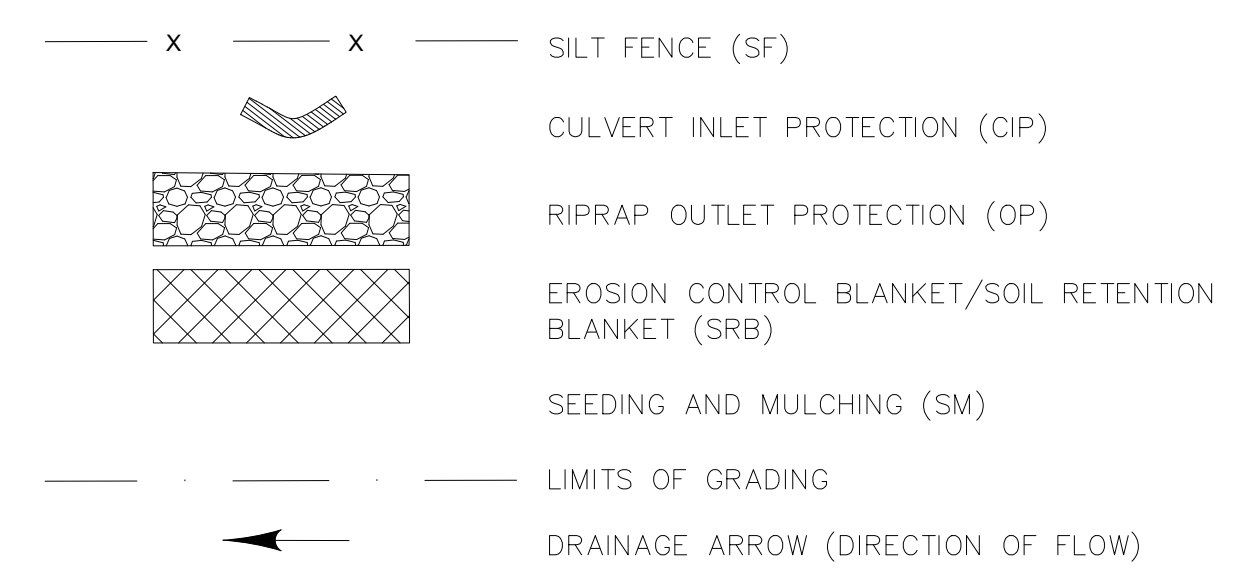

NOTE: HATCHING IS FOR GENERAL REFERENCE ONLY.

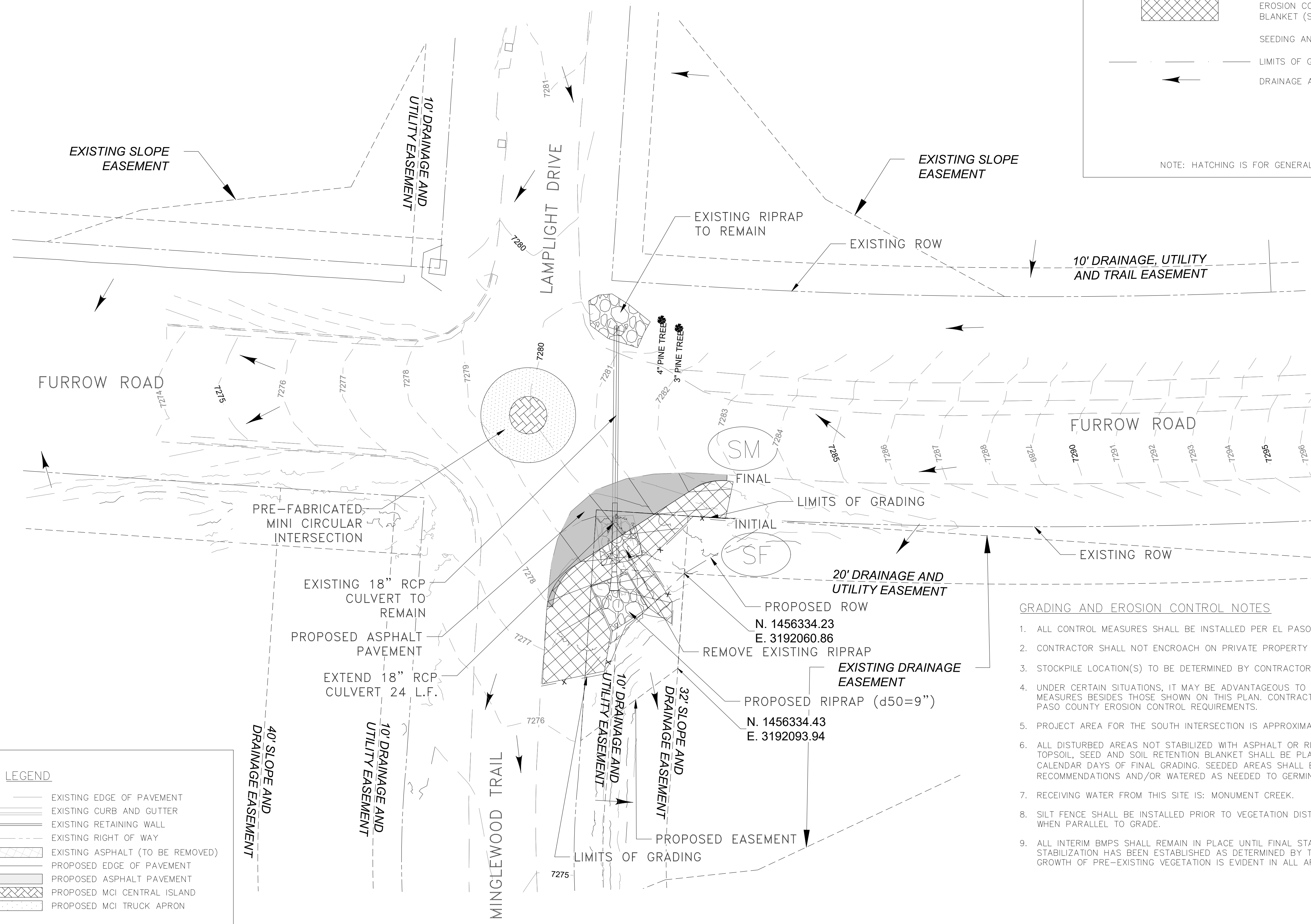
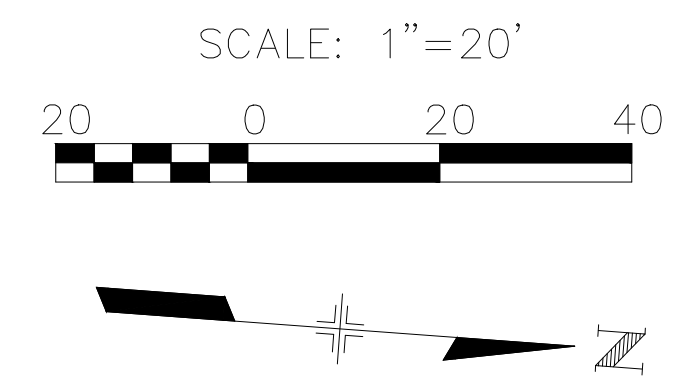

GRADING AND EROSION CONTROL NOTES

- ALL CONTROL MEASURES SHALL BE INSTALLED PER EL PASO COUNTY CRITERIA.
- CONTRACTOR SHALL NOT ENCROACH ON PRIVATE PROPERTY UNLESS CONSTRUCTION EASEMENTS HAVE BEEN OBTAINED.
- STOCKPILE LOCATION(S) TO BE DETERMINED BY CONTRACTOR, IF NEEDED.
- UNDER CERTAIN SITUATIONS, IT MAY BE ADVANTAGEOUS TO USE ALTERNATE EROSION AND SEDIMENT CONTROL MEASURES BESIDES THOSE SHOWN ON THIS PLAN. CONTRACTOR SHALL USE ALL MEASURES IN CONFORMANCE WITH EL PASO COUNTY EROSION CONTROL REQUIREMENTS.
- PROJECT AREA FOR THE SOUTH INTERSECTION IS APPROXIMATELY 0.08 ACRES..
- ALL DISTURBED AREAS NOT STABILIZED WITH ASPHALT OR RIPRAP SHALL BE SEEDED PER EL PASO COUNTY CRITERIA. TOPSOIL, SEED AND SOIL RETENTION BLANKET SHALL BE PLACED WITHIN 4 CALENDAR DAYS OF EARTHWORK AND 2 CALENDAR DAYS OF FINAL GRADING. SEEDED AREAS SHALL BE PLANTED AND WATERED PER MANUFACTURER'S RECOMMENDATIONS AND/OR WATERED AS NEEDED TO GERMINATE AND SURVIVE.
- RECEIVING WATER FROM THIS SITE IS: MONUMENT CREEK.
- SILT FENCE SHALL BE INSTALLED PRIOR TO VEGETATION DISTURBANCE. SILT FENCE SHALL BE INSTALLED WITH J-HOOKS WHEN PARALLEL TO GRADE.
- ALL INTERIM BMPs SHALL REMAIN IN PLACE UNTIL FINAL STABILIZATION AND SHALL BE REMOVED WHEN FINAL STABILIZATION HAS BEEN ESTABLISHED AS DETERMINED BY THE ENGINEER. FINAL STABILIZATION IS DEFINED AS 80% GROWTH OF PRE-EXISTING VEGETATION IS EVIDENT IN ALL AREAS OF DISTURBANCE WITHOUT PAVEMENT.

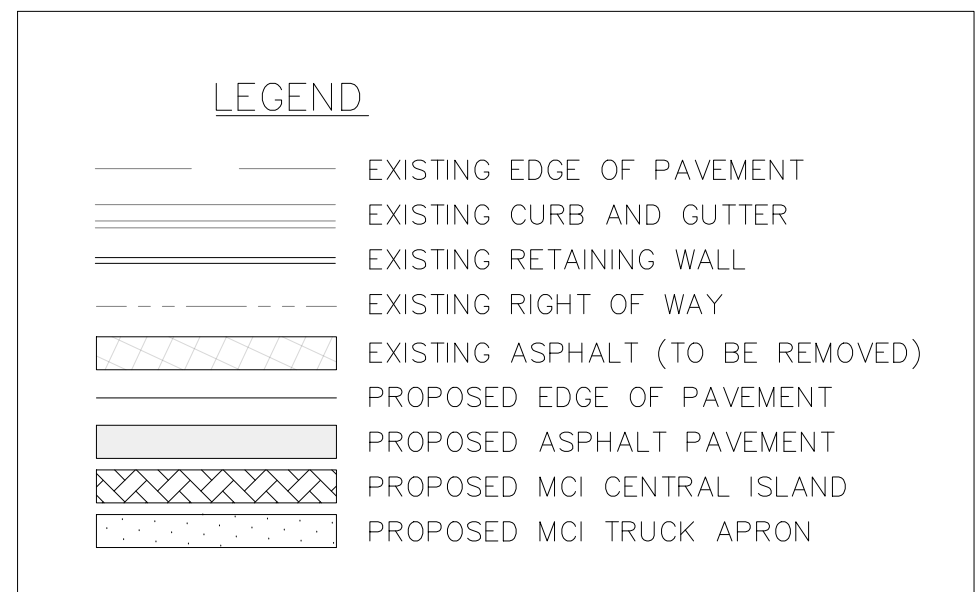

Print Date: 1/27/2026
 File Name: MCI 11218-EROSION CONTROL PLAN.DWG
 Horiz. Scale: 1" = 20' Vert. Scale:
 County Project Manager - Alissa Werre
Stantec
 410 17th Street
 SUITE 1400
 DENVER, COLORADO 80202-4427
 (303) 295-1717

Sheet Revisions		
Date:	Comments	Init.

DEPARTMENT OF PUBLIC WORKS
 3275 AKERS DRIVE
 COLORADO SPRINGS, CO 80922

As Constructed
 No Revisions:
 Revised:
 Void:

EROSION CONTROL/STORMWATER MANAGEMENT PLAN SOUTH	
Designer: MC	Structure Numbers
Detailer: WR	
Sheet Subset:	Subset Sheets: 1 OF 2

Project Number
181711218
 Sheet Number **7**

GRADING AND EROSION CONTROL NOTES

1. ALL CONTROL MEASURES SHALL BE INSTALLED PER EL PASO COUNTY CRITERIA.
2. CONTRACTOR SHALL NOT ENCROACH ON PRIVATE PROPERTY UNLESS CONSTRUCTION EASEMENTS HAVE BEEN OBTAINED.
3. STOCKPILE LOCATION(S) TO BE DETERMINED BY CONTRACTOR, IF NEEDED.
4. UNDER CERTAIN SITUATIONS, IT MAY BE ADVANTAGEOUS TO USE ALTERNATE EROSION AND SEDIMENT CONTROL MEASURES BESIDES THOSE SHOWN ON THIS PLAN. CONTRACTOR SHALL USE ALL MEASURES IN CONFORMANCE WITH EL PASO COUNTY EROSION CONTROL REQUIREMENTS.
5. PROJECT AREA FOR THE NORTH INTERSECTION IS APPROXIMATELY 0.06 ACRES.
6. ALL DISTURBED AREAS NOT STABILIZED WITH ASPHALT OR RIPRAP SHALL BE SEEDED PER EL PASO COUNTY CRITERIA. TOPSOIL, SEED AND SOIL RETENTION BLANKET SHALL BE PLACED WITHIN 4 CALENDAR DAYS OF EARTHWORK AND 2 CALENDAR DAYS OF FINAL GRADING. SEEDED AREAS SHALL BE PLANTED AND WATERED PER MANUFACTURER'S RECOMMENDATIONS AND/OR WATERED AS NEEDED TO GERMINATE AND SURVIVE.
7. RECEIVING WATER FROM THIS SITE IS: MONUMENT CREEK.
8. SILT FENCE SHALL BE INSTALLED PRIOR TO VEGETATION DISTURBANCE. SILT FENCE SHALL BE INSTALLED WITH J-HOOKS WHEN PARALLEL TO GRADE.
9. ALL INTERIM BMPS SHALL REMAIN IN PLACE UNTIL FINAL STABILIZATION AND SHALL BE REMOVED WHEN FINAL STABILIZATION HAS BEEN ESTABLISHED AS DETERMINED BY THE ENGINEER. FINAL STABILIZATION IS DEFINED AS 80% GROWTH OF PRE-EXISTING VEGETATION IS EVIDENT IN ALL AREAS OF DISTURBANCE WITHOUT PAVEMENT.

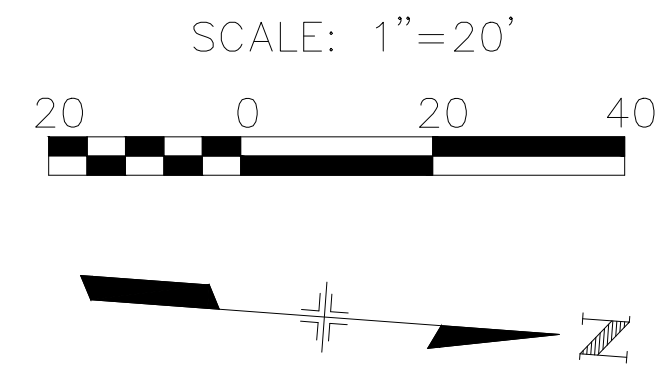

**FOR
INFORMATION
ONLY**

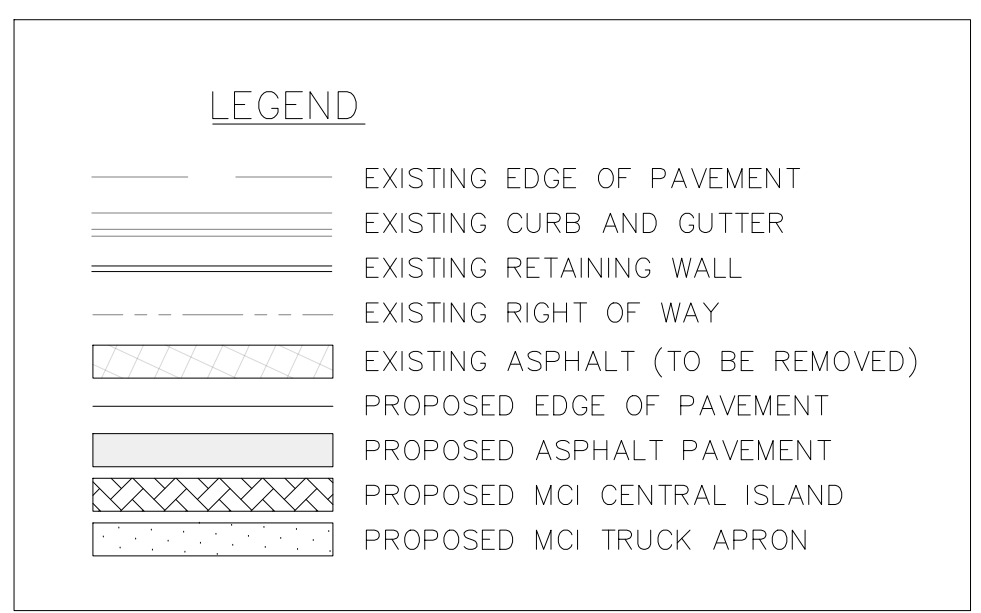
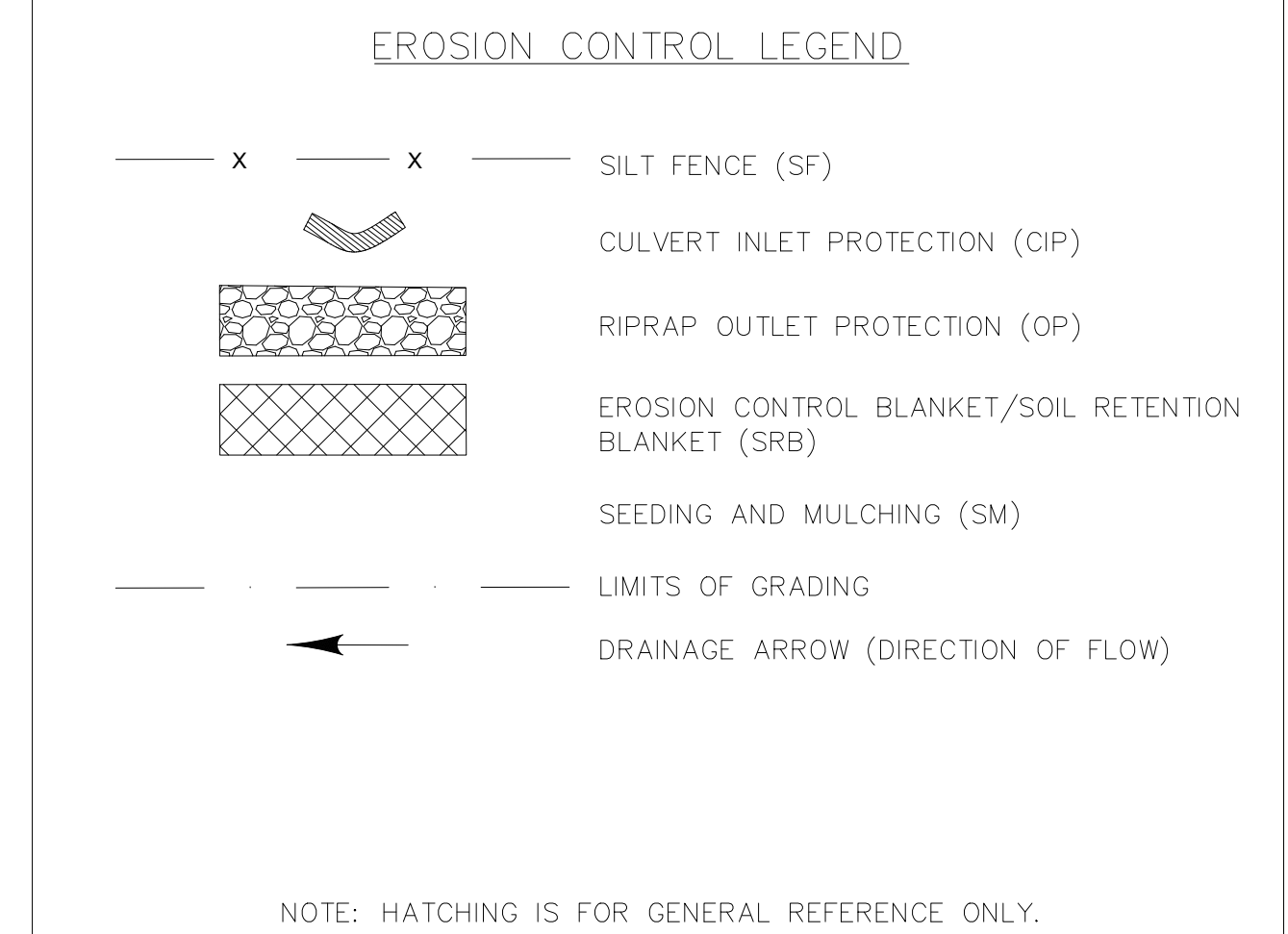
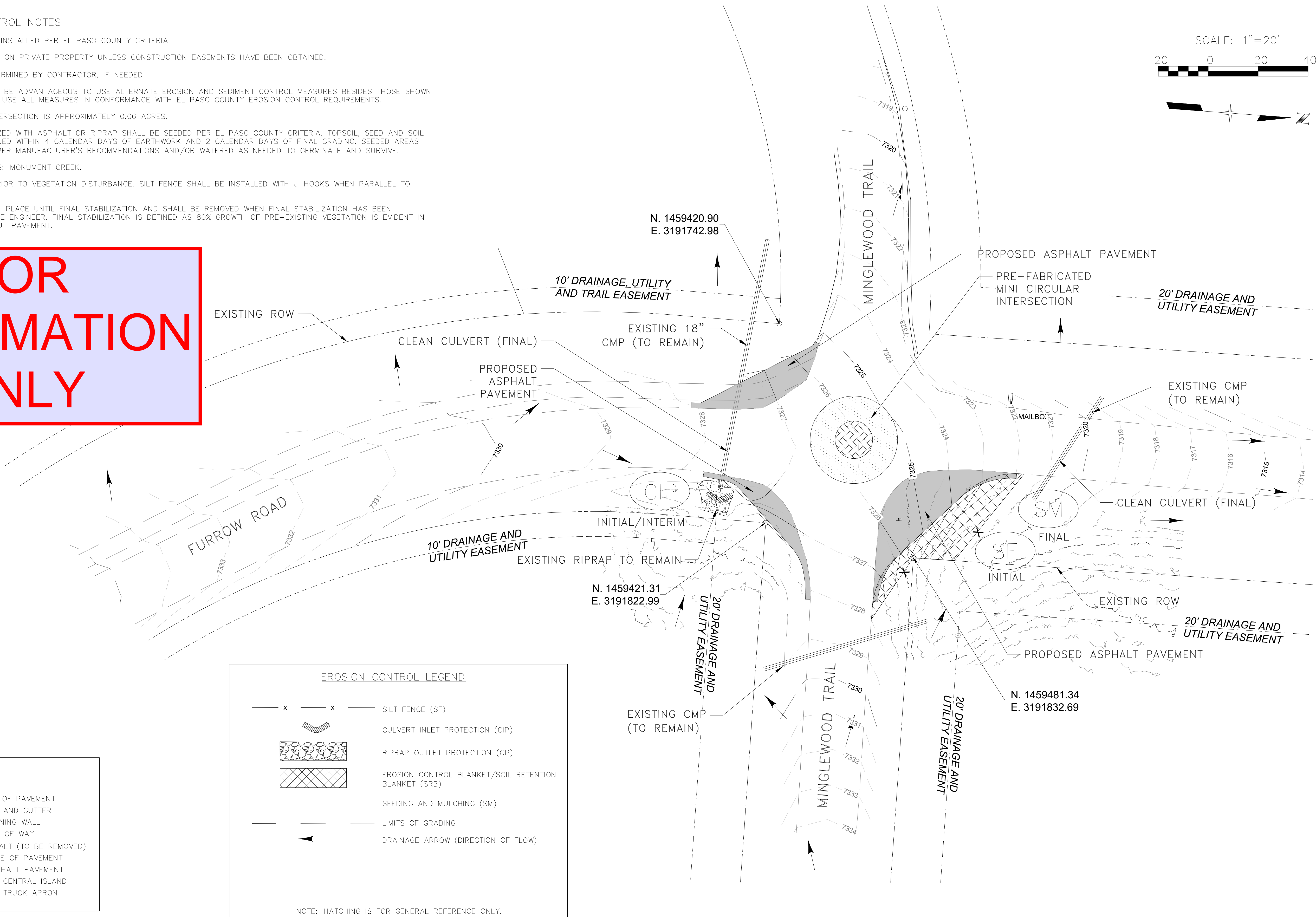

Print Date: 1/27/2026
 File Name: MCI 11218-EROSION CONTROL PLAN.DWG
 Horiz. Scale: 1" = 20' Vert. Scale:
 County Project Manager - Alissa Werre
 410 17th Street
 SUITE 1400
 DENVER, COLORADO 80202-4427
 (303) 295-1717

Sheet Revisions		
Date:	Comments	Init.



DEPARTMENT OF PUBLIC WORKS
 3275 AKERS DRIVE
 COLORADO SPRINGS, CO 80922

As Constructed
 No Revisions:
 Revised:
 Void:

EROSION CONTROL/STORMWATER MANAGEMENT PLAN NORTH

Designer:	NJ	Structure Numbers:	
Detailer:	NJ	Sheet Subset:	
Sheet Subset:		Subset Sheets:	2 OF 2

Project Number
181711218

Sheet Number **8**

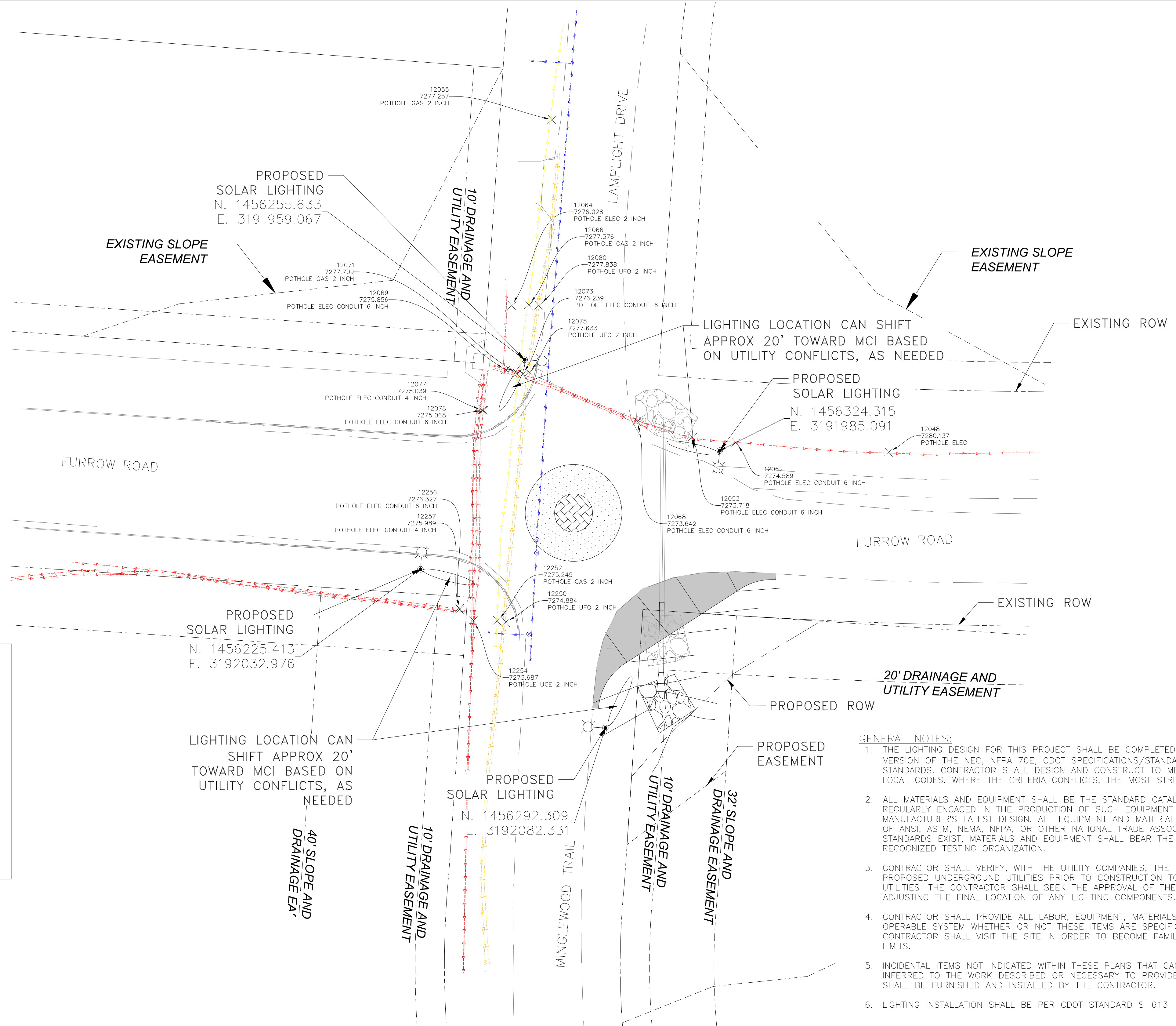
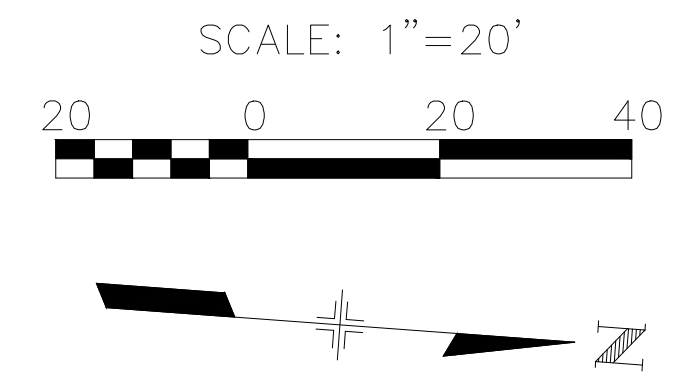

LEGEND

—	EDGE OF PAVEMENT
---	SANITARY LINE
---	WATER LINE
---	ELECTRIC LINE
---	GAS LINE
---	FIBER OPTIC LINE
---	TELEPHONE LINE
---	CURB AND GUTTER
⊕	FIRE HYDRANT
□	MAILBOX
+	SIGN
⊗	ELECTRIC BOX
---	PROPOSED EDGE OF PAVEMENT
---	EXISTING RIGHT OF WAY

- GENERAL NOTES:**
1. THE LIGHTING DESIGN FOR THIS PROJECT SHALL BE COMPLETED IN ACCORDANCE WITH THE LATEST VERSION OF THE NEC, NFPA 70E, CDOT SPECIFICATIONS/STANDARDS, EL PASO COUNTY CONSTRUCTION STANDARDS. CONTRACTOR SHALL DESIGN AND CONSTRUCT TO MEET APPLICABLE FEDERAL, STATE, AND LOCAL CODES. WHERE THE CRITERIA CONFLICTS, THE MOST STRINGENT REQUIREMENTS SHALL APPLY.
 2. ALL MATERIALS AND EQUIPMENT SHALL BE THE STANDARD CATALOGUED PRODUCTS OF MANUFACTURERS REGULARLY ENGAGED IN THE PRODUCTION OF SUCH EQUIPMENT AND MATERIAL AND SHALL BE THE MANUFACTURER'S LATEST DESIGN. ALL EQUIPMENT AND MATERIAL SHALL CONFORM TO THE REQUIREMENTS OF ANSI, ASTM, NEMA, NFPA, OR OTHER NATIONAL TRADE ASSOCIATION AS APPLICABLE. WHERE STANDARDS EXIST, MATERIALS AND EQUIPMENT SHALL BEAR THE LABEL AND BE LISTED BY UL OR OTHER RECOGNIZED TESTING ORGANIZATION.
 3. CONTRACTOR SHALL VERIFY, WITH THE UTILITY COMPANIES, THE EXACT LOCATION OF EXISTING AND PROPOSED UNDERGROUND UTILITIES PRIOR TO CONSTRUCTION TO AVOID CONFLICT OR DAMAGE TO THE UTILITIES. THE CONTRACTOR SHALL SEEK THE APPROVAL OF THE EL PASO COUNTY INSPECTORS PRIOR TO ADJUSTING THE FINAL LOCATION OF ANY LIGHTING COMPONENTS.
 4. CONTRACTOR SHALL PROVIDE ALL LABOR, EQUIPMENT, MATERIALS, ETC. TO ENSURE A COMPLETE AND OPERABLE SYSTEM WHETHER OR NOT THESE ITEMS ARE SPECIFICALLY SHOWN ON THE PLANS. CONTRACTOR SHALL VISIT THE SITE IN ORDER TO BECOME FAMILIAR WITH THE PROJECT SCOPE AND LIMITS.
 5. INCIDENTAL ITEMS NOT INDICATED WITHIN THESE PLANS THAT CAN BE LEGITIMATELY AND REASONABLY INFERRED TO THE WORK DESCRIBED OR NECESSARY TO PROVIDE A COMPLETE AND FUNCTIONING SYSTEM SHALL BE FURNISHED AND INSTALLED BY THE CONTRACTOR.
 6. LIGHTING INSTALLATION SHALL BE PER CDOT STANDARD S-613-1, AS APPLICABLE.

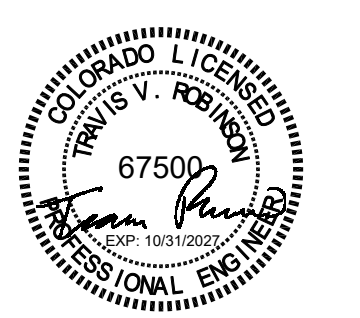

Print Date: 1/27/2026
 File Name: MCI 11218-LIGHTING PLAN.DWG
 Horiz. Scale: 1" = 20' Vert. Scale:
 County Project Manager - Alissa Werre
Stantec
 410 17th Street
 SUITE 1400
 DENVER, COLORADO 80202-4427
 (303) 295-1717

Sheet Revisions		
Date:	Comments	Init.



DEPARTMENT OF PUBLIC WORKS
 3275 AKERS DRIVE
 COLORADO SPRINGS,
 CO 80922

As Constructed
 No Revisions:
 Revised:
 Void:

LIGHTING PLAN (SOUTH)			
Designer:	VP/LR	Structure Numbers	
Detailer:	WR/NJ		
Sheet Subset:		Subset Sheets:	1 OF 3

Project Number
181711218
 Sheet Number **9**

LEGEND

- EDGE OF PAVEMENT
- - - SANITARY LINE
- - - WATER LINE
- - - ELECTRIC LINE
- - - GAS LINE
- - - FIBER OPTIC LINE
- - - TELEPHONE LINE
- - - CURB AND GUTTER
- FIRE HYDRANT
- MAILBOX
- ⊕ SIGN
- ⊗ ELECTRIC BOX
- - - PROPOSED EDGE OF PAVEMENT
- - - EXISTING RIGHT OF WAY

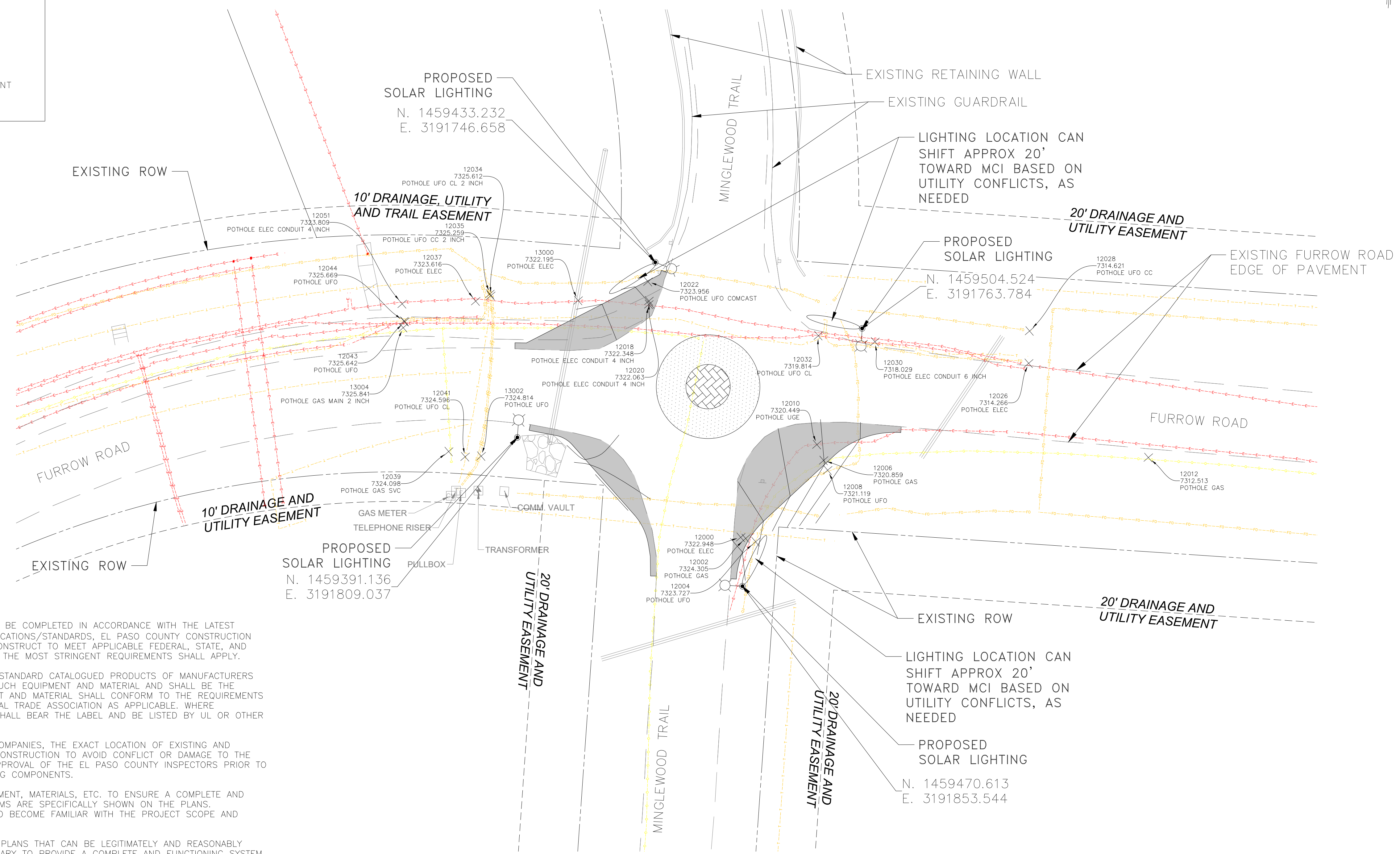
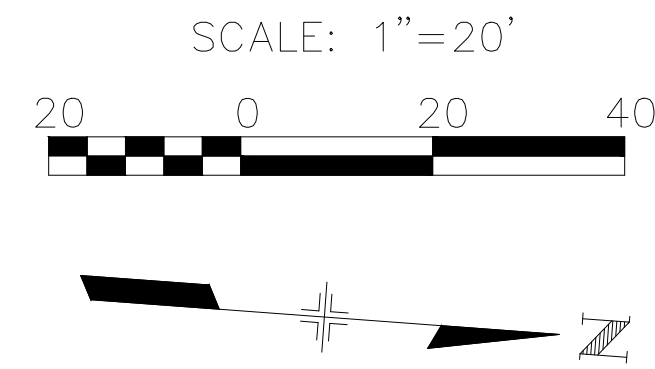

GENERAL NOTES:

1. THE LIGHTING DESIGN FOR THIS PROJECT SHALL BE COMPLETED IN ACCORDANCE WITH THE LATEST VERSION OF THE NEC, NFPA 70E, CDOT SPECIFICATIONS/STANDARDS, EL PASO COUNTY CONSTRUCTION STANDARDS. CONTRACTOR SHALL DESIGN AND CONSTRUCT TO MEET APPLICABLE FEDERAL, STATE, AND LOCAL CODES. WHERE THE CRITERIA CONFLICTS, THE MOST STRINGENT REQUIREMENTS SHALL APPLY.
2. ALL MATERIALS AND EQUIPMENT SHALL BE THE STANDARD CATALOGUED PRODUCTS OF MANUFACTURERS REGULARLY ENGAGED IN THE PRODUCTION OF SUCH EQUIPMENT AND MATERIAL AND SHALL BE THE MANUFACTURER'S LATEST DESIGN. ALL EQUIPMENT AND MATERIAL SHALL CONFORM TO THE REQUIREMENTS OF ANSI, ASTM, NEMA, NFPA, OR OTHER NATIONAL TRADE ASSOCIATION AS APPLICABLE. WHERE STANDARDS EXIST, MATERIALS AND EQUIPMENT SHALL BEAR THE LABEL AND BE LISTED BY UL OR OTHER RECOGNIZED TESTING ORGANIZATION.
3. CONTRACTOR SHALL VERIFY, WITH THE UTILITY COMPANIES, THE EXACT LOCATION OF EXISTING AND PROPOSED UNDERGROUND UTILITIES PRIOR TO CONSTRUCTION TO AVOID CONFLICT OR DAMAGE TO THE UTILITIES. THE CONTRACTOR SHALL SEEK THE APPROVAL OF THE EL PASO COUNTY INSPECTORS PRIOR TO ADJUSTING THE FINAL LOCATION OF ANY LIGHTING COMPONENTS.
4. CONTRACTOR SHALL PROVIDE ALL LABOR, EQUIPMENT, MATERIALS, ETC. TO ENSURE A COMPLETE AND OPERABLE SYSTEM WHETHER OR NOT THESE ITEMS ARE SPECIFICALLY SHOWN ON THE PLANS. CONTRACTOR SHALL VISIT THE SITE IN ORDER TO BECOME FAMILIAR WITH THE PROJECT SCOPE AND LIMITS.
5. INCIDENTAL ITEMS NOT INDICATED WITHIN THESE PLANS THAT CAN BE LEGITIMATELY AND REASONABLY INFERRED TO THE WORK DESCRIBED OR NECESSARY TO PROVIDE A COMPLETE AND FUNCTIONING SYSTEM SHALL BE FURNISHED AND INSTALLED BY THE CONTRACTOR.
6. LIGHTING INSTALLATION SHALL BE PER CDOT STANDARD S-613-1, AS APPLICABLE.



Print Date: 1/27/2026
 File Name: MCI 11218-LIGHTING PLAN.DWG
 Horiz. Scale: 1" = 20' Vert. Scale:
 County Project Manager - Alissa Werre
Stantec
 410 17th Street
 SUITE 1400
 DENVER, COLORADO 80202-4427
 (303) 295-1717

Sheet Revisions		
Date:	Comments	Init.



DEPARTMENT OF PUBLIC WORKS
 3275 AKERS DRIVE
 COLORADO SPRINGS,
 CO 80922

As Constructed
 No Revisions:
 Revised:
 Void:

LIGHTING PLAN (NORTH)			
Designer:	VP/LR	Structure Numbers	
Detailer:	NJ		
Sheet Subset:		Subset Sheets:	2 OF 3

Project Number
181711218
 Sheet Number **10**

LUMINAIRE SCHEDULE																
ITEM #	DESCRIPTION	MANUFACTURER	SERIES	LAMP				CONTROLS		INPUT		FORM				COMMENTS
				TYPE	LUMENS	CCT	CRI	TYPE	RANGE	WATTAGE	VOLTAGE	FINISH	DISTRIBUTION	BUG	MOUNTING	
	SOLAR INTEGRAL ARRAY, SINGLE HEAD ROADWAY COBRA HEAD, ANSI C136.15-2015 COMPLIANT, 20kV / 10kA SURGE	LUMEC	ROADFOCUS (RFM)	LED	6,104 LUMENS	2700k	70 MIN	PD50	--	SOLAR		TBD, PER EL PASO COUNTY	TYPE III SHORT W/HOUSE SIDE SHIELD	B1-U0-G1	27'-0"	MANUFACTURER TO PROVIDE BATTERY SIZED ACCORDINGLY TO OTHER SPECIFICATION REQUIREMENTS NOTED ON THIS SCHEDULE. SOLAR PANEL TO BE FIELD ALIGNED AND TILTED TO OPTIMIZE SUN ANGLE.

NOTE:
1) APPROVED EQUAL LUMINAIRE MANUFACTURER TO BE AN APPROVED CDOT ROADWAY ILLUMINATION ASSEMBLY SUPPLIER.

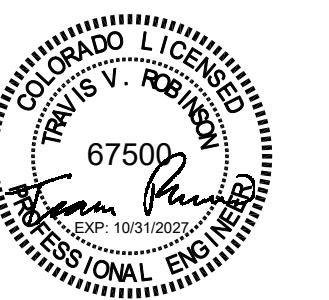

Print Date: 1/27/2026	Sheet Revisions			 DEPARTMENT OF PUBLIC WORKS 3275 AKERS DRIVE COLORADO SPRINGS, CO 80922	As Constructed	LIGHTING SCHEDULE			Project Number
File Name: MCI 11218-LIGHTING PLAN.DWG	Date:	Comments	Init.		No Revisions:				181711218
Horiz. Scale: Vert. Scale:					Revised:	Designer: VP/LR	Structure Numbers		
County Project Manager - Alissa Werre					Void:	Detailer: NJ			
 410 17th Street SUITE 1400 DENVER, COLORADO 80202-4427 (303) 295-1717						Sheet Subset:	Subset Sheets:	3 OF 3	Sheet Number 11