



# El Paso County RETIREMENT PLAN

"Financial Security for the Golden Years"

## Life@Work

## Wherever you go.

### Register for the Life@Work® app today

The Life@Work app has the same great features as the El Paso County Retirement Plan website and is now a tap away on your mobile device.

Note: You must be registered on the site before you can register on the app.

- Download the Life@Work app from the App Store or Google Play to access your retirement plan information, upload documents, and estimate your benefits.
- When registering, you'll be prompted to enter your Company Code: **ELP03**. Then, follow the remaining online instructions.

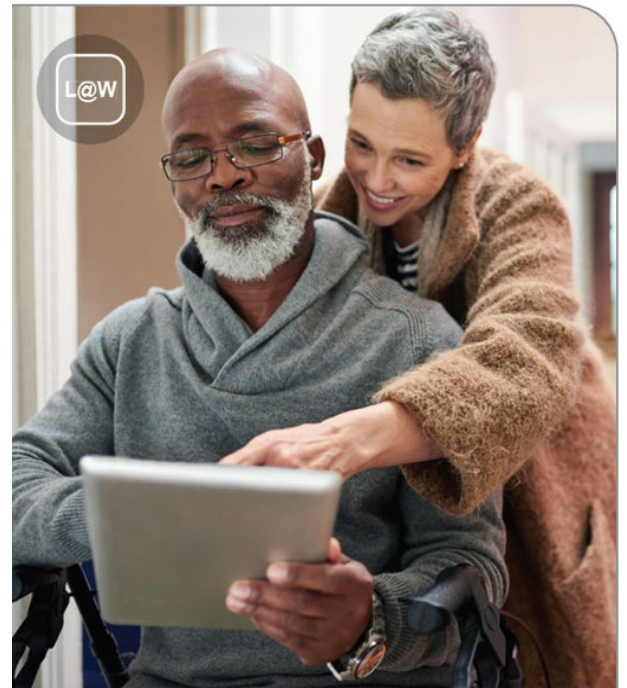

### What you need to do – in a nutshell:

It's easy to register, and easy to use



**Download** the **Life@Work** app from the App Store or Google Play.



**Register** using your county email address.

At the end of the registration process, take advantage of convenient features:

- **Set up Biometric Authentication** so you don't have to remember a PIN.
- **Select Push Notifications** to receive important benefits reminders.

# Steps you need to follow to set up The Life@Work App:

**Step 1:** Download and install the “Life@Work” application from AppStore or Google Play.

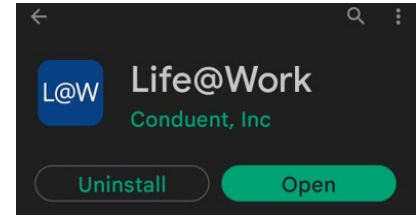

**Step 2:** Once downloaded, select **Begin Registration**.

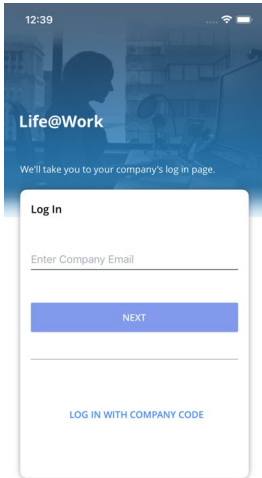

**Step 3:** Select **Log in with Company Code** or **Log in with Company Email**, and use the code: **ELP03**

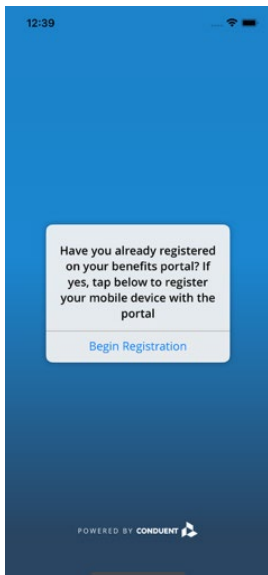

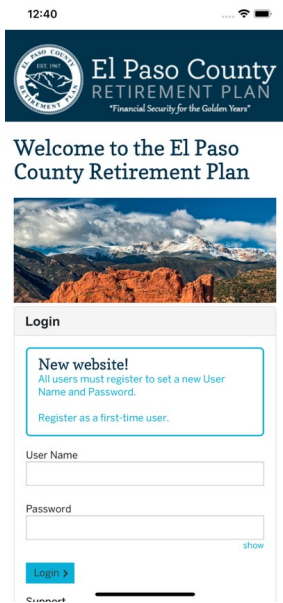

**Step 4:** Use your L@W username and password for authentication.

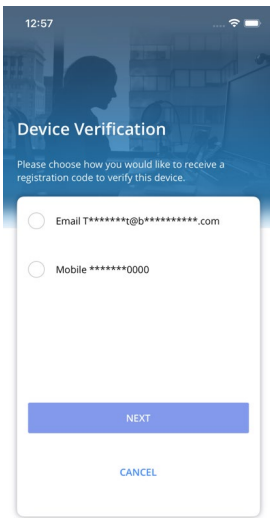

**Step 5:** Next, you will be prompted to verify your device. Select your preferred verification method, either email or mobile, and then click **Next**.

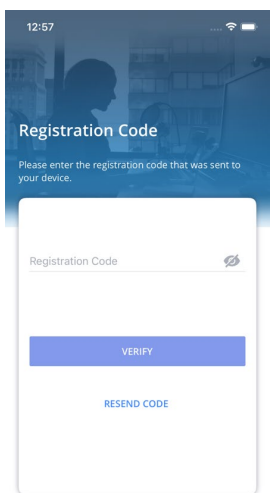

**Step 6:** Complete the verification process by entering the registration code sent to your selected email or mobile device.

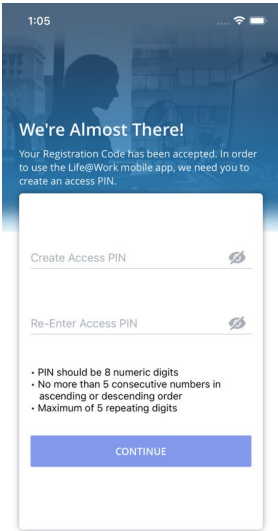

**Step 7:** Create an Access PIN. This PIN will be required for future logins.

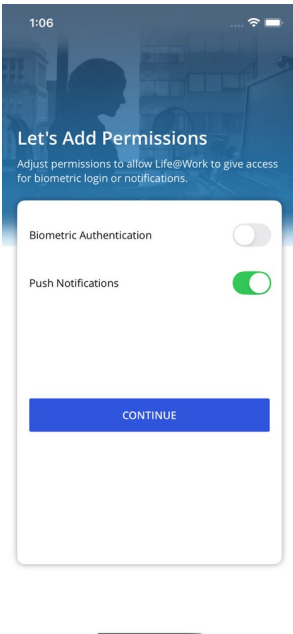

**Step 8:** Choose add-ons if desired. Select Biometric Authentication to enable biometric based login and click “Continue”.

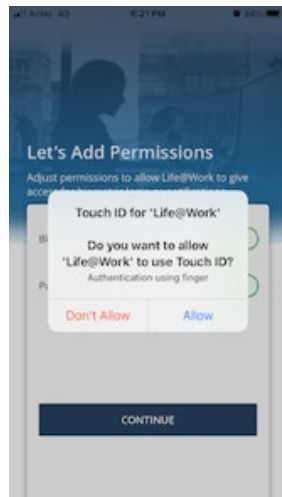

This will complete the Registration process. Step 1 – 8 are one time activity. From next time on words once you will open the application you will see Login screen (Step 9).

## Future Login Information

**Step 9:** Login to the app using biometrics (Touch ID / Face ID) or the PIN created in step 7 earlier.

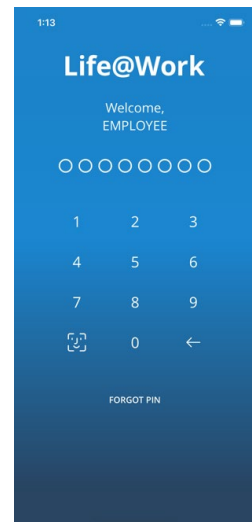

**Step 10:** For future logins, you may be asked for a device code. Select email or mobile, click NEXT, enter the device code, and click VERIFY.

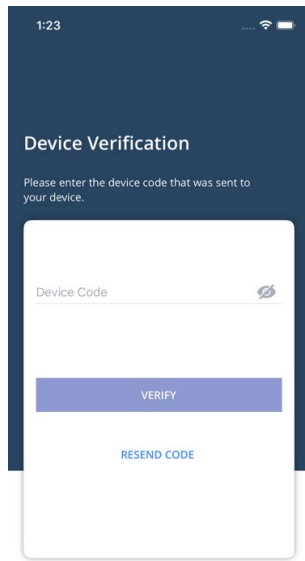
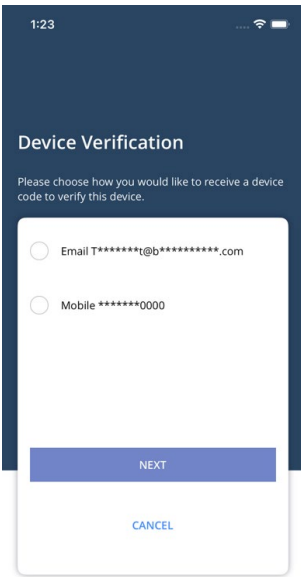

**Step 11:** You will then be on the home screen of the application.